

BERNINI

PANIC DEVICES



With EC mark, in compliance with
standard EN 1125:2008

Exclusive Pininfarina design

Complete application adaptability

Fast and easy installation

Functional safety and reliability

Also available in the version for
fire-resistant doors

NSAVIO
by
pininfarina

BERNINI LEVER PANIC HANDLE. NOW ALSO IN THE FIRE- RESISTANT VERSION.

Featuring an exclusive Pininfarina design, Bernini's range of panic handles expands its application solutions thanks to the new range of keepers, also sold separately. All versions are available in either a complete individual package or in separate packages that can be assembled.

Conforming to European Standard UNI EN 1125 and with EC marking obtained at the highest levels, Bernini sets new standards for panic handles, not only for the Pininfarina design and the overall ergonomics of the product. Bernini's panic handles feature extraordinary care for the finishing details, easy assembly, non-handed configuration, and the utmost application adaptability: horizontal/vertical, with 1/2/3 locking points, for doors in wood, iron, aluminium or PVC.



DESIGNED TO STAND THE TEST OF TIME. FUNCTIONAL LIKE THE FIRST DAY OF OPERATION.

High level of security against burglary attempts. Sturdy and efficient mechanisms. High quality materials and finishes. Tested up to 2,000,000 opening/closing cycles, a Bernini panic handle was designed to stand the test of time, maintaining the same functional characteristics as the day you first saw it in the workshop.

DESIGN IS BEAUTY AND FUNCTIONALITY. YOU CAN TAKE PININFARINA'S WORD FOR IT, AND SAVIO'S.

In the field of industrial design, the name Pininfarina certainly requires no introduction. The cooperation with Savio, which began even before Bernini, is a sharing of values under the sign of the purest design, in other words the union of beauty and functionality in one item.

BERNINI ENTERTAINS. AND NOT ONLY AT THE MOVIES.

Bernini's line turns a functional item into a veritable piece of furnishing, thanks to the perspective view of the coverplates, the overall balance of the shapes, and the total absence of any projections. The design firm also affected the finishing, for the technical characteristics of the coatings and the colour combinations between coverplate and bar. Bernini fits in perfectly in any environment, from multiplex theatres to airports, from fitness centres to hotels, wherever a solid contribution of safety and beauty is needed.





AVAILABLE IN 9 COVERPLATE-BAR COLOUR COMBINATIONS

Coverplate

Bar



White



Stainless steel



White



Red



White



Green

Coverplate

Bar



Grey



Stainless steel



Grey



Red



Grey



Green

Coverplate

Bar



Black



Stainless steel



Black



Red



Black



Green

OR COMPLETELY TONE-ON-TONE

2.000.000 cycles⁽¹⁾

(1) Does not refer to panic handles equipped with electrical strike art. 6000.820, which are validated at 200,000 cycles.

The products listed in the certificate guarantee a high number of opening/closing cycles (200,000 cycles), which allow frequent use.

This information, combined with other important elements that make it possible to evaluate the performance level of the product, is listed here below:

The various grades that can be obtained are:
(BERNINI's grades in bold)

3 7 7 0 1 4 2 2 A A

Category of use
Grade 3: High frequency of use by public

Durability:
Grade 6: 100,000 opening/closing cycles
Grade 7: **200,000 opening/closing cycles**

Max. door weight:
Grade 5: up to 100 kg
Grade 7: **over 200 kg**

Suited for application on fire-resistant doors:
Level 0: not suited
Level B: suited for fire-resistant doors

Security:
Grade 1: the panic bar is safe for users

Field of application of the door
Category A: door with one leaf, door with double leaf: **active of passive leaf**;
Category B: door with one leaf only;
Category C: door with double leaf, passive leaf only.

Type of bar operation:
Type A = **panic device with push-bar operation**
Type B = panic device with touch-bar operation

Height of bar compared to door surface:
Grade 1 = up to 150 mm
Grade 2 = **up to 100 mm**

Anti-breaking and entering security:
Grade 2: **guarantees a good level of security, which does not compromise operation of the panic device**

Corrosion resistance:
Grade 3: high resistance (96 hours in salt spray)
Grade 4: **very high resistance (240 hours in salt spray)**



Panic handles certification.

BERNINI was certified based on standard EN 1125:2008, in compliance with Italian Decree no. 92-647 dated 8th July 1992, as amended by Italian Decrees no. 95-1051 dated 20th September 1995 and no. 2003-947 dated 3rd October 2003 concerning the fitness for use of construction products and with article 14(1) (b) of Directive on construction products 89/106/EEC dated 21st December 1988, as amended by Directive 93/68/EEC dated 22nd July 1993, by the French certifying institute AFNOR, which is authorized at the European level to grant the use of the EC mark.

Its identification number is 0333. The tests were carried out at the prestigious CETIM institute, located in S. Etienne (France).

Please note that standard EN 1125: 2008 certifies products that can be applied to a shutter with maximum width of 1300 mm and maximum height of 2500 mm. For all doors with larger dimensions, the product cannot be certified (6000.B/1500, 6000.721). For these door typologies, out of the standard application fields, voluntary tests have been run at CETIM (notified French laboratory).

2.000.000 cycles⁽¹⁾

(1) Does not refer to panic handles equipped with electrical strike art. 6000.820, which are validated at 200,000 cycles.

The products listed in the certificate guarantee a high number of opening/closing cycles (200,000 cycles), which allow frequent use.

This information, combined with other important elements that make it possible to evaluate the performance level of the product, is listed here below:

The various grades that can be obtained are:
(BERNINI's grades in bold)

3 7 7 B 1 4 2 2 A A

Category of use
Grade 3: High frequency of use by public

Durability:
Grade 6: 100,000 opening/closing cycles
Grade 7: 200,000 opening/closing cycles

Max. door weight:
Grade 5: up to 100 kg
Grade 7: over 200 kg

Suited for application on fire-resistant/smoke-resistant doors:
Level 0: not suited
Level A: suited for smoke-resistant doors
Level B: suited for fire-resistant/smoke-resistant doors

Security:
Grade 1: the panic bar is safe for users

Field of application of the door

Category A: door with one leaf, door with double leaf: active or passive leaf;

Category B: door with one leaf only;

Category C: door with double leaf, passive leaf only.

Type of bar operation:

Type A = panic device with push-bar operation

Type B = panic device with touch-bar operation

Height of bar compared to door surface:

Grade 1 = up to 150 mm

Grade 2 = up to 100 mm

Anti-breaking and entering security:

Grade 2: guarantees a good level of security, which does not compromise operation of the panic device

Corrosion resistance:

Grade 3: high resistance (96 hours in salt spray)

Grade 4: very high resistance (240 hours in salt spray)



Panic handles certification FIRE-RESISTANT VERSION

BERNINI was certified based on standard EN 1125:2008, in compliance with Italian Decree no. 92-647 dated 8th July 1992, as amended by Italian Decrees no. 95-1051 dated 20th September 1995 and no. 2003-947 dated 3rd October 2003 concerning the fitness for use of construction products and with article 14(1) (b) of Directive on construction products 89/106/EEC dated 21st December 1988, as amended by Directive 93/68/EEC dated 22nd July 1993,

by the French certifying institute AFNOR, which is authorized at the European level to grant the use of the EC mark. Its identification number is 0333.

The tests were carried out at the prestigious CETIM institute, located in S. Etienne (France).

Please note that standard EN 1125: 2008 certifies products that can be applied to a shutter with maximum width of 1300 mm and maximum height of 2500 mm. For all doors with larger dimensions, the product cannot be certified (6000.B/1500, 6000.721). For these door typologies, out of the standard application fields, voluntary tests have been run at CETIM (notified French laboratory).

BERNINI panic bar

Exclusive PININFARINA design

The extreme care of the design entrusted to PININFARINA has resulted in a product capable of enhancing the architectural context.

Complete application adaptability

The complete range offers all kinds of application solutions, also thanks to the new range of keepers, which are sold separately as well.

Fire-resistant version

Fire-resistant version now available, either in complete individual packages or in separate packages that can be assembled.

Fast and easy installation

Installation has been made extremely simple thanks to the use of counter-plates that allow the panic handle to be installed on standard profiles too and, if needed, final assembly directly at the worksite. Moreover, the adjustable latches allow optimal positioning in case of interference with the squares used in the profiles.

Functional security and reliability

The high degree of security against burglary attempts from the outside, the efficient mechanism, and the high quality materials and finishes guarantee functional durability in time.

Operating modularity

The product comes in either individual complete packages or in separate packages that can be assembled, so that everyone is given the chance to choose the modularity they prefer.



* Range of keepers included in the complete kits for fire-resistant version

6000.1/1200 - 6001.1/1200

Vertical non-handed panic handle with 2 locking points.

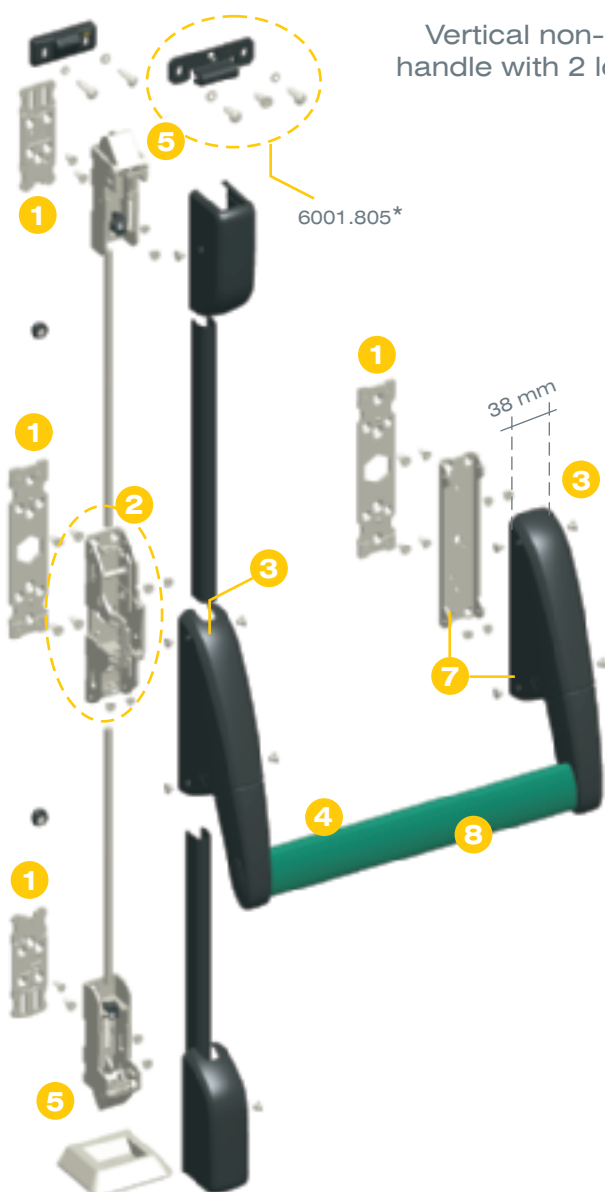

**FIRST YOU INSTALL IT,
THEN... YOU FORGET ABOUT IT**

**2,000,000 tested cycles:
10 times the requested regulatory
level!**

* Range of keepers included in the complete kits
for fire-resistant version

6000.3/1200 - 6001.3/1200

Vertical non-handed panic handle with lateral closing,
3 locking points

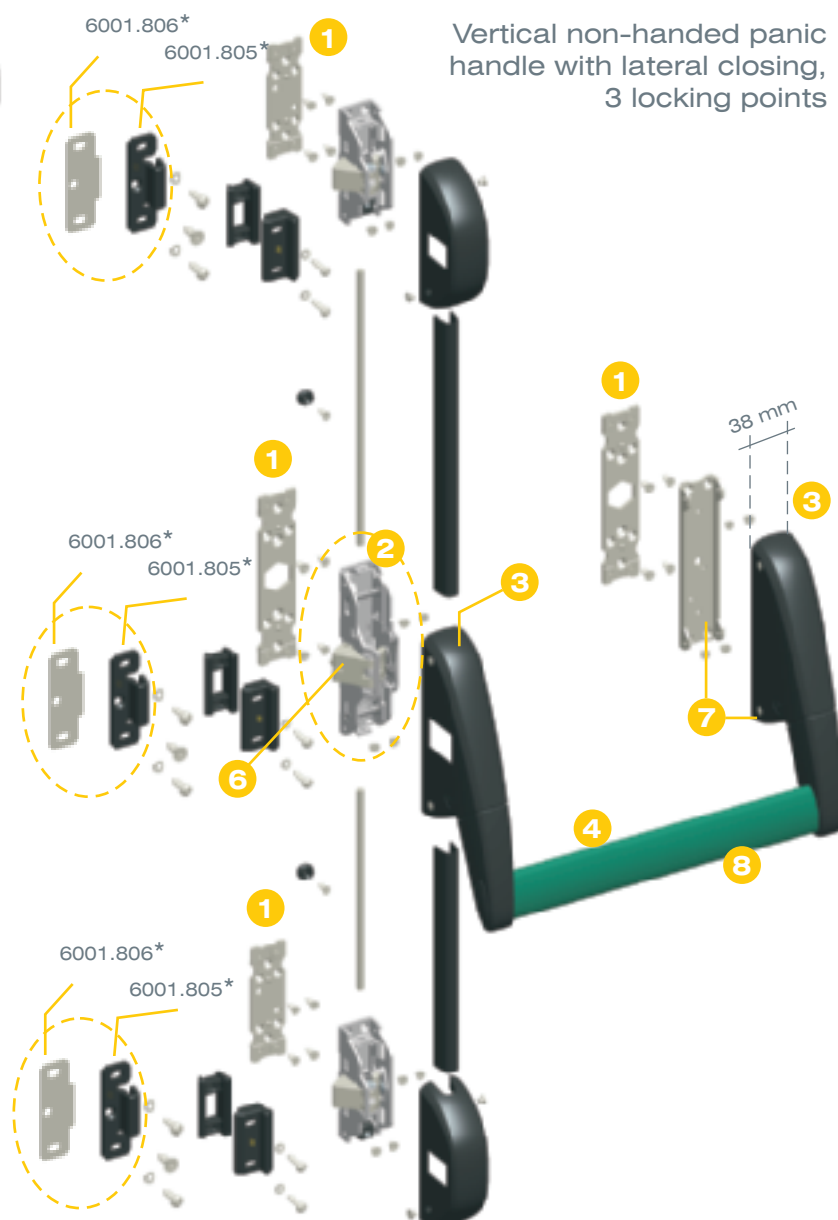

- 1** All supports and latches are screwed onto counterplates in steel (possibly welded) for easy, strong and fast fixing
- 2** Totally non-handed mechanism
- 3** Reduced footprint (38 mm) for assembly on standard profiles too
- 4** Horizontal bars with wide profile for better manoeuvrability
- 5** Adjustable top and bottom latches and with anti-burglar device
- 6** Central latch with anti-burglar device
- 7** Secondary support pre-set for the addition of the dogging mechanism and of the microswitch
- 8** Horizontal bar to be inserted with wide machining tolerances; in steel, with 40-mm oval section

Codes

Complete kits



Code	Description	Pcs.	Finishes
6000.1/1200	(patented) Horizontal non-handed panic bar with 1 locking point in zamak and galvanised steel. Complete with: latch bolt in nickel plated zamak, counterplates in galvanised steel, 1200 bar and 1 keeper in painted steel, 1 keeper cup in inylon, 8 countersunk head screws Ø 4.2x13 in black galvanised steel, 2 cap screws Ø 4.2x19 in black galvanised steel, 16 countersunk head screws M4x5 in black galvanised steel. For doors with a clear width of 800 to 1240 mm and a max. height of 2450 mm.	1	3001, 6029, GREY
6000.99/120	Like 6000.1/1200 but with supports and bar same finish.		1013, 9005, 9010, GREY, SILV
6001.1/1200	Like 6000.1/1200 but with latch bolt in stainless steel and for fire resistant doors.		3001, 6029, GREY

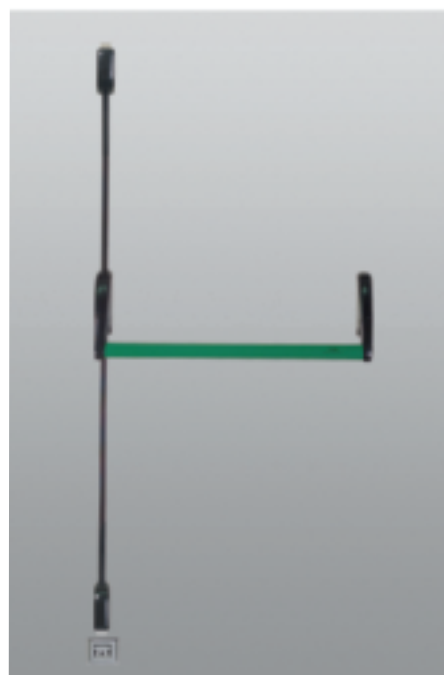

Code	Description	Pcs.	Finishes
6000.2/1200	(patented) Vertical rod non-handed panic bar with 2 locking points in zamak and galvanised steel. Complete with: counterplates in galvanised steel, 1200 bar and 1 keeper in painted steel, 1 floor-mounted keeper in stainless steel, 1 black nylon insert, 1 top rod + 1 bottom rod in aluminium, 1 rod cover in painted aluminium 1395 mm, 1 rod cover in painted aluminium 1037 mm, 2 adjustable plugs in black galvanised zamak, 6 countersunk head screws Ø 3.9x13, 8 countersunk head screws Ø 4.2x13, 2 cap screws Ø 4.2x19, 4 cap screws Ø 4.2x13 and 22 countersunk head screws M4x5 in black galvanised steel. For doors with a clear width of 800 to 1240 mm and a max. height of 2450 mm.	1	3001, 6029, GREY
6000.98/120	Like 6000.2/1200 but with supports and bar same finish.		1013, 9005, 9010, GREY, SILV
6001.2/1200	Like 6000.2/1200 but for fire resistant doors.		3001, 6029, GREY



Code	Description	Pcs.	Finishes
6000.3/1200	(patented) Vertical rod non-handed panic bar with 3 locking points in zamak and galvanised steel. Complete with: latch bolt in nickel plated zamak, counterplates in white galvanised steel, 1200 bar and 3 keepers in painted steel, 3 keeper cups in nylon, 1 top rod + 1 bottom rod in aluminium, 1 1395 mm rod cover in painted aluminium, 1 1037 mm rod cover in painted aluminium, 2 adjustable plugs in black galvanised zamak, 10 countersunk head screws Ø 3.9x13 in white galvanised steel, 8 countersunk head screws Ø 4.2x13 in black galvanised steel, 6 cap screws Ø 4.2x19 in black galvanised steel, 28 countersunk head screws Ø M4x5 in black galvanised steel. For doors with a clear width of 800 to 1240 mm and a max. height of 2450 mm.	1	3001, 6029, GREY
6000.97/120	Like 6000.3/1200 but with supports and bar same finish.		1013, 8019, 9005, 9010, GREY, SILV
6001.3/1200	Like 6000.3/1200 but with latch bolt in stainless steel and for fire resistant doors.		3001, 6029, GREY

Codes

Modular items



Code	Description	Pcs.	Finishes
6000.701	(patented) Kit with horizontal non-handed supports, one locking point in painted zamak and galvanised steel. Complete with: latch bolt in nickel plated zamak, counterplates in galvanised steel, 1 keeper in painted steel, 1 keeper cup in inylon, right and left nylon bar caps, 8 countersunk head screws Ø 4.2x13 in galvanised steel, 2 cap screws Ø 4.2x19 in galvanised steel, 16 countersunk head screws M4x5 in black galvanised steel (9010, GREY and SILV: 8 countersunk head screws M4x5 in galvanised steel + 8 countersunk head screws M4x6 in stainless steel).	1	9005, 9010, GREY, SILV



Code	Description	Pcs.	Finishes
6000.711	(patented) Kit with horizontal non-handed supports, 1 locking point for fire resistant doors, in painted zamak and galvanised steel. Complete with: latch bolt in stainless steel, counterplates in galvanised steel, right and left nylon bar caps, 8 countersunk head screws Ø 4.2x13 and 16 countersunk head screws M4x5 in black galvanised steel (9010, GREY and SILV: 8 countersunk head screws M4x5 in galvanised steel + 8 countersunk head screws M4x6 in stainless steel).	1	9005, 9010, GREY, SILV



Code	Description	Pcs.	Finishes
6000.702	(patented) Kit with non-handed vertical supports, two locking points in painted zamak and galvanised steel. Complete with: galvanised steel counterplates, right and left nylon bar caps, 8 countersunk head screws Ø 4.2x13 in galvanised steel, 16 countersunk head screws M4x5 in black galvanised steel (9010, GREY and SILV: 8 countersunk head screws M4x5 in galvanised steel + 8 countersunk head screws M4x6 in stainless steel).	1	9005, 9010, GREY, SILV
6000.712	Like 6000.702 but for fire resistant doors.		9005, 9010, GREY, SILV



Code	Description	Pcs.	Finishes
6000.703	(patented) Kit with non-handed supports, three locking points in painted zamak and galvanised steel. Complete with: latch bolt in nickel plated zamak, counterplates in galvanised steel, 1 keeper in painted steel, 1 keeper cup in inylon, right and left nylon bar caps, 8 countersunk head screws Ø 4.2x13 in galvanised steel, 2 cap screws Ø 4.2x19 in galvanised steel, 16 countersunk head screws M4x5 in black galvanised steel (9010, GREY and SILV: 8 countersunk head screws M4x5 in galvanised steel + 8 countersunk head screws M4x6 in stainless steel).	1	9005, 9010, GREY, SILV



Code	Description	Pcs.	Finishes
6000.713	(patented) Kit with horizontal non-handed supports, three locking points for fire resistant doors, in painted zamak and galvanised steel. Complete with: latch bolt in stainless steel, counterplates in galvanised steel, right and left nylon bar caps, 8 countersunk head screws Ø 4.2x13 and 16 countersunk head screws M4x5 in black galvanised steel (9010, GREY and SILV: 8 countersunk head screws M4x5 in galvanised steel + 8 countersunk head screws M4x6 in stainless steel).	1	9005, 9010, GREY, SILV

Codes

Modular items



Code	Description	Pcs.	Finishes
6000.B/860	Horizontal 860 mm bar in painted or stainless steel. For doors with leaf up to 900 mm.	1	3001, 6029, GREY, S
6000.B/1200	Like 6000.B/860 but of 1200 mm and for doors with leaf up to 1240 mm.		3001, 6029, 9005, 9010, GREY, S, SILV
6000.B/1500	Like 6000.B/860 but of 1500 mm and for doors with leaf up to 1540 mm.		3001, 6029, 9005, 9010, GREY, S, SILV



Code	Description	Pcs.	Finishes
6000.720	Standard vertical rods: 1 upper rod in aluminium + 1 lower rod in aluminium + 1 rod cover 1037 mm in painted aluminium + 1 rod cover 1395 mm in painted aluminium. For doors up to 2450 mm high.	1	9005, 9010, GREY, SILV



Code	Description	Pcs.	Finishes
6000.721	Vertical rods: 1 upper rod in aluminium + 1 lower rod in aluminium + 1 rod cover 1037 mm in painted aluminium + 1 rod cover 2045 mm in painted aluminium + 1 adjustable plug in galvanised zamak + 1 countersunk head screws Ø 3.9x13 in galvanised steel. For doors from 2450 mm to 3100 mm high.	1	9005, 9010, GREY, SILV



Code	Description	Pcs.	Finishes
6000.730	(patented) Kit with top / bottom latch bolts in painted zamak and galvanised steel, nickel plated latch bolt. Including: fastening counterplates in galvanised steel, 1 floor-mounted keeper in stainless steel + 1 black nylon insert, 2 adjustable plugs in galvanised zamak, 1 keeper in painted steel, 6 countersunk head screws Ø 3.9x13, 4 cap screws Ø 4.2x13, 2 cap screws Ø 4.2x19, 4 countersunk head screws M4x5 in black galvanised steel (1013, 9010, GREY, SILV: 4 countersunk head screws M4x5 in galvanised steel + 2 countersunk head screws M4x6 in stainless steel).	1	9005, 9010, GREY, SILV



Code	Description	Pcs.	Finishes
6000.731	(patented) Kit with top / bottom latch bolts for fire resistant doors in painted zamak and galvanised steel, stainless steel latch bolt. Including: fastening counterplates in galvanised steel, 1 floor-mounted keeper in stainless steel, 1 black nylon insert, 2 adjustable plugs in galvanised zamak, 6 countersunk head screws Ø 3.9x13, 4 cap screws M4x13, 6 countersunk head screws M4x5 in black galvanised steel (9010, GREY e SILV: 4 countersunk head screws M4x5 in galvanised steel + 2 countersunk head screws M4x6 in stainless steel).	1	9005, 9010, GREY, SILV

Codes

Complementary accessories and external access devices



Code	Description	Pcs.	Finishes
6000.735	(patented) Kit with top/side latch bolts in painted zamak and galvanised steel, nickel plated latch bolt. Including: fastening counterplates in galvanised steel, 2 adjustable plugs in galvanised zamak, 2 keepers in painted steel, 2 keeper cups in nylon, 8 countersunk head screws Ø 3.9x13, 2 cap screws Ø 4.2x13, 4 cap screws Ø 4.2x19, 9 countersunk head screws M4x5 in black galvanised steel (9010, GREY and SILV: 6 countersunk head screws M4x5 in galvanised steel + 3 countersunk head screws M4x6 in stainless steel).	1	9005, 9010, GREY, SILV



Code	Description	Pcs.	Finishes
6000.740	(patented) Kit with side latch bolts in painted zamak and galvanised steel, nickel plated latch bolt. Including: fastening counterplates in galvanised steel, 2 keepers in painted steel, 2 keeper cups in nylon, 2 adjustable through-guides in galvanised zamak, 10 countersunk head screws Ø 3.9x13, 4 cap screws Ø 4.2x19, 12 countersunk head screws M4x5 in black galvanised steel (1013, 9010, GREY, SILV: 8 countersunk head screws M4x5 in galvanised steel + 4 countersunk head screws M4x6 in stainless steel).	1	9005, 9010, GREY, SILV



Code	Description	Pcs.	Finishes
6000.741	(patented) Kit with side latch bolts for fire resistant doors in painted zamak and galvanised steel, stainless steel latch bolt. Including: fastening counterplates in galvanised steel, 2 adjustable through-guides in galvanised zamak, 10 countersunk head screws Ø 3.9x13 and 12 countersunk head screws M4x5 in black galvanised steel (9010, GREY and SILV: 8 countersunk head screws M4x5 in galvanised steel + 4 countersunk head screws M4x6 in stainless steel).	1	9005, 9010, GREY, SILV

PUSH PAD range (in accordance with EN 179:2008)



Code	Description	Pcs.	Finishes
6000.751	(pat.) Support for horizontal latching device, 1 push-pad in painted zamak and galvanized steel, nickel plated latch bolt. Complete with: 93 mm painted steel bar, 1 keeper + 3 spacers in painted zamak, RH/LH nylon bar caps, fastening counterplates, 4 countersunk head screws Ø 4.2x13, 2 cap screws Ø 4.2x19 and 8 countersunk head screws M4x5 in galvanised steel.	1	9005, 9010, GREY
6000.752	(pat.) Support for vertical latching device, push-pad in painted zamak and galvanised steel. Complete with: 93 mm painted steel bar, RH/LH nylon bar caps, fastening counterplate, 4 countersunk head screws Ø 4.2x13 and 8 countersunk head screws M4x5 in galvanised steel.	1	9005, 9010, GREY, SILV

External access devices



Code	Description	Pcs.	Finishes
6000.870	External access device, handle only, in painted zamak and galvanised steel, painted die-cast aluminium grip, square spindle in galvanised steel, 1 socket head cap screw M5x30 in white galvanised steel + 2 countersunk head screws M5x80 in black galvanised steel.	1	9005, 9010, GREY, SILV





Codes

External access devices

	External access devices			
	Code	Description	Pcs.	Finishes
	6000.873	External access device, idle handle, in painted zamak and galvanized steel, handle grip in zamak, shaped cylinder with different key combinations, 3 nickel plated keys, squared spindle in white galvanized steel, 2 countersunk head screw M5x80 in galvanized steel.	1	9005, 9010, GREY, SILV
	6000.874	Like 6000.873 but with single key combination.		9005, 9010, GREY, SILV
	6000.875	External access device, idle handle, in painted zamak and galvanized steel, painted die-cast aluminium grip, European profile cylinder with different key combinations + 3 nickel plated keys, square spindle in white galvanized steel, 1 socket head cap screw M5x30 in white galvanized steel + 2 countersunk head screws M5x80 in black galvanized steel. With "cylinder unlocked key retention device".	1	9005, 9010, GREY, SILV
	6000.877	Like 6000.875 but with single key combination.		9005, 9010, GREY, SILV
	6000.876	External access device, idle handle, in painted zamak and galvanized steel, painted die-cast aluminium grip, without cylinder, square spindle in galvanized steel, 1 socket head cap screw M5x30 in white galvanized steel + 2 countersunk head screws M5x80 in black galvanized steel. With "cylinder unlocked key retention device".	1	9005, 9010, GREY, SILV
	6000.879	External access device with reduced size handle, in painted zamak and galvanized steel, painted die-cast aluminium grip, European profile cylinder with different key combinations + 3 nickel plated keys, square spindle in white galvanized steel, 1 socket head cap screw M5x12 in white galvanized steel + 2 countersunk head screws M5x80 in black galvanized steel. With "cylinder unlocked key retention device".	1	9005
	6000.880	Outside access device in painted zamak and galvanized steel, fixed handle with knob, European profile cylinder with different key combinations + 3 nickel plated keys, square spindle in galvanized steel, 2 countersunk head screws M5x80 in black galvanized steel. Preferably for use with the 1 locking point version.	1	9005, 9010, GREY, SILV

Codes

Complementary accessories

	Code	Description	Pcs.	Finishes
	6000.802	Kit of keepers for horizontal or side latching device, for PVC (20 mm rabbet and more) and wood. Complete with: 1 keepers and 2 spacers in painted steel.	5	9005, 9010, GREY, SILV
	6000.803	Like 6000.802 but for rabbet less than 20 mm.		
	6000.804	Kit of keepers for vertical latching device, for PVC (20 mm rabbet and more) and wood. Complete with: 1 keepers and 2 spacers in painted steel.		
	6000.805	Like 6000.804 but for rabbet less than 20 mm.		
	Code	Description	Pcs.	Finishes
	6000.806	1.5 mm spacer in painted steel.	40	9005, 9010, GREY, SILV
	Code	Description	Pcs.	Finishes
	6000.807	Kit made of 1 upper keeper and 3 spacers (1, 2, 4 mm) in white powder coated zamak for vertical closing, 2 self-tapping screws TC Ø 4.2x16, 2 self-tapping screws TC Ø 4.2x22 and 2 washers in galvanized steel.	20	9005, 9010, GREY, SILV
	Code	Description	Pcs.	Finishes
	6000.808	Kit of keepers for vertical latching device, for PVC (20 mm rabbet and more) and wood.	50	9005, 9010
	Code	Description	Pcs.	Finishes
	6000.809	Kit made of 1 upper keeper and 3 spacers (1, 2, 4 mm) in white powder coated zamak for horizontal closing, 2 self-tapping screws TC Ø 4.2x16, 2 self-tapping screws TC Ø 4.2x22 and 2 washers in galvanized steel.	20	9005, 9010, GREY, SILV

Codes

Complementary accessories



Code	Description	Pcs.	Finishes
6000.810	Supplementary lateral locking device in painted zamak and galvanised steel, latch bolt in nickel plated zamak, counterplate in white galvanised steel, 1 keeper in painted steel, 1 keeper cup in inylon, 4 countersunk head screws Ø 3.9x13, 2 cap screws Ø 4.2x19 and 6 countersunk head screws M4x5 in black galvanised steel (9010, GREY and SILV: 4 countersunk head screws M4x5 in galvanised steel + 2 countersunk head screws M4x6 in stainless steel).	1	9005, 9010, GREY, SILV



Code	Description	Pcs.	Finishes
6000.820	Electric strike with cover in painted zamak, bottom plate in galvanised steel, 4 cap screws Ø 3.9x25 in white galvanised steel, black nylon spacers. Electrical feed: 12 V CA.	1	9005, 9010, GREY, SILV



Code	Description	Pcs.	Finishes
6000.830	Dogging mechanism in black nylon and zamak.	5	



Code	Description	Pcs.	Finishes
6000.840	Intermediate support in painted zamak, fastening counterplate in galvanised steel, 4 countersunk head screws Ø 4.2x13 in galvanised steel, 8 black galvanised countersunk head screws M4x5 (for finishes 9010: 4 galvanised countersunk head screws M4x5 + 4 stainless steel countersunk head screws M4x6).	1	9005, 9010, SILV



Code	Description	Pcs.	Finishes
6000.842	1 Microswitch + 1 black nylon support + 1 cap screw Ø 2.2x13 + 1 BZ cap screw Ø 3.9x9.5 in black galvanised steel.	5	

Codes

Complementary accessories

	Code 6000.843	Description Adjustable through-guides in galvanised zamak + 1 countersunk head screws Ø 3.9x13 in black galvanised steel.	Pcs. 5	Finishes
	Code 6000.890	Description BERNINI exit sign plate.	Pcs. 10	Finishes
	Code 6000.897	Description Fastening kit for external access device for profiles with section up to 100 mm, 1 squared spindle of 8 mm in white galvanized steel, 2 countersunk head screw M5x110 in white galvanized steel.	Pcs. 20	Finishes
	Code 6000.950	Description Aluminium drilling jig for main and secondary support for BERNINI panic device.	Pcs. 1	Finishes
	Code 6000.951	Description Aluminium drilling jig for op / bottom / side latch bolts for BERNINI and CELLINI panic device.	Pcs. 1	Finishes
	Code 6000.952	Description Aluminium drilling jig for external access devices art. 6000.875/.876/.877/.880.	Pcs. 1	Finishes

Codes

Complementary accessories



Code	Description	Pcs.	Finishes
6001.805	Kit made of 1 keeper in powder coated steel for horizontal and vertical closings, 1 self-tapping screws TS Ø 4.8x16, 2 self-tapping screws TC Ø 4.2x16 and 2 washers in galvanized steel.	20	9005, 9010, SILV, GREY



Code	Description	Pcs.	Finishes
6001.806	1 mm spacer in powder coated steel for keeper art. 6001.805.	40	



Code	Description	Pcs.	Finishes
6001.807	Kit made of 1 upper keeper in powder coated steel for vertical closing, 2 self-tapping screws TC Ø 4.2x19 and 2 washers in galvanized steel. For flush profiles and/or with height rebate of 8 mm.	20	9005, 9010, SILV, GREY

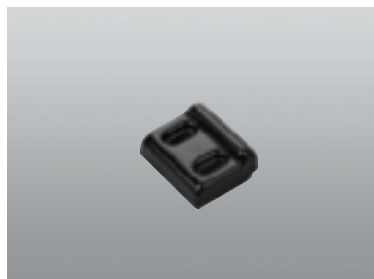

Code	Description	Pcs.	Finishes
6001.808	Kit made of 1 keeper in powder coated steel for horizontal closing, 2 self-tapping screws TC Ø 4.2x19 and 2 washers in galvanized steel. For flush profiles.	20	9005, 9010, GREY, SILV,



Code	Description	Pcs.	Finishes
6001.809	Kit made of 1 keeper in powder coated steel for horizontal closing, 2 self-tapping screws TC Ø 4.2x19 and 2 washers in galvanized steel, 1 keeper cup in nylon. For flush profiles and/or with height rebate of 8 mm.	20	9005, 9010, SILV, GREY

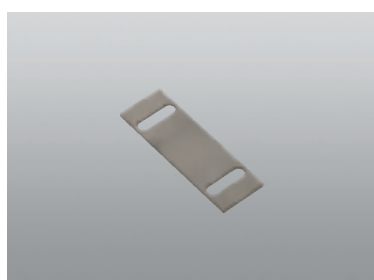

Code	Description	Pcs.	Finishes
6001.810	1 mm spacer in powder coated steel for keepers art. 6001.807-6001.809.	20	9005, 9010, SILV, GREY

6000.1/1200-6000.99/120-6001.1/1200

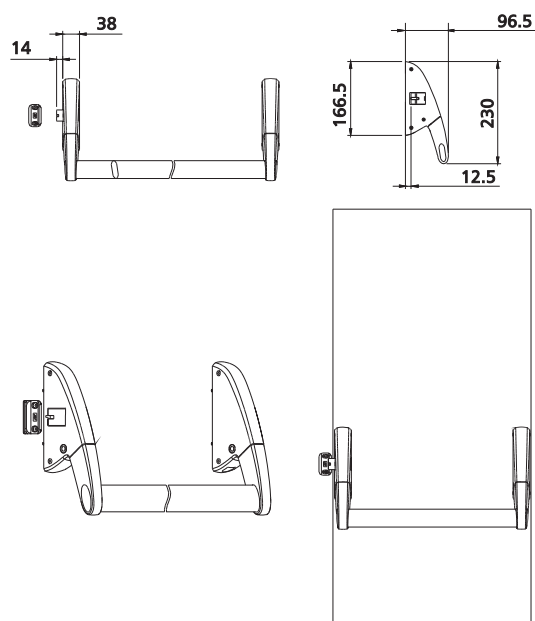

6000.2/1200-6000.98/120-6001.2/1200

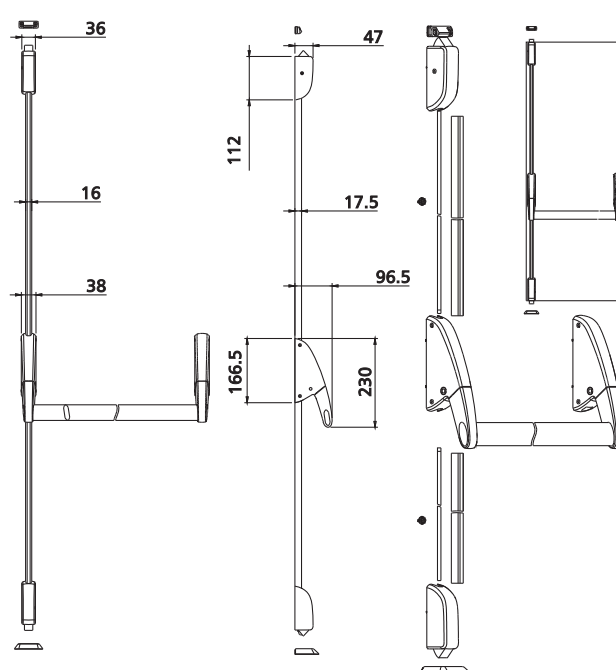

6000.3/1200-6000.97/120-6001.3/1200

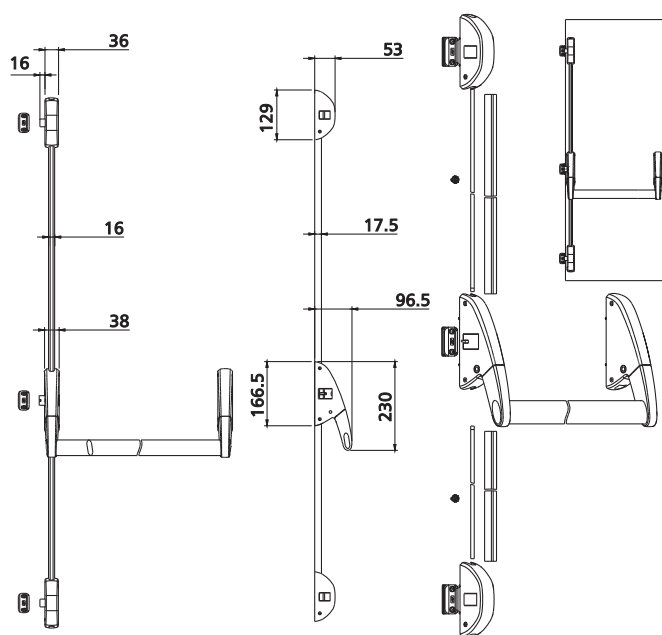

6000.701-6000.711*

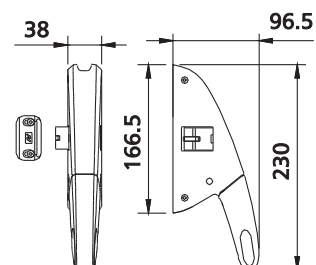

6000.702-6000.712

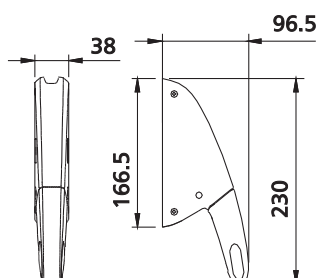

6000.703-6000.713*

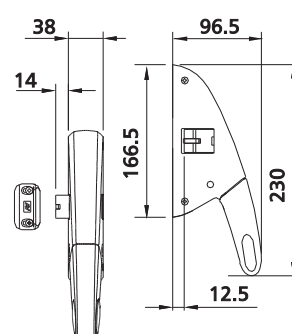

* = 6000.711/.713/.731/.741 Keepers supplied separately

Modular items

6000.730-6000.731*

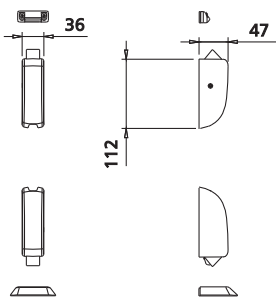

6000.735

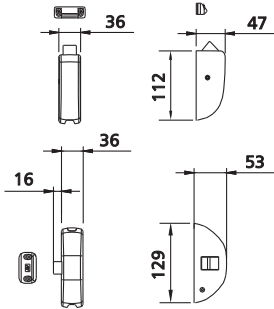

6000.740-6000.741*

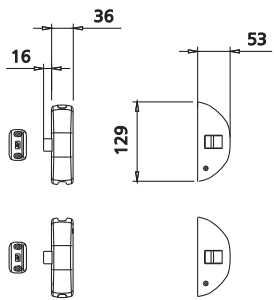

6000.751

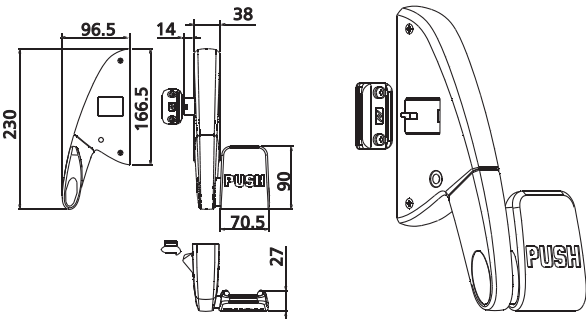

6000.752

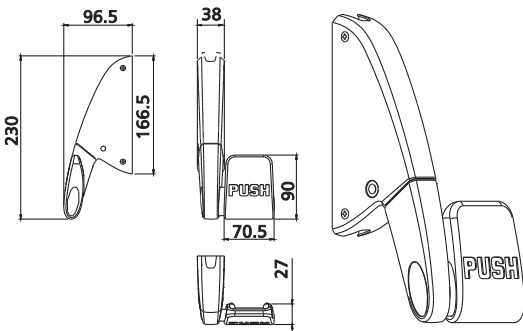

6000.802/.803/.804/.805/.806

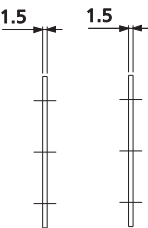
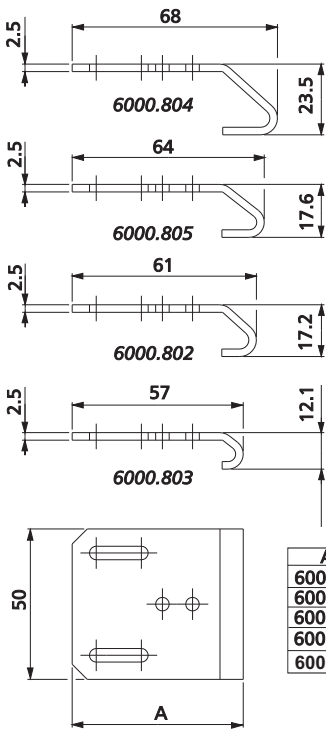

6000.807

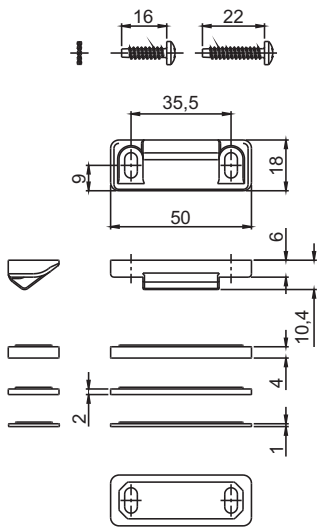

* = 6000.711/.713/.731/.741 keepers supplied separately

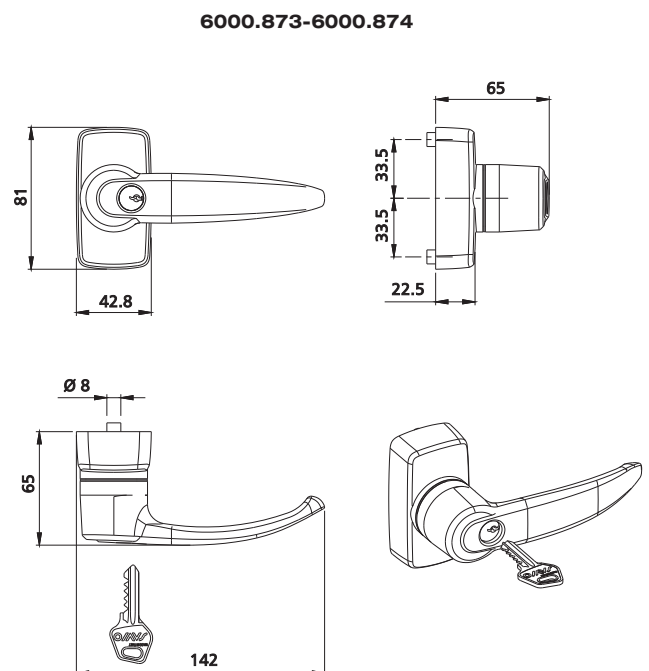
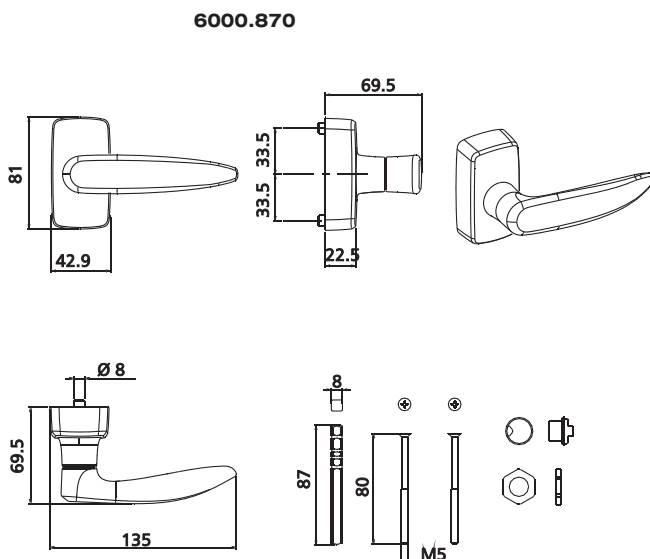
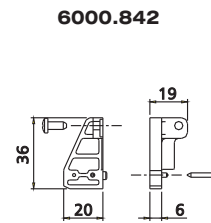
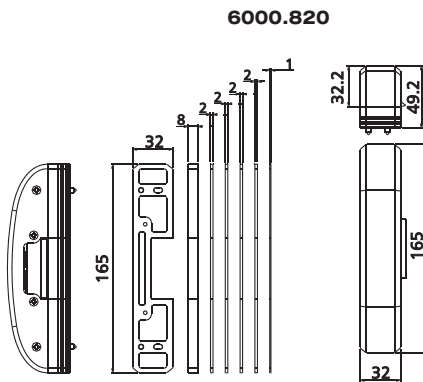
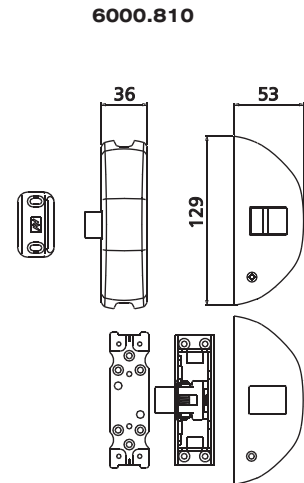
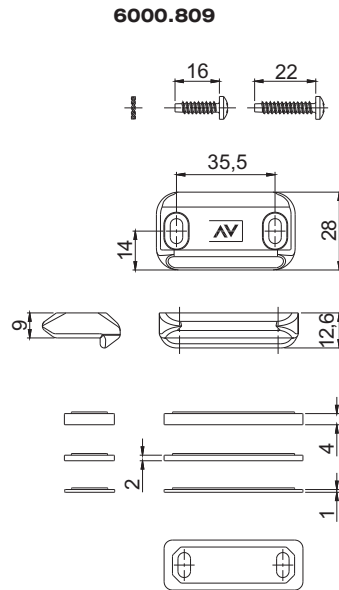
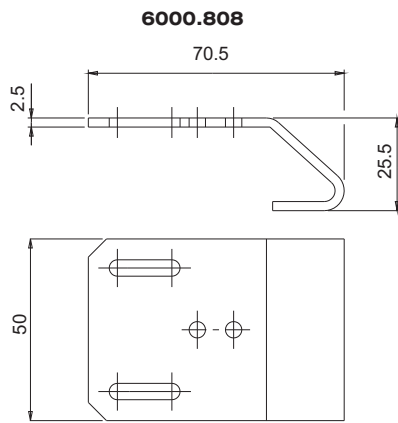

Complementary accessories

6000.875-6000.876-6000.877

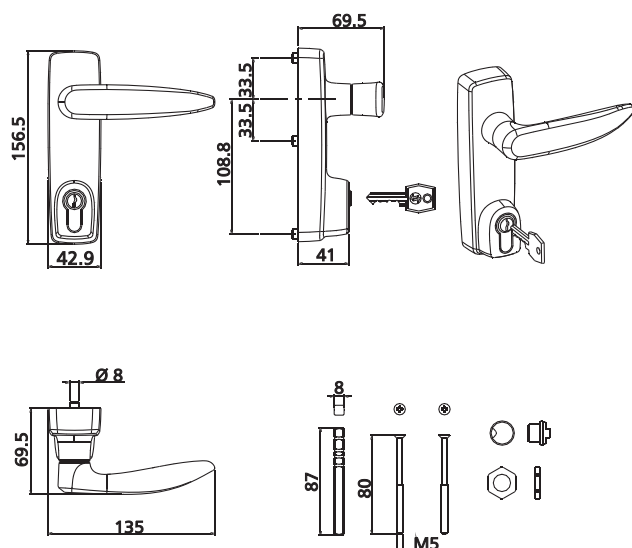

6000.879

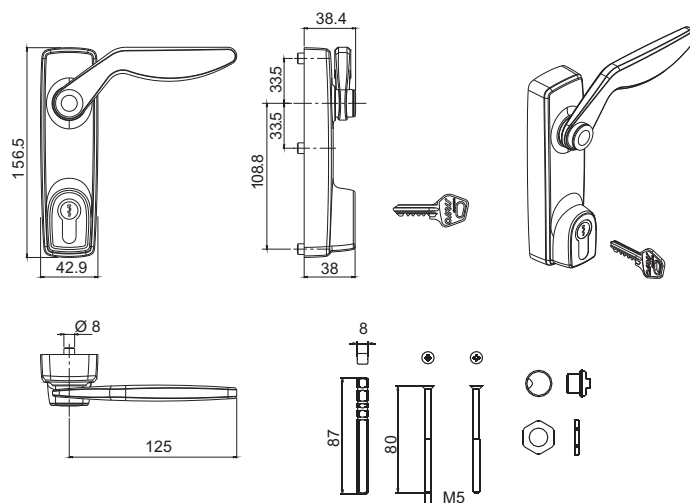

6000.880

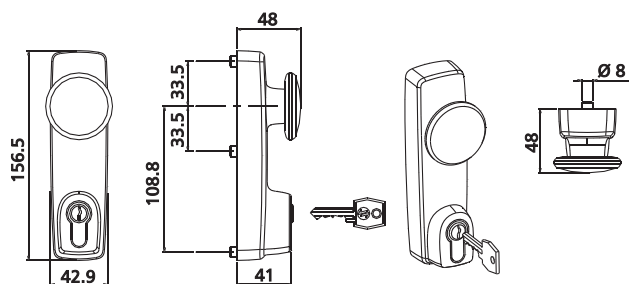

6000.897

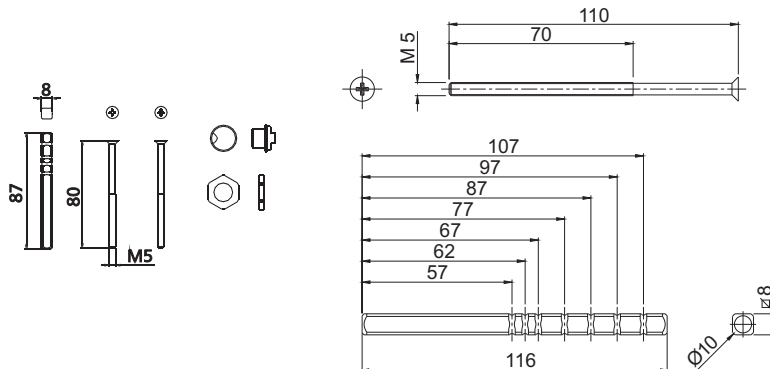

6000.3/1200 - 6000.97/120 - 6001.3/1200 - 6000.735/740/741

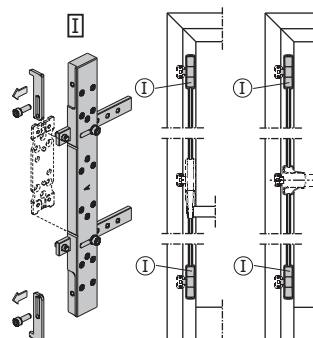

6000.951

6000.2/1200 - 6000.98/120 - 6001.2/1200 - 6000.730/731/735

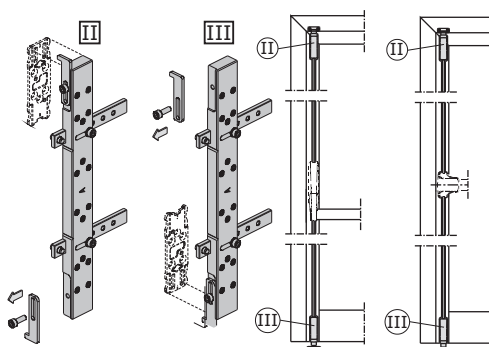

6000.1/6000.99/6001.1 - 6000.701/711
6000.2/6000.98/6001.2 - 6000.702/712
6000.3/6000.97/6001.3 - 6000.703/713

Complementary accessories

6000.952

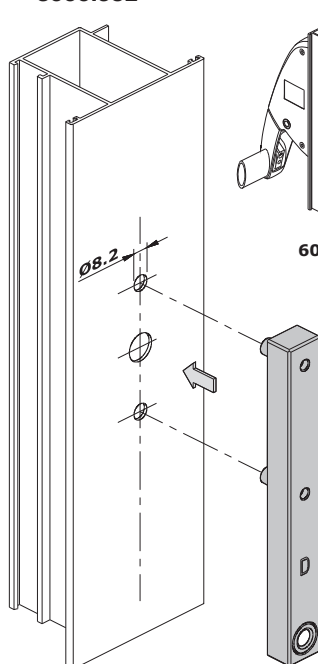

6000.880

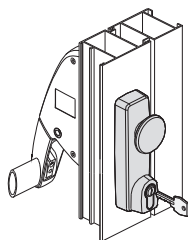

6000.875

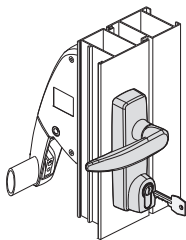

6000.876

6000.877

6000.879

6001.805

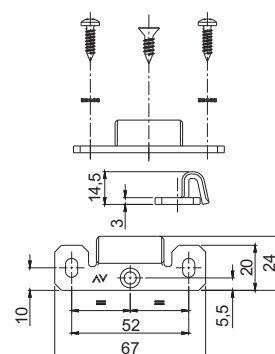

6001.806

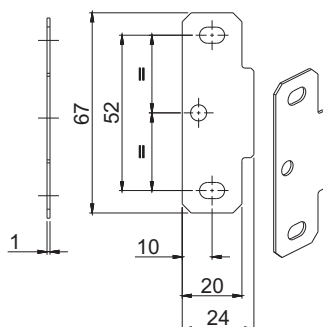

6001.807

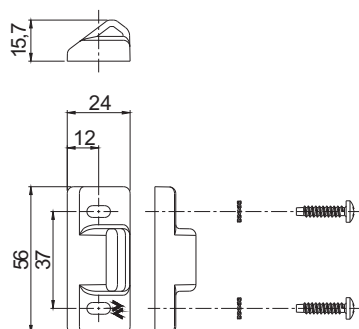

6001.808

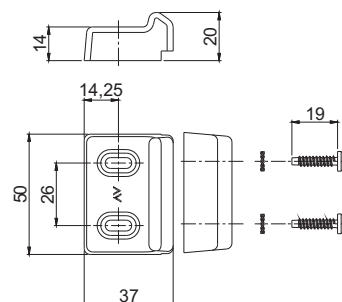

6001.809

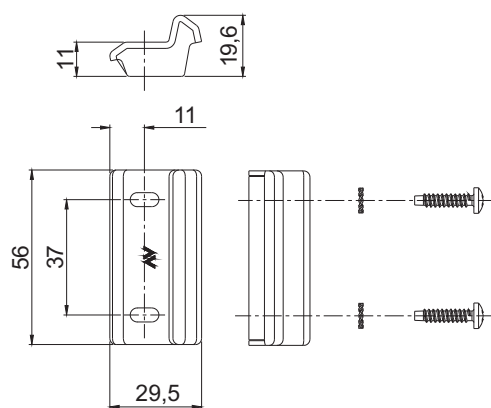

6001.810

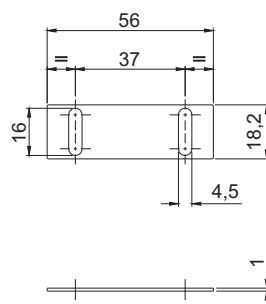

Certified application schemes for single door

Legend:

BERNINI alternative configurations

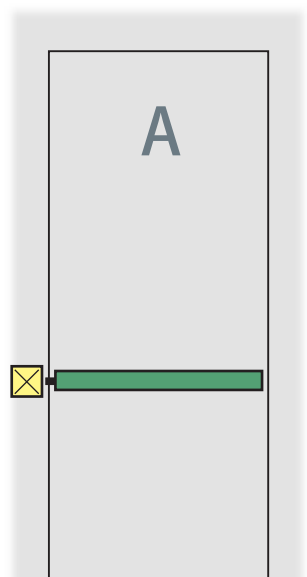

Application A:

BERNINI
6000.1-6001.1 /1200
6000.99/120

6000.701/.711*+
6000.B

6000.703/.713*+
6000.B

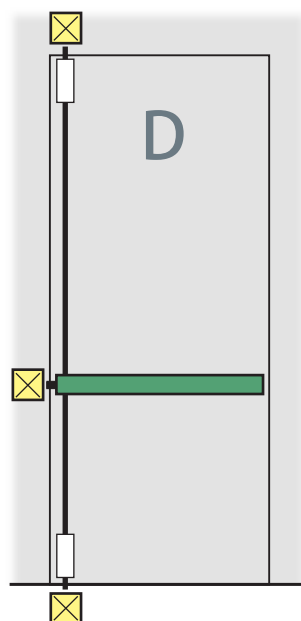

Application D:

BERNINI

6000.703/.713*+
6000.B +
6000.720/.721 +
6000.730/.731*

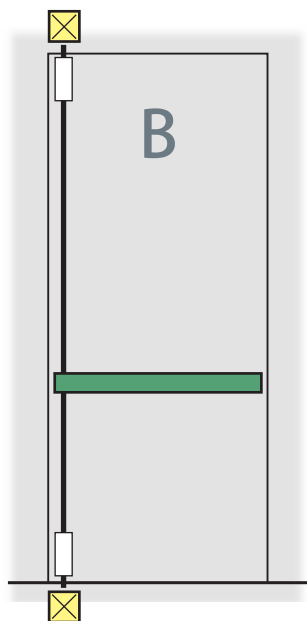

Application B:

BERNINI
6000.2-6001.2 /1200
6000.98/120

6000.702/.712 +
6000.B +
6000.720/.721 +
6000.730/.731*

6000.703/.713*+
6000.B +
6000.720/.721 +
6000.730/.731*

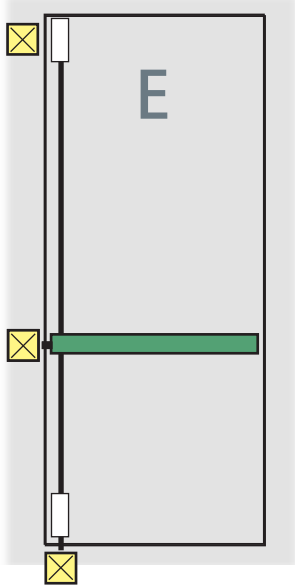

Application E:

BERNINI

6000.703/.713*+
6000.B +
6000.720/.721 +
6000.730/.731* +
6000.740/.741*

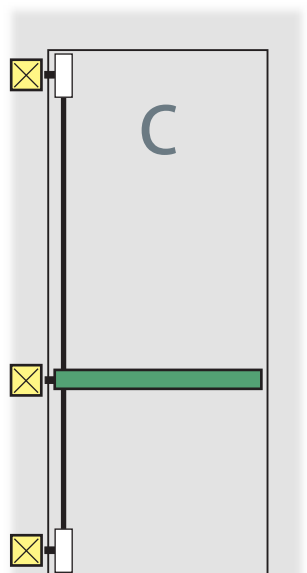

Application C:

BERNINI
6000.3-6001.3 /1200
6000.97/120

6000.703/.713*+
6000.B +
6000.720/.721 +
6000.740/.741*

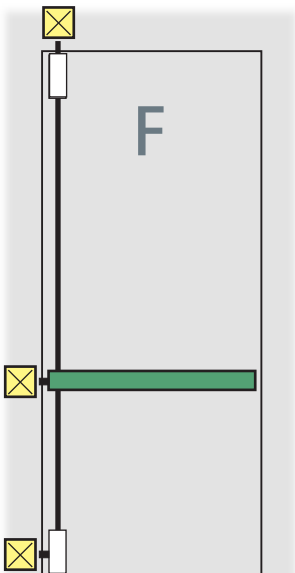

Application F:

BERNINI

6000.703/.713*+
6000.B +
6000.720/.721 +
6000.735

* = 6000.711/.713/.731/.741 Keepers supplied separately

Certified application schemes for double door

Legend:

BERNINI alternative configurations

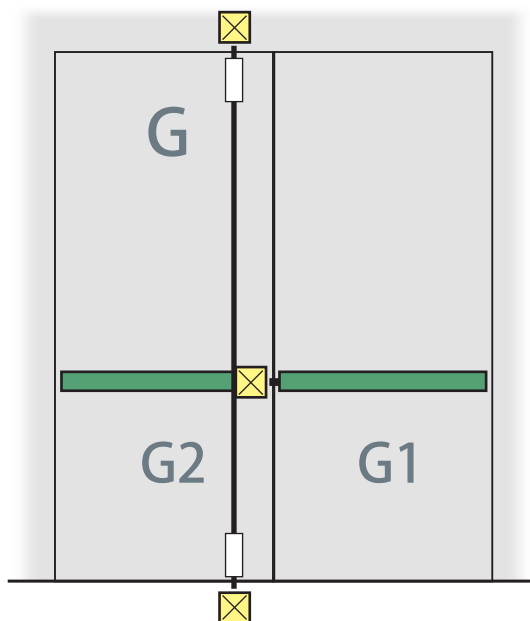

Application G:

G1 BERNINI

6000.1/1200-6000.99/120-6001.1 /1200

6000.701/.711*+6000.B

6000.703/.713*+6000.B

G2 BERNINI

6000.2/1200-6000.98/120-6001.2 /1200

6000.702/.712+6000.B+6000.720/.721+6000.730/.731*

6000.703/.713*+6000.B+6000.720/.721+6000.730/.731*

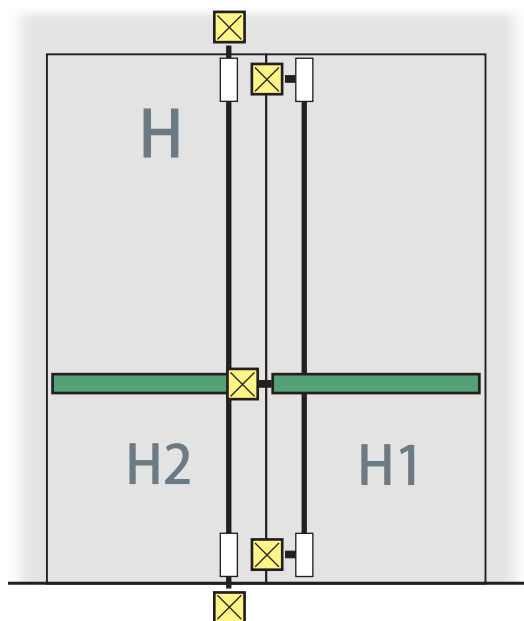

Application H:

H1 BERNINI

6000.3/1200-6000.97/120-6001.3 /1200

6000.703/.713*+6000.B+6000.720/.721+6000.740/.741*

H2 BERNINI

6000.2/1200-6000.98/120-6001.2 /1200

6000.702/.712+6000.B+6000.720/.721+6000.730/.731*

6000.703/.713*+6000.B+6000.720/.721+6000.730/.731*

* = 6000.711/.713/.731/.741 Keepers supplied separately

SAVIO
by
pininfarina

Savio S.p.A.

Via Torino, 25 (s.s. 25) - 10050 Chiusa S. Michele (TO)

tel. +39 011 964 3464 - fax +39 011 964 3474

www.savio.it - savio@savio.it