

AV SAVIO



MODULODUE

Locking systems for sliding windows and doors
ROUNDED DESIGN
WIDE RANGE FOR ALL SLIDING PROFILE SOLUTIONS
SAFE AGAINST BURGLAR ATTEMPT

Programme de fermetures pour fenêtres et portes-fenêtres coulissantes
FORMES ARRONDIES
SOLUTIONS ADAPTEES A TOUS LES PROFILS DE COULISSANT
EFFICACES CONTRE LES TENTATIVES D'EFFRACTION

Programa de cierre para correderas
FORMAS REDONDEADAS
GAMA COMPLETA PARA TODOS LOS PERFILES DE LA CORREDERA
SEGURAS CONTRA LAS TENTATIVAS DE ABERTURA DESDE EL EXTERIOR

12/97

SAVIO Quality Management System is certified ISO 9001





2070.1
2071.1

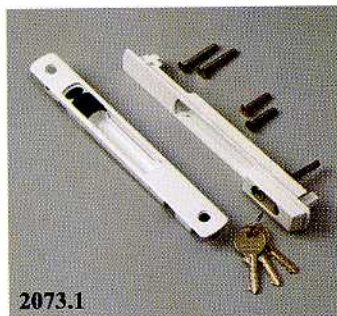

2073.1

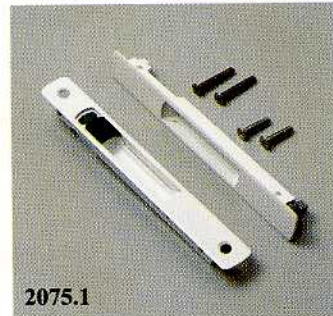

2075.1



2076.1

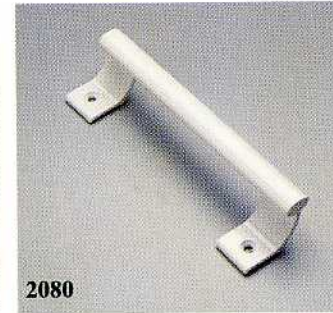

2080



2070.802
2070.801



2070.803



2070.820



2080.1

ART.	PZ.	FINISH - FINIT. - ACAB.	DESCRIPTION - DESCRIPCIÓN
2070.1	20	F, ZE, NE, 9010	2070.1 MODULODUE (patented) manual lateral locking mechanism, in aluminium and zamak, 2 preassembled screws TS M5x16 in stainless steel 304. - 2071.1 MODULODUE (patented) same as 2070.1 but automatic.
2070.801	40		2073.1 MODULODUE (patented) manual double lateral locking mechanism with safety cylinder (different keys) in aluminium and zamak, 2 screws TS M5x25 and 2 screws TS M5x35 in stainless steel 304. - 2075.1 MODULODUE (patented) same as 2073.1 but without safety cylinder. - 2076.1 MODULODUE (patented) double cup handle (for 4 leaves) in aluminium and zamak, 2 screws TS M5x25 and 2 screws TS M5x35 in stainless steel 304.
2070.802	40		2080 MODULO aluminium pull handle. - 2080.1 same as 2080 but for external.
2070.803	40		2070.801/.802 (patented) locking kit for MODULO and MODULODUE in stainless steel 430 and black galvanized zamak, 2 screws TC Ø 3,9x13 in stainless steel 304. - 2070.803 (patented) same as 2070.801/.802 but with 2 screws TS Ø 3,9x9,5 in stainless steel 304. - 2070.820 (patented) locking kit for MODULO and MODULODUE in stainless steel 430, 2 screws TC Ø 3,9x13 and 2 screws TC Ø 3,9x19 in stainless steel 304.
2070.820	40		
2071.1	20	F, ZE, NE, 9010	2070.1 MODULODUE (breveté) fermeture simple latérale à système manuel ambidextre en aluminium et zamack, 2 vis TS M5x16 en acier inox 304, pré-assemblées. - 2071.1 MODULODUE (breveté) comme 2070.1 mais à système automatique.
2073.1	10	F, ZE, NE, 9010	2073.1 MODULODUE (breveté) fermeture double latérale ambidextre en aluminium et zamack, avec cylindre de sûreté (cylindre varié), 2 vis TS M5x25 et 2 vis TS M5x35 en acier inox 304. - 2075.1 MODULODUE (breveté) comme 2073.1 mais sans cylindre de sûreté.
2075.1	10	F, ZE, NE, 9010	2076.1 MODULODUE (breveté) fermeture double pour 4 vantaux en aluminium et zamack, 2 vis TS M5x25 et 2 vis TS M5x35 en acier inox 304. 2080 MODULO poignée de tirage en aluminium. - 2080.1 comme 2080 mais pour application externe.
2076.1	10	F, ZE, NE, 9010	2070.801/.802 (breveté) kit de verrouillage pour MODULO et MODULODUE en acier inox 430 et zamack zingué noir, 2 vis TS Ø 3,9x13 en acier inox 304. - 2070.803 (breveté) comme 2070.801/.802 mais avec 2 vis TS Ø 3,9x9,5 en acier inox 304. - 2070.820 (breveté) kit de verrouillage pour MODULO et MODULODUE en acier inox 430, 2 vis TC Ø 3,9x13 et 2 vis TC Ø 3,9x19 en acier inox 304.
2080	10	F, HL, ZE, NE, 1013, 9010	
2080.1	10	F, ZE, NE, 1013, 9010	2070.1 MODULODUE (patentado) cierre simple lateral manual en aluminio y zamak, 2 tornillos TS M5x16 en acero inox 304, premontados. 2071.1 MODULODUE (patentado) como 2070.1 pero automático. 2073.1 MODULODUE (patentado) cierre lateral doble en aluminio y zamak, con bombín de seguridad (llaves diferentes), 2 tornillos TS M5x25 y 2 tornillos TS M5x35 en acero inox 304. - 2075.1 MODULODUE (patentado) como 2073.1 pero sin bombín de seguridad. 2076.1 MODULODUE (patentado) cierre doble para corredera de 4 hojas, en aluminio y zamak, 2 tornillos TS M5x25 y 2 tornillos TS M5x35 en acero inox 304. 2080 MODULO tirador en aluminio. - 2080.1 como 2080 pero para el exterior. 2070.801/.802 (patentado) kit de cerraderos para MODULO y MODULODUE en acero inox 430 y zamak zincado negro, 2 tornillos TC Ø 3,9x13 en acero inox 304. - 2070.803 (patentado) como 2070.801/.802 pero con 2 tornillos TS Ø 3,9x9,5 en acero inox 304. 2070.820 (patentado) kit de cerraderos para MODULO y MODULODUE en acero inox 430, 2 tornillos TC Ø 3,9x13 y 2 tornillos TC Ø 3,9x19 en acero inox 304.

F = silver anodized
HL = polished gold clear powder coated
ZE = electrolytic dark bronze anodized
NE = electrolytic black anodized
1013 = ivory RAL powder coated
9010 = white RAL powder coated

F = anodisé naturel
HL = anodisé or brillant
ZE = anodisé bronze foncé électrocoloré
NE = anodisé noir électrocoloré
1013 = laqué ivoire RAL
9010 = laqué blanc RAL

F = plata anodizada
HL = oro brillante anodizado
ZE = café electrocolor
NE = negro electrocolor
1013 = lacado marfil RAL
9010 = lacado blanco RAL



ART.	PZ.	DESCRIPTION - DESCRIPCIÓN
2070.830 - .849	40 200	2070.830-847 (patented) locking piece in stainless steel 430. 2070.848/.849 same as 2070.830, but available only upon order.
2070.860 - .878	40	2070.860/.861/.863/.864 keeper in stainless steel 430, 2 screws TC Ø 3,9x13 in stainless steel 304. 2070.862 same as 2070.860/.861/.863/.864 but in black galvanized zamak. 2070.865/.866/.867/.868 same as 2070.860/.861/.863/.864 but with screws TC Ø 3,9x25.
2070.897	50	2070.869/.875/.876/.877 keeper in black aluminium and preassembled grub screws.
2070.898	100	2070.870 blind keeper in black zamak, 2 screws TS Ø 3,9x9,5 in stainless steel 304.
2070.899	100	2070.871/.872/.873/.874 keeper in black galvanized zamak and preassembled grub screws. 2070.878 keeper in black galvanized zamak, 2 galvanized screws TS Ø 3,9x16. 2070.897 security against false operation in nylon and stainless steel 430, 2 galvanized screws TC Ø 3,5x13 and 1 preassembled galvanized grub screw M5x8. 2070.898 internal profile reinforcement in galvanized steel for art. 2073-2075-2076 and 2073.1-2075.1-2076.1. 2070.899 nylon spacer (mm 2) for 2073-2075-2076 and 2073.1-2075.1-2076.1.
		2070.830-847 (breveté) pêne de fixation en acier inox 430. 2070.848/.849 identique à 2070.830, mais disponibles seulement sur commande. 2070.860/.861/.863/.864 gâche en acier inox 430, 2 vis TC Ø 3,9x13 en acier inox 304. 2070.862 identique à 2070.860/.861/.863/.864 mais en zamack zingué noir. 2070.865/.866/.867/.868 identique à 2070.860/.861/.863/.864 mais avec 2 vis TC Ø 3,9x25. 2070.869/.875/.876/.877 gâche en aluminium noir et vis pointeau pré-assemblées. 2070.870 gâche à visser en zamack zingué noir, 2 vis TS Ø 3,9x9,5 en acier inox 304. 2070.871/.872/.873/.874 gâche en zamack zingué noir et vis pointeau pré-assemblées. 2070.878 gâche en zamack zingué noir, 2 vis TS Ø 3,9x16 zinguées blanches. 2070.897 dispositif anti-fausse manoeuvre en nylon et acier inox 430, 2 vis TC Ø 3,5x13 zinguées blanches et 1 vis pointeau M5x8 zinguée blanche pré-assemblée. 2070.898 douille d'écartement en acier zingué pour art. 2073-2075-2076 et 2073.1-2075.1-2076.1. 2070.899 cale nylon (mm 2) pour art. 2073-2075-2076 et 2073.1-2075.1-2076.1.
		2070.830-847 (patentado) cierre en acero inox 430. 2070.848/.849 como 2070.830, pero a disposición sólo detrás pedido. 2070.860/.861/.863/.864 contracierre en acero inox 430, 2 tornillos TC Ø 3,9x13 en acero inox 304. 2070.862 como 2070.860/.861/.863/.864 pero en zamack zincado negro. 2070.865/.866/.867/.868 como 2070.860/.861/.863/.864 pero con tornillos TC Ø 3,9x25. 2070.869/.875/.876/.877 contracierre en aluminio negro y prisioneros premontados. 2070.870 contracierre oculto en zamack zincado negro, 2 tornillos TS Ø 3,9x9,5 en acero inox 304. 2070.871/.872/.873/.874 contracierre en zamack zincado negro y prisioneros premontados. 2070.878 contracierre en zamack zincado negro, 2 tornillos TS Ø 3,9x16 zincados blancos. 2070.897 seguridad contra falsa maniobra en nylon y acero inox 430, 2 tornillos TC Ø 3,5x13 zincados blancos y 1 prisionero M5x8 zincado premontado. 2070.898 distanciador en acero zincado para los artículos 2073-2075-2076 y 2073.1-2075.1-2076.1. 2070.899 espesor en nylon (2 mm) para los artículos 2073-2075-2076 y 2073.1-2075.1-2076.1.

MODULODUE: main characteristics
MODULODUE: les caractéristiques
Las principales características de MODULODUE



2070.1-2071.1

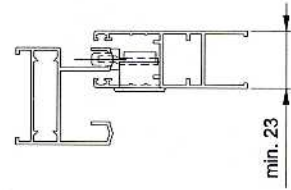
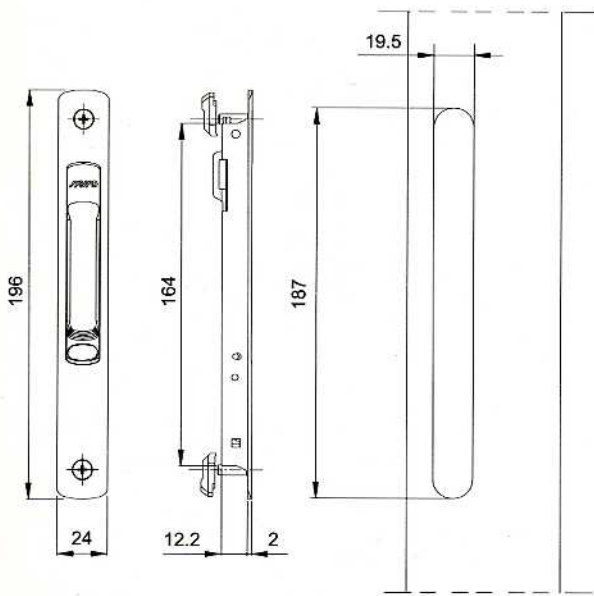

2073.1-2075.1

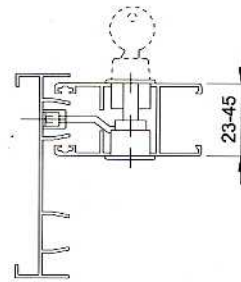
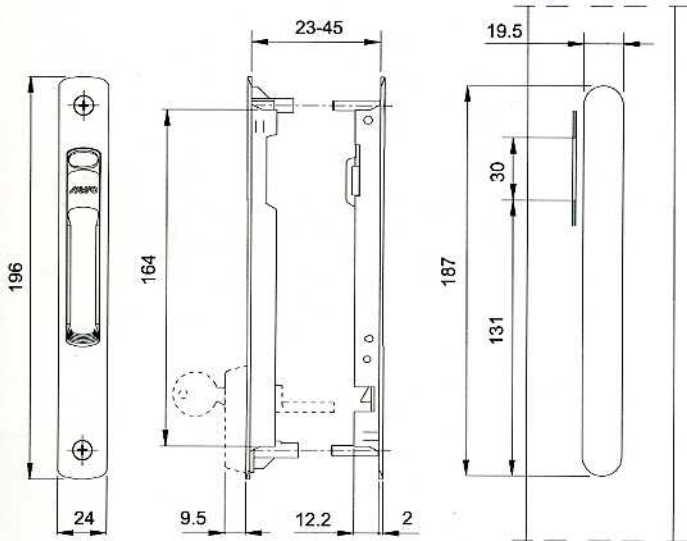

2076.1

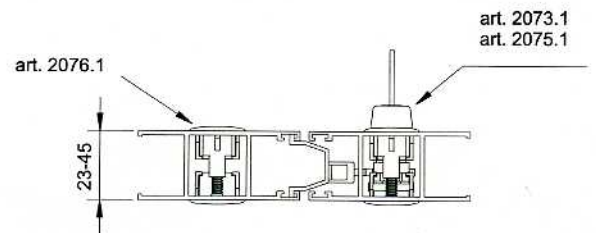
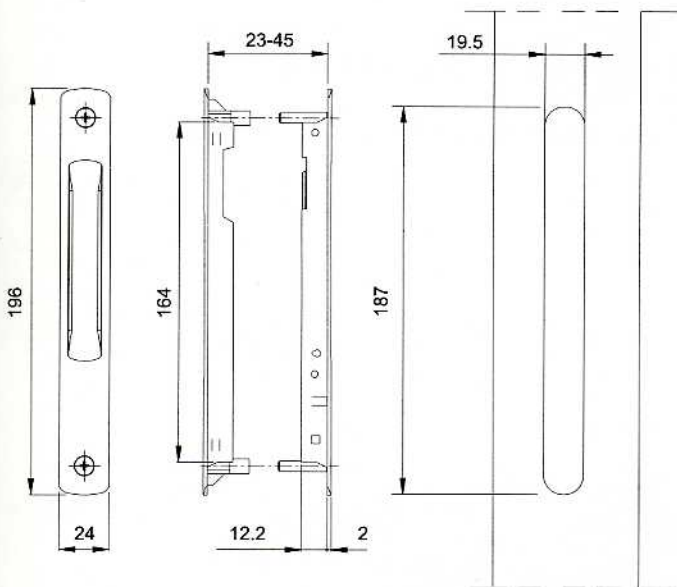

2070.801

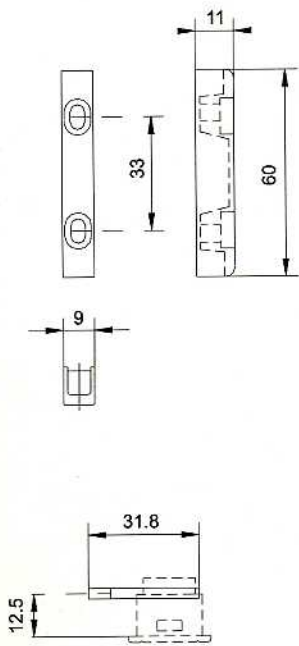

2070.802

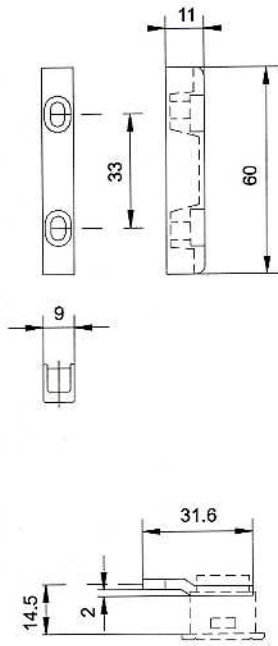

2070.803

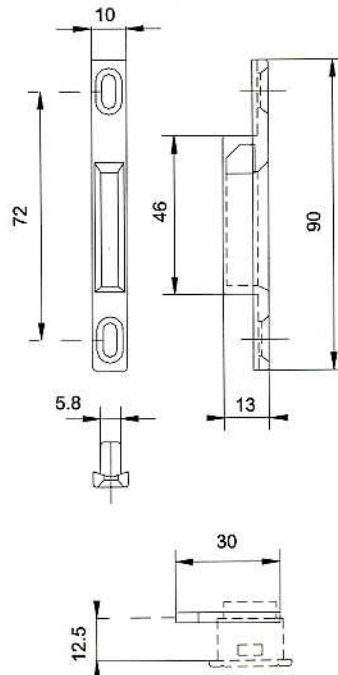

2070.820

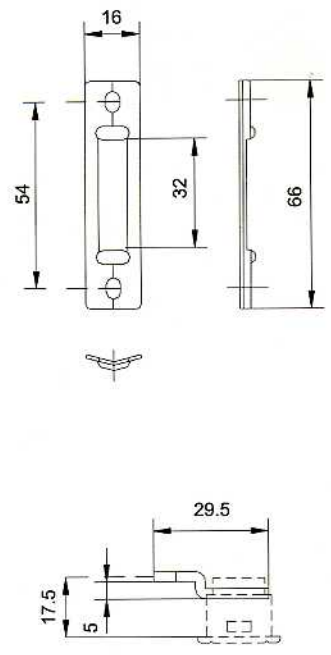

2070.830-849

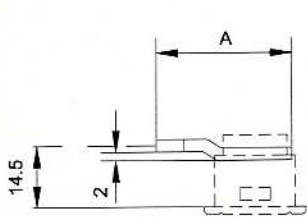

2070.830	$\frac{A}{38,5}$
2070.834	31,5

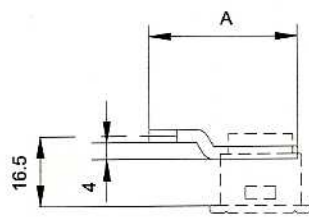

2070.831	$\frac{A}{42,5}$
2070.836	34,5
2070.837	37,5

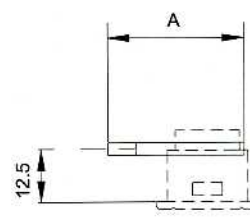

2070.832	$\frac{A}{35,5}$
2070.833	32
2070.839	43,5
2070.840	38,5
2070.841	40,5
2070.842	30
2070.843	55

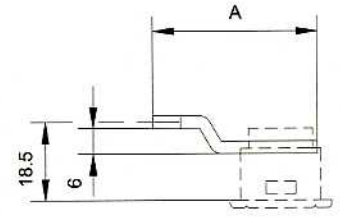

2070.835	$\frac{A}{38,5}$
2070.838	33,5

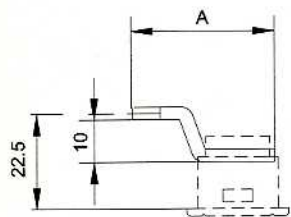

2070.844	$\frac{A}{35}$
2070.845	49,5

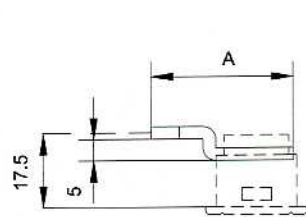

2070.846	$\frac{A}{29,5}$
2070.848	33,5

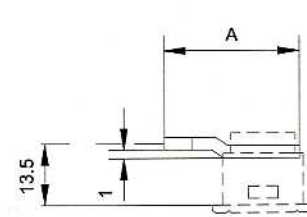

2070.847	$\frac{A}{30}$
----------	----------------

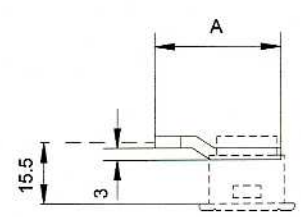

2070.849	$\frac{A}{38,5}$
----------	------------------

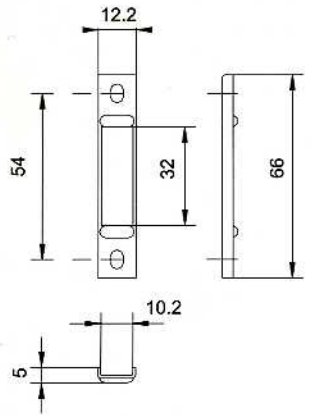

2070.860/865

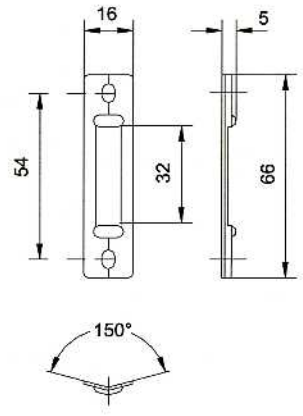

2070.861/867

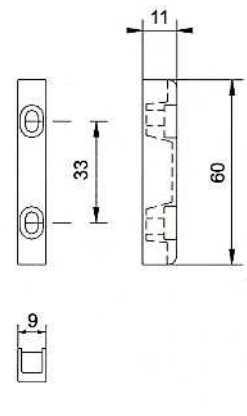

2070.862

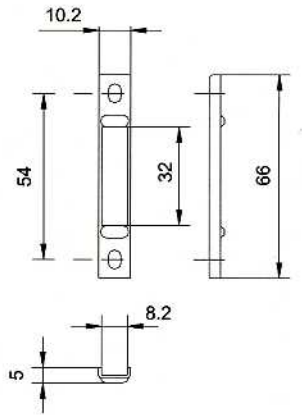

2070.863/866

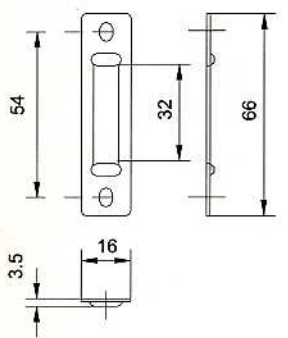

2070.864/868

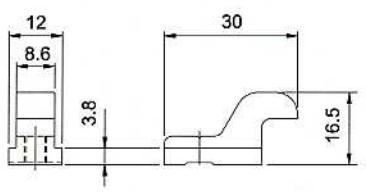

2070.869

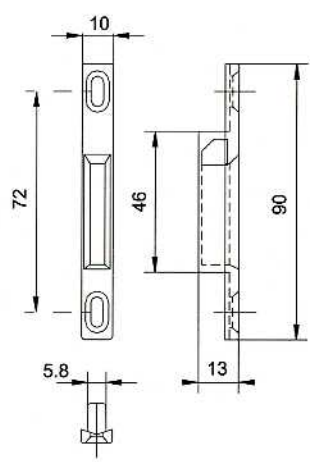

2070.870

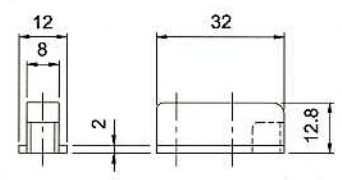

2070.871

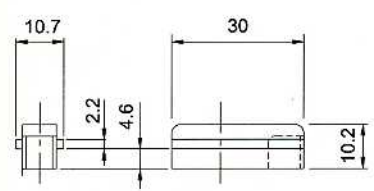

2070.872

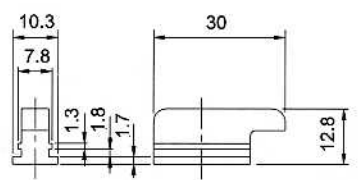

2070.873

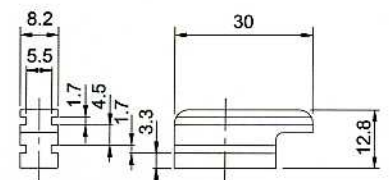

2070.874

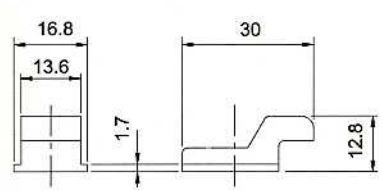

2070.875

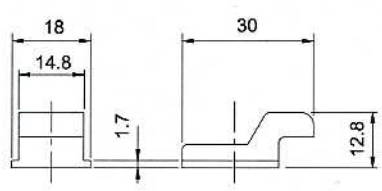

2070.876

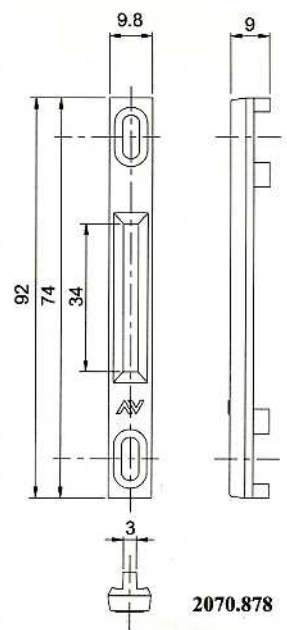

2070.878

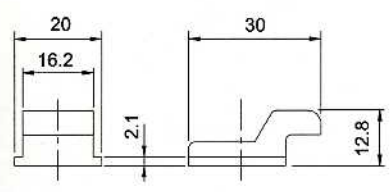

2070.877

2070.897

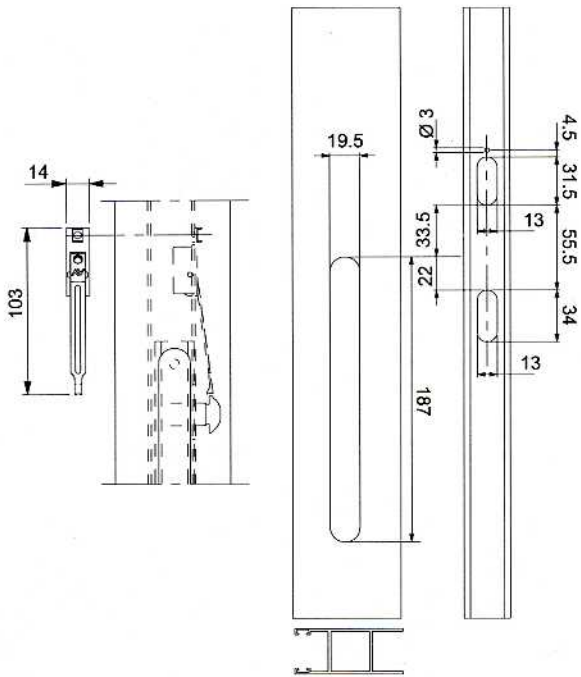

2070.898

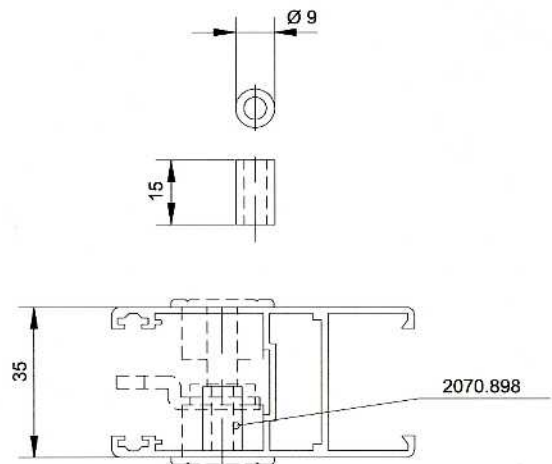

2070.899

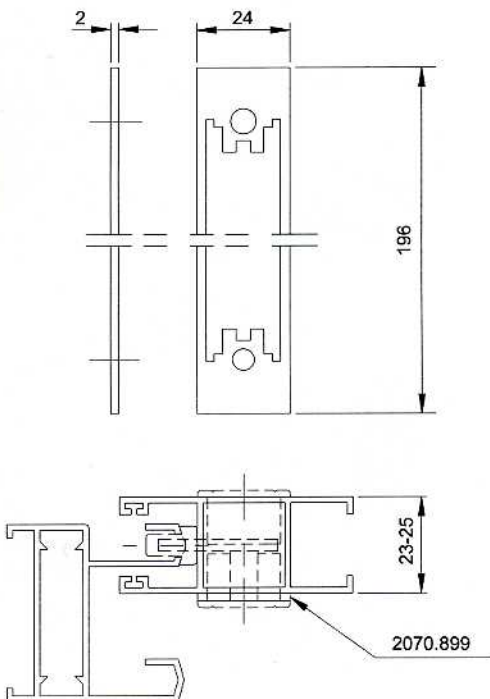

2080

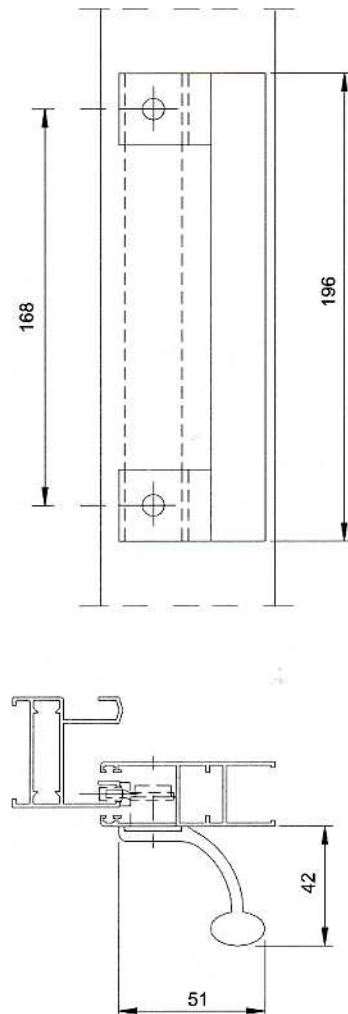

2080.1

