

VENTILATION SASH



Limited opening casement

- Security limited opening
- Microventilation device integrated

VENTILATION SASH

LIMITED OPENING CASEMENT



Opening/closing position.

Window can be totally opened only inserting key in the handle and rotating it of 180°.



Security limited opening.

Without inserted key, opening window can be limited on rotating handle of 90°.



Microventilation.

Without inserted key, to obtain microventilation opening it is sufficient to rotate the handle.

Accessories scheme

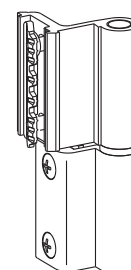
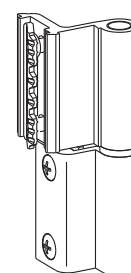
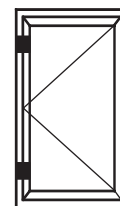
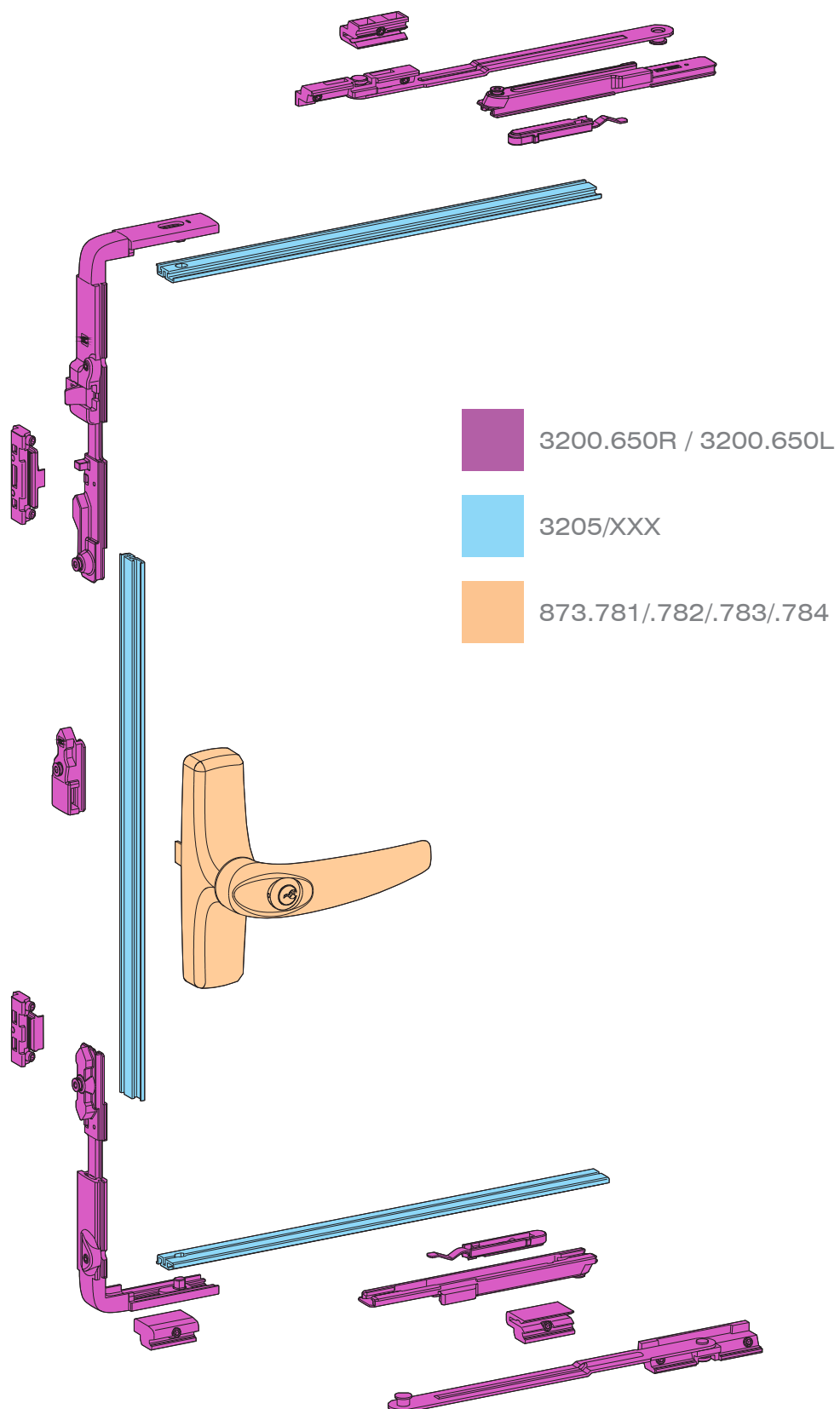

Hinge range for side hung casement openings

60-70 KG

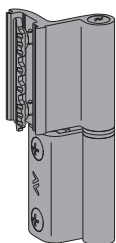

1115/.1:
2 hinges Kg 60.
3 hinges Kg 70.

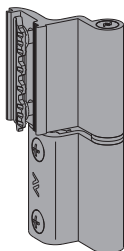

1115/.1:
2 hinges Kg 60.
3 hinges Kg 70.

80-90 KG

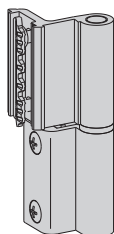

1121/.1/.21:
2 hinges Kg 80.
3 hinges Kg 90.

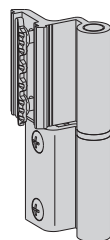

1121/.1/.21:
2 hinges Kg 80.
3 hinges Kg 90.

90-100 KG

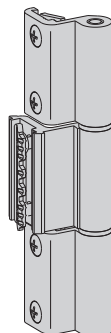

1122/.1/.21:
2 hinges Kg 90.
3 hinges Kg 100.

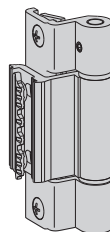

1122/.1/.21:
2 hinges Kg 90.
3 hinges Kg 100.

80-150 KG

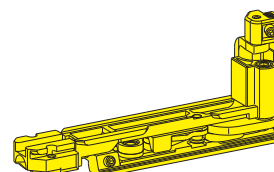
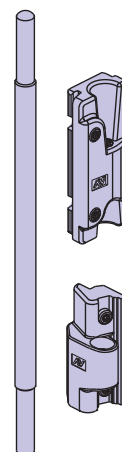
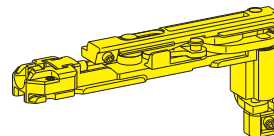

80 KG

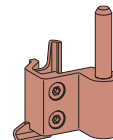
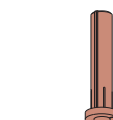
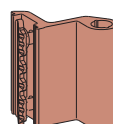
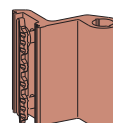
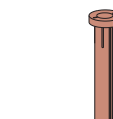
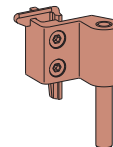

1115/.1 - 1116.1



1121/.1/.21 - 1122/.1/.21 - 1122.200/.201 - 1123/.21



3020W



3010.718R - 3010.718R



3200.809/.829

Hinge range for side hung casement openings

110 KG

140 KG

170 KG

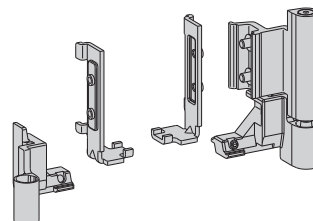
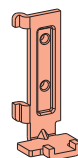
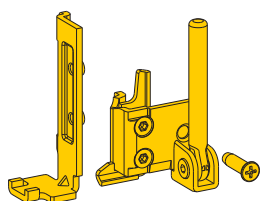
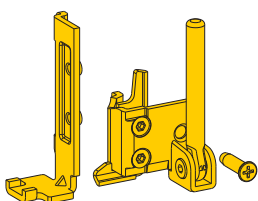
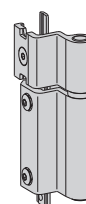
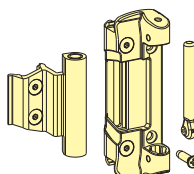
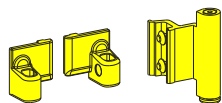
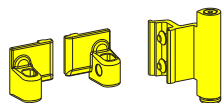
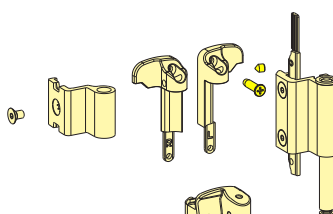
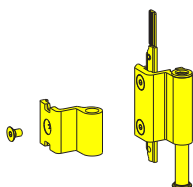
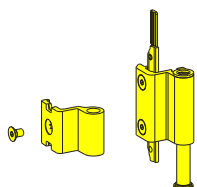
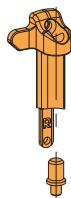
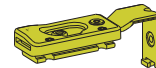
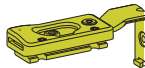
70 KG for internally
flush profiles

3200.840R - 3200.840L
3200.860R - 3200.860L

3200.709/.729

3200.710R - 3200.710L
3200.730R - 3200.730L

3200.708R - 3200.708L

3200.701/.721





3200.700R - 3200.700L
3200.720R - 3200.720L

3200.740/.745

Limited opening casement and accessories

	Article	Description	Pcs.	Finishes
	3200.650R	VENTILATION SASH Closing kit for limited right hand casement in white galvanized zamak, nylon and stainless steel, pre-assembled screws in stainless steel.	5	
	3200.650L	Like 3200.650R but left version.	5	
	Article	Description	Pcs.	Finishes
	873.781	MANON Left handle for tilt and turn with microventilation device and with tilt-first gearing, in die-cast metal, with safety cylinder (same keys), dist. between centres 84.5-98 mm, 2 TORX® (T15) cap screws M5x13 in stainless steel.	5	1013, 7032, 7035, 8019, 9001, 9005, 9010, 9016, BL10, B.SA, OTT, PVD X, SILV
	873.782	Like 873.781 but RH.	5	
	873.783	Like 873.781 but dist. between centres 92-104 mm.	5	
	873.784	Like 873.783 but RH.	5	
	Article	Description	Pcs.	Finishes
	3205/25	(patented) 250 mm transmission rod in silver pre-oxidized extruded aluminum.	100	
	3205/40, /60, /80, /100, /120, /140,	Like 3205/25 but of 400, 600, 800, 1000, 1200, ou 1400 mm.	100	
	3205/160, /180, /200, /220, /300	Like 3205/25 but of 1600, 1800, 2000, 2200 ou 3000 mm.	50	
	Article	Description	Pcs.	Finishes
	1115	MORSADUE+ (patented) Two-wing hinge in aluminium, 2 nylon bushings, galvanized steel pin, pre-assembled counterplates and 4 countersunk oval head screws M5x10 in stainless steel 430. Weight capacity: 2 hinges Kg 60, 3 hinges Kg 70.	50	1013, 1015, 1247, 6005, 8017, 8019, 9001, 9005, 9010, 9016, B.SA, BL10, BR5, BR801, C, F, GR217, GR50, GR51, GR606, HL, NE, RD501, SILV, U, WT005, ZE
	1115.1	Like 1115 but not finishes 1247, BR5 but also finishes BW21, GREY e XSD.	50	
	Article	Description	Pcs.	Finishes
	1116.1	MORSADUE+ (patented) Two-wing hinge in aluminium for third casement, 2 nylon bushings, galvanized steel pin, pre-assembled counterplates and 4 countersunk oval head screws M5x10 in stainless steel 430. Weight capacity: 2 hinges Kg 60, 3 hinges Kg 70.	50	1013, 1015, 6005, 8017, 8019, 9001, 9005, 9010, 9016, BL10, BR5, BR801, C, F, GR217, GR50, GR606, HL, NE, RD501, SILV, U, WT005, XSD, ZE





Limited opening casement and accessories

	Article	Description	Pcs.	Finishes
	1121	MORSA+ (patented) Two-wing aluminium hinge, nylon bushing, pin, counterplates and 4 pre-assembled countersunk oval head screws M5x10 in stainless steel 430. Weight capacity: 2 hinges 80 Kg, 3 hinges 90 Kg (PVD H, PVD X, XSD=pack. 20 pcs.).	50	1013, 1015, 1035, 1247, 3003, 6002, 6005, 7016, 7035, 7047, 8017, 8019, 9001, 9005, 9010, 9016, B.MA, B.SA, BL10, BL25, BR5, BR801, BW21, C, F, GR217, GR50, GR51, GR606, HL, NE, PVD H, PVD X, RD501, SILV, U, WT005, XSD, ZE
	1121.1	Like 1121 but not finishes 1035, 7047, BL25, but also finishes 7032, GREY.	50	
	Article	Description	Pcs.	Finishes
	1121.21	MORSA+ (patented) Two-wing aluminium hinge, nylon bushing, pin, counterplates and 4 pre-assembled countersunk oval head screws M5x10 in stainless steel 430. Weight capacity: 2 hinges 80 Kg, 3 hinges 90 Kg (PVD H, PVD X, XSD=pack. 20 pcs.).	50	1013, 1015, 8017, 8019, 9001, 9005, 9010, 9016, B.MA, B.SA, BL10, BR5, BR801, C, F, GR217, GR50, GR51, GR606, HL, NE, PVD H, PVD X, SILV, U, WT005, XSD
	Article	Description	Pcs.	Finishes
	1122	MORSA+ (patented) Three-wing pre-assembled aluminium hinge, nylon bushings, pins, counterplates and 6 pre-assembled countersunk oval head screws M5x10 in stainless steel 430. Weight capacity: 2 hinges 90 Kg, 3 hinges 100 Kg (XSD: pack. 10 pcs.).	20	1013, 1015, 1035, 3003, 6002, 6005, 8017, 8019, 9001, 9005, 9010, 9016, B.SA, BL10, BR5, BR801, BW21, C, F, GR217, GR606, HL, NE, PVD H, PVD X, RD501, SILV, U, WT005, XSD, ZE
	1122.1	Like 1122 but not finishes 1035, but also finishes 7032, 7035, GR50, GR51.	20	
	Article	Description	Pcs.	Finishes
	1122.21	MORSA+ (patented) Three-wing pre-assembled aluminium hinge, nylon bushings, pins, counterplates and 6 pre-assembled countersunk oval head screws M5x10 in stainless steel 430. Weight capacity: 2 hinges 90 Kg, 3 hinges 100 Kg (PVD X, XSD: pack. 10 pcs.).	20	1013, 1015, 8017, 8019, 9001, 9005, 9010, 9016, B.SA, BL10, BR5, BR801, C, F, GR217, GR50, GR51, GR606, HL, NE, PVD X, SILV, U, XSD
	Article	Description	Pcs.	Finishes
	1122.200	MORSA+ (patented) 3-wing pre-assembled hinge in aluminium, nylon bushing, pre-assembled extractable pin, indented plates and 6 pre-assembled countersunk head screws M5x9 in stainless steel 430. Carryng capacity: 2 hinges 90 Kg., 3 hinges Kg. 100 (PVD H, PVD X, XSD: pack. 10 pcs.).	20	1013, 1015, 1035, 1247, 6005, 8017, 8019, 9001, 9005, 9010, 9016, B.MA, B.SA, BL10, BL25, BR5, BR801, BW21, C, F, GR217, GR606, GREY, HL, NE, PVD H, PVD X, RD501, SILV, U, WT005, XSD, ZE
	1122.201	Like 1122.201 but not finishes 1035, 1247, BL25, GREY, but also finishes 3003, 7032, 7035.	20	

Limited opening casement and accessories

	Article	Description	Pcs.	Finishes
	1123	MORSA+ (patented) Two-wing aluminium hinge for third casement, nylon bushing, pin, counterplates and 4 pre-assembled countersunk oval head screws M5x10 in stainless steel 430. Weight capacity: 2 hinges 80 Kg, 3 hinges 90 Kg (PVD H, PVD X, XSD: pack. 20 pcs.).	50	1013, 1015, 1247, 3003, 6005, 7032, 7035, 7047, 8017, 8019, 9001, 9005, 9010, 9016, B.MA, B.SA, BL10, BR5, BR801, BW21, C, F, GR217, GR50, GR51, GR606, HL, NE, PVD H, PVD X, RD501, SILV, U, WT005, XSD, ZE
	Article	Description	Pcs.	Finishes
	1123.21	MORSA+ (patented) Two-wing aluminium hinge for third casement, nylon bushing, pin, counterplates and 4 pre-assembled countersunk oval head screws M5x10 in stainless steel 430. Weight capacity: 2 hinges 80 Kg, 3 hinges 90 Kg (PVD X, XSD: pack. 20 pcs.).	50	1013, 1015, 8017, 8019, 9001, 9005, 9010, 9016, B.SA, BL10, BR5, BR801, C, F, GR217, GR50, GR51, GR606, HL, NE, PVD H, PVD X, SILV, U, XSD
	Article	Description	Pcs.	Finishes
	3010.718R	RH reinforcement kit 150 Kg with supports in white galvanized zamak, top end and grub screws TORX® pre-assembled in stainless steel.	5	
	Article	Description	Pcs.	Finishes
	3010.718L	Like 3010.718R but left version.	5	
	Article	Description	Pcs.	Finishes
	3020W	(patented) Concealed hinges kit for RIBANTA INCANTO secondary casement in white galvanized zamak and high resistance white galvanized steel. Casement max weight of 80 Kg.	5	
	Article	Description	Pcs.	Finishes
	3200.700R	Right bottom hinge support (weight capacity 170 Kg) in stainless steel 304.	5	
	3200.700L	Like 3200.700R but left version..	5	
	3200.720R	Like 3200.700R but 20 pcs. each box.	20	
	Article	Description	Pcs.	Finishes
	3200.720L	Like 3200.720R but left version.	20	

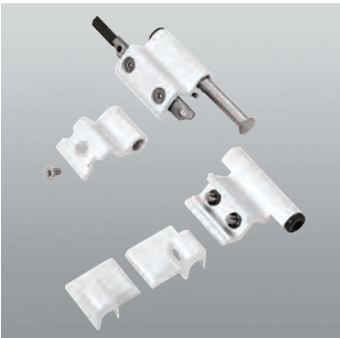
Limited opening casement and accessories

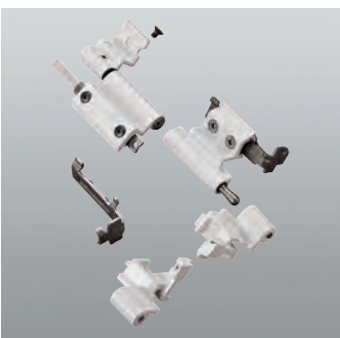
	Article	Description	Pcs.	Finishes
	3200.701	(patented) Non-handed hinge kit (weight capacity 170 Kg) in aluminum and zamak, premounted upper pin and counterplate in stainless steel 430, lower pin in galvanized steel with premounted stainless steel grub screw, premounted nylon bushing and adjustment grub screw, 2 socket flat head screws M5x12 in stainless steel premounted on lower window leaf, 1 grub screw M5x6, 1 socket flat head screw M5x8 and 2 self-forming countersunk head screws M5x18 in stainless steel 304.	5	1013, 1015, 1247, 3001, 6005, 7016, 8017, 8019, 8077, 9001, 9005, 9010, 9016, B.MA, B.SA, BL10, BR5, BR801, BW21, C, GR217, GR606, GREY, PVD H, PVD X, SILV, WT005
	3200.721	Like 3200.701 but 20 pcs. each box.	20	1013, 7035, 9005, 9010, 9016, B.SA, BL25, BW21, C, SILV
	Article	Description	Pcs.	Finishes
	3200.708R	(patented) Right reinforcement kit for hinge 3000.709 (upper part), weight capacity 140 Kg, in zamak, pin in stainless steel 430, 1 self-forming countersunk head screw M5x18 in stainless steel 304.	5	1013, 1015, 1247, 3001, 6005, 7035, 8017, 8019, 8077, 9001, 9005, 9010, 9016, B.SA, BL10, BR5, BR801, BW21, C, GR217, GR606, GREY, PVD H, PVD X, SILV, WT005
	3200.708L	Like 3200.708R but left version and also finishes 7047, B.MA, XSD.	5	
	Article	Description	Pcs.	Finishes
	3200.709	(patented) Non-handed hinge kit (weight capacity 110 Kg) in aluminum, premounted upper pin and counterplate in stainless steel 43, premounted nylon bushing and adjustment grub screw, 2 socket flat head screws M5x12 in stainless steel mounted on lower window leaf, 1 socket flat head screw M5x8 in stainless steel 304, nylon pin covers.	5	1013, 1015, 1035, 1247, 3001, 6005, 7016, 7032, 7035, 8017, 8019, 8077, 9001, 9005, 9010, 9016, B.MA, B.SA, BL10, BR5, BR801, BW21, C, GR217, GR51, GR606, GREY, HL, PVD H, PVD X, SILV, WT005
	3200.729	Like 3200.709 but 20 pcs. each box and finishes 1013, 1015, 7016, 7047, 8017, 9005, 9010, 9016, B.SA, BL25, BW21, C, HL, SILV.	20	
	Article	Description	Pcs.	Finishes
	3200.710R	Right lower support and pin for secondary leaf hinge (weight capacity 110-140 Kg), in stainless steel 304, right pin in stainless steel 201 with premounted counterplate in stainless steel 430 and pin in galvanized steel, 1 self-forming countersunk head screw M5x18 in stainless steel 304.	5	
	3200.710L	Like 3200.710R but left version.	5	
	3200.730R	Like 3200.710R but 20 pcs. each box.	5	
	3200.730L	Like 3200.730R but left version.	5	
	Article	Description	Pcs.	Finishes
	3200.740	Non-handed hinge kit for RIBANTA 5 (weight capacity 70 Kg.) for internally flush profiles.	5	1013, 8017, 8019, 9001, 9005, 9010, BL10, BR5, BR801, C, GR217, GR51, GR606, HL, PVD H, PVD X, SILV
	3200.745	Like 3200.740 but for internally flush profiles with 4 mm teeth.	5	1013, 8017, 8019, 9001, 9005, 9010, B.MA, BL10, BR5, BR801, C, GR217, GR51, GR606, HL, PVD H, PVD X, SILV

Limited opening casement and accessories

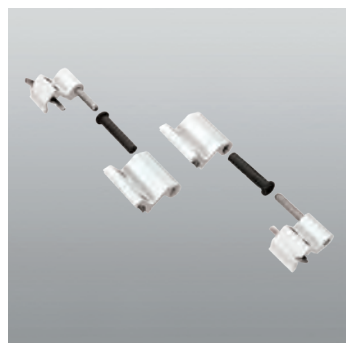

Article	Description	Pcs.	Finishes
3200.809	Hinge kit in aluminium for second leaf, pre-assembled pins and counterplates in stainless steel 430, black nylon bushings, 4 socket head cap screws M5x16 and 2 special countersunk oval socket flat head screws M5x10 in stainless steel 430, pre-assembled. Weight capacity 80 Kg.	5	1013, 1015, 1247, 6005, 7016, 7035, 8017, 8019, 9001, 9005, 9010, 9016, B.SA, BL10, BR5, BR801, BW21, C, GR217, GR606, HL, PVD H, PVD X, SILV, WT005
3200.829	Like 3200.809 but 20 pcs. each box. Each box contains also 1 positioning jig in black nylon code 3200.957.	20	1013, 9005, 9010, B.SA, C



Article	Description	Pcs.	Finishes
3200.840R	(patented) Right adjustable upper support for secondary leaf hinge in white galvanized zamak and stainless steel arm, premounted stainless steel screw 304.	5	
3200.840L	Like 3200.840R but left version.	5	
3200.860R	Like 3200.840R but 20 pcs. each box.	20	
3200.860L	Like 3200.860R but left version.	20	

Limited opening casement and accessories

3200.650

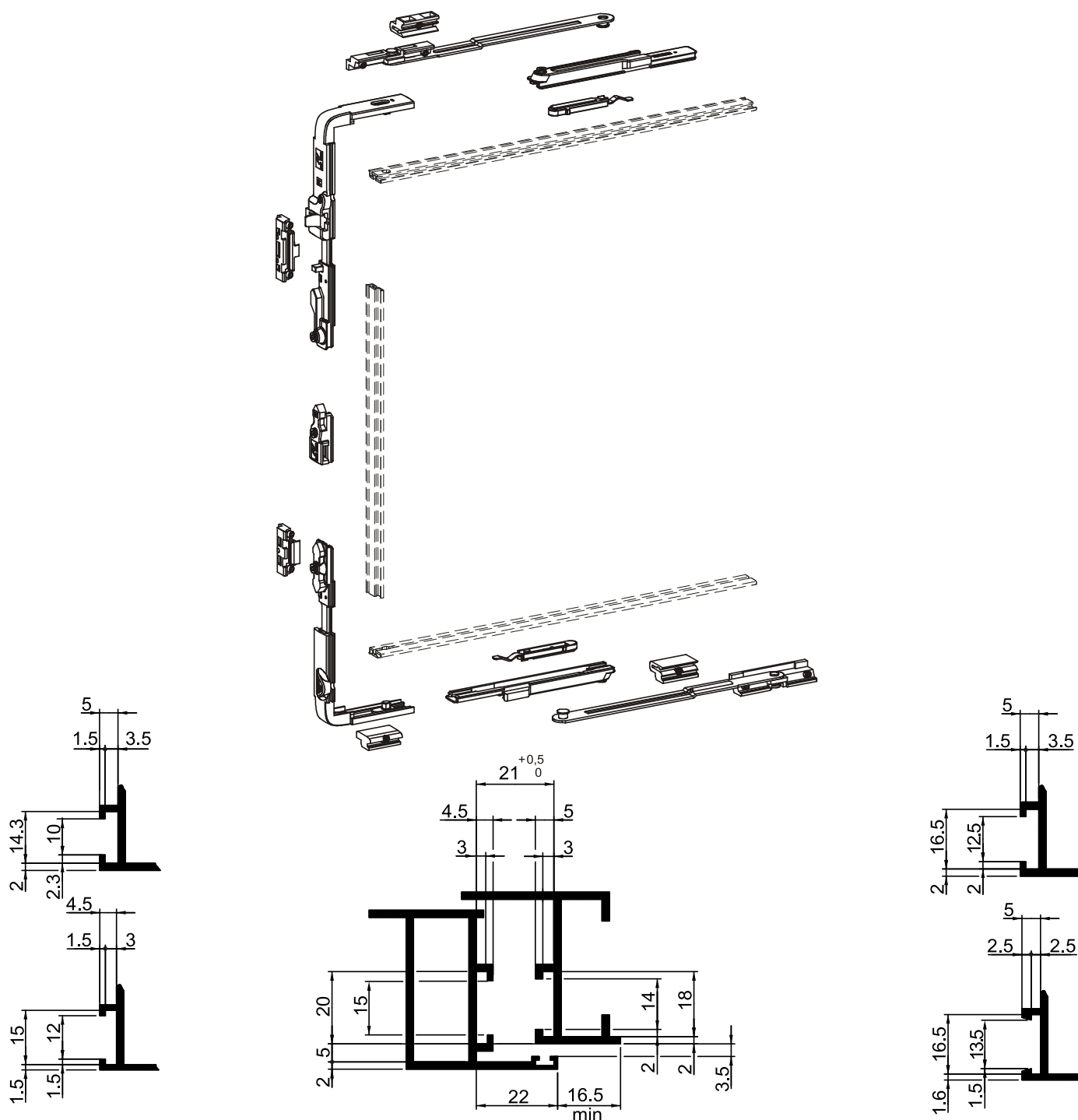

Limited opening casement handles

873.781 - 873.782

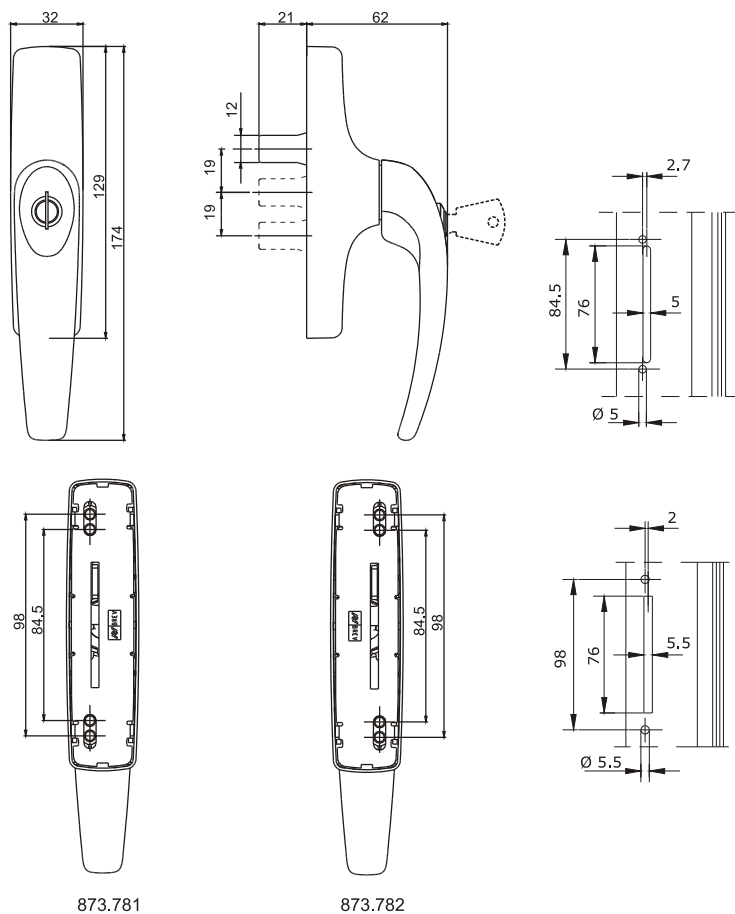

873.783 - 873.784

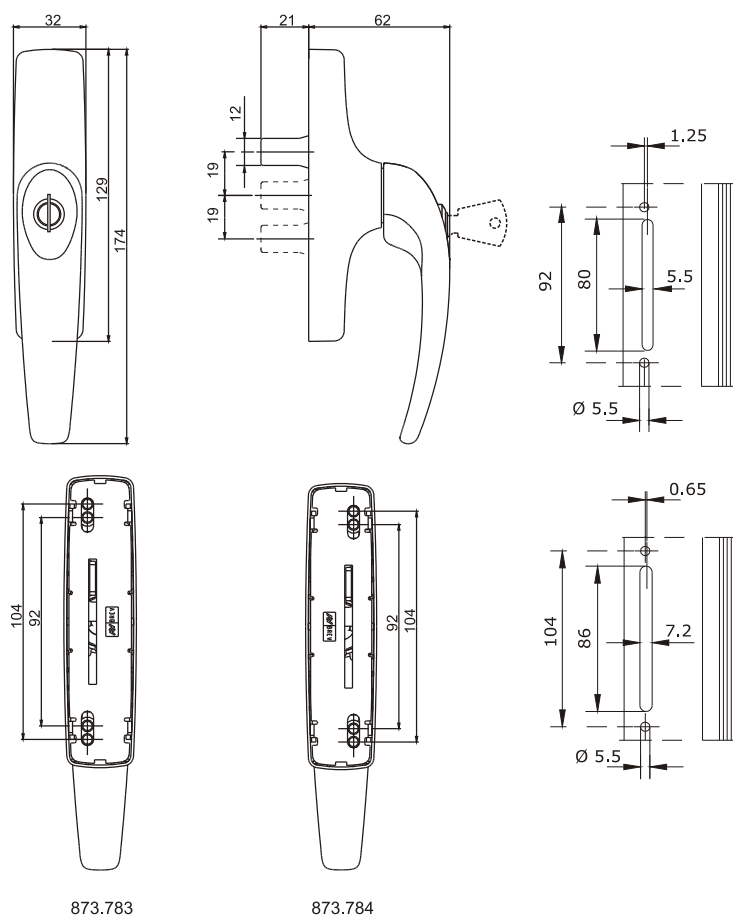



Savio S.p.A.
Via Torino, 25 (S.S. 25) - 10050 Chiusa S. Michele (TO)
Tel. +39 011 964 34 64 - Fax +39 011 964 34 74
www.savio.it - export@savio.it

