

SLIDEART TS

New Tilt and Slide closing mechanism

MAIN CHARACTERISTICS:

- Weight capacity: 100 kg and 150 kg;
- Dimensional limits of the leaf: L = 700 - 1700 mm, H = 850 - 2700 mm;
- Rebate height 7÷ 12 mm;
- Roller outreach 133 mm;
- Suitable for all profiles;
- Cover and plug design;
- Maximum freedom in the finishes;
- simplified machining;
- Screws in stainless steel;
- Closures with traditional system and system with telescopic rod;
- Simple and wide-ranging adjustments;
- Passed the test required by standard UNI EN 13126-17 25,000 cycles (class 5);

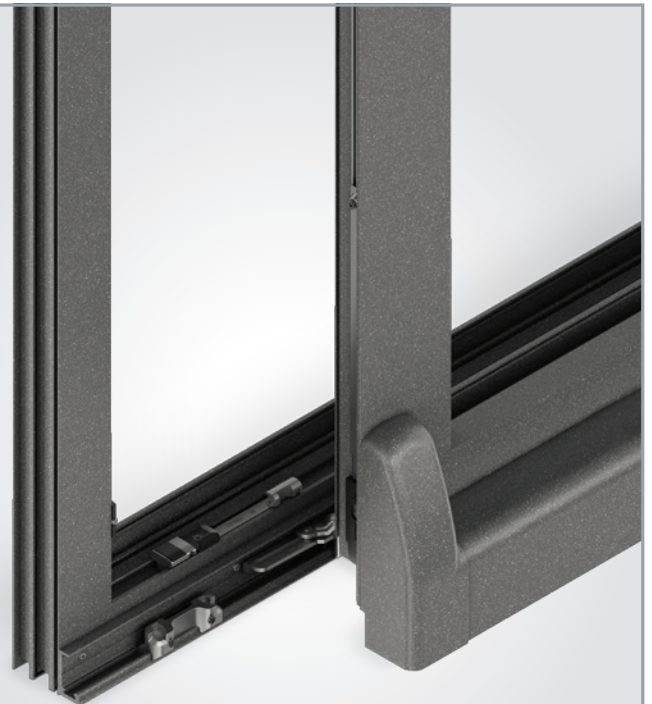

2401.1
2401.2

2406/1100
2406/1400
2406/1700

POSSIBLE COMBINATIONS

Thanks to the **versatility** of the product, there is a very wide choice of possible combinations.

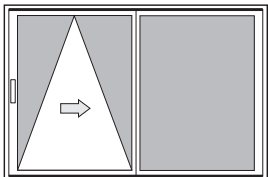

LH leaf with lateral fixed lights

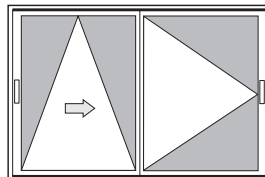

LH leaf with lateral leaf that can be opened

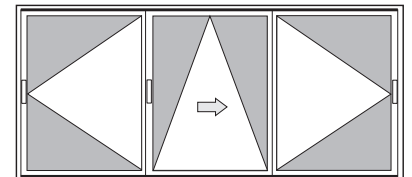

LH leaf with leaves that can be opened

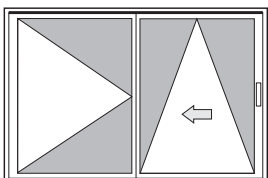

RH leaf with side leaf that can be opened

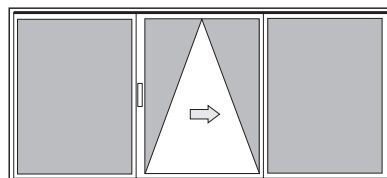

LH leaf with lateral fixed lights

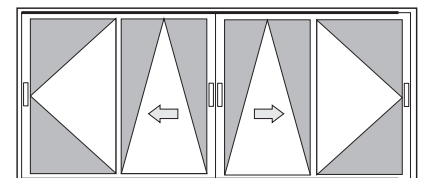

LH + RH leaf with 2 leaves that can be opened

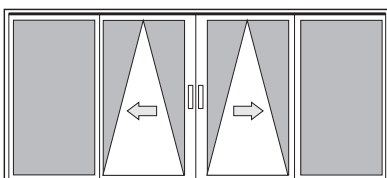

RH + LF leaf with lateral fixed lights

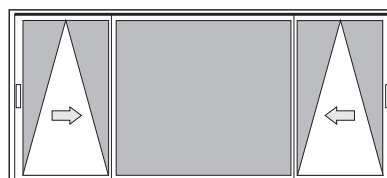

RH + LF leaf with central fixed light

SLIDEART TS

New Tilt and Slide closing mechanism

2401.1
2401.2

2406/1100
2406/1400
2406/1700

ROLLER, GUIDE AND COVER CONFIGURATIONS

The rollers are available in two versions: right and left.

The guides and covers are packaged in kits and offered in three different versions, depending on the maximum configurable width of the leaf. The kits are ambidextrous; the leaf stop on the opposite side of the handle is pre-assembled on the left but can be easily reversed.

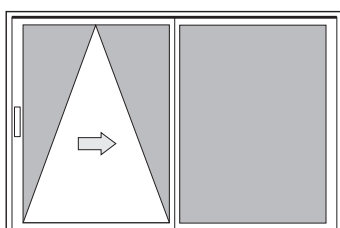

LH leaf with lateral fixed light

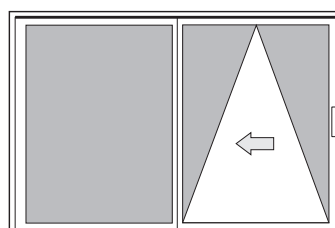

RH leaf with lateral fixed light

Slideart TS is available in the following finishes:

ARTICLE	NAME	DESCRIPTION	STANDARD FINISHES	PCS./PACK.
2401.701	SLIDEART TS	Kit with reinforcement supports	1013, 9005, 9010, BL10, C, SILV	1
2406/1100	SLIDEART TS	Guides and covers (L= from 700 to 1100)	1013, 9005, 9010, BL10, C, F, NE, SILV, ZE	1
2406/1400	SLIDEART TS	Guides and covers (L= from 1101 to 1400)	1013, 9005, 9010, BL10, C, F, NE, SILV, ZE	1
2406/1700	SLIDEART TS	Guides and covers (L= from 1401 to 1700)	1013, 9005, 9010, BL10, C, F, NE, SILV, ZE	1

The uncoated version (C) is offered to allow customization through any sort of finish.

DESCRIPTION	ITEM CODE	LEAF DIMENSIONS			
		L	700 ÷ 1100	1101 ÷ 1400	1401 ÷ 1700
		H	850 ÷ 2700	850 ÷ 2700	850 ÷ 2700
Left-hand rollers basic package	2401.1				
Right-hand rollers basic package	2401.2		1	1	1
Guides and covers	2406/1100		1		
	2406/1400			1	
	2406/1700				1

SLIDEART TS

New Tilt and Slide closing mechanism

2401.1
2401.2

2406/1100
2406/1400
2406/1700

TOP FRAME GUIDES

The top guide on the frame is secured by means of **special clips in reinforced nylon** that fit on the back of guide by simply rotating them. These clips provide a great advantage **in terms of appearance**, as the fixing accessories are concealed and there are no exposed screws. Moreover, thanks to the fact that there is no need to drill holes in the guide, the latter can be painted in **any colour**.

The lateral plugs are in zamak and thus can be painted to match the colour of the guide.

These exclusive innovations have simplified the process, making it essentially error-free.

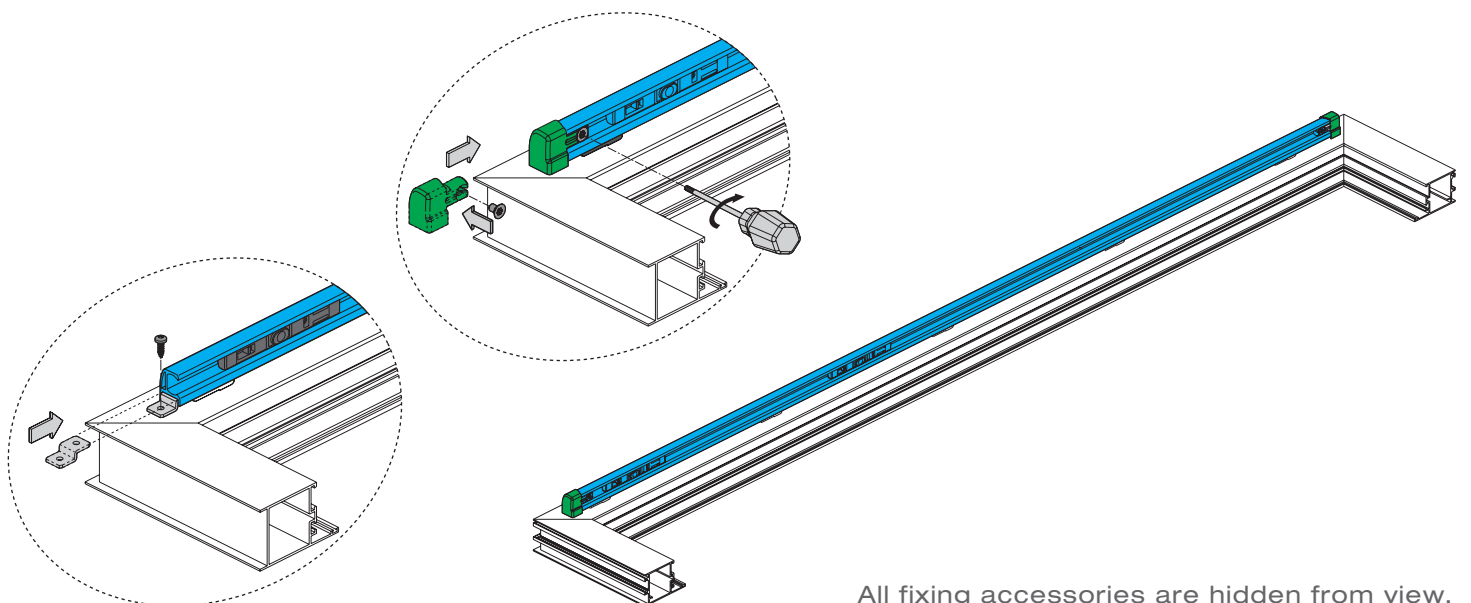
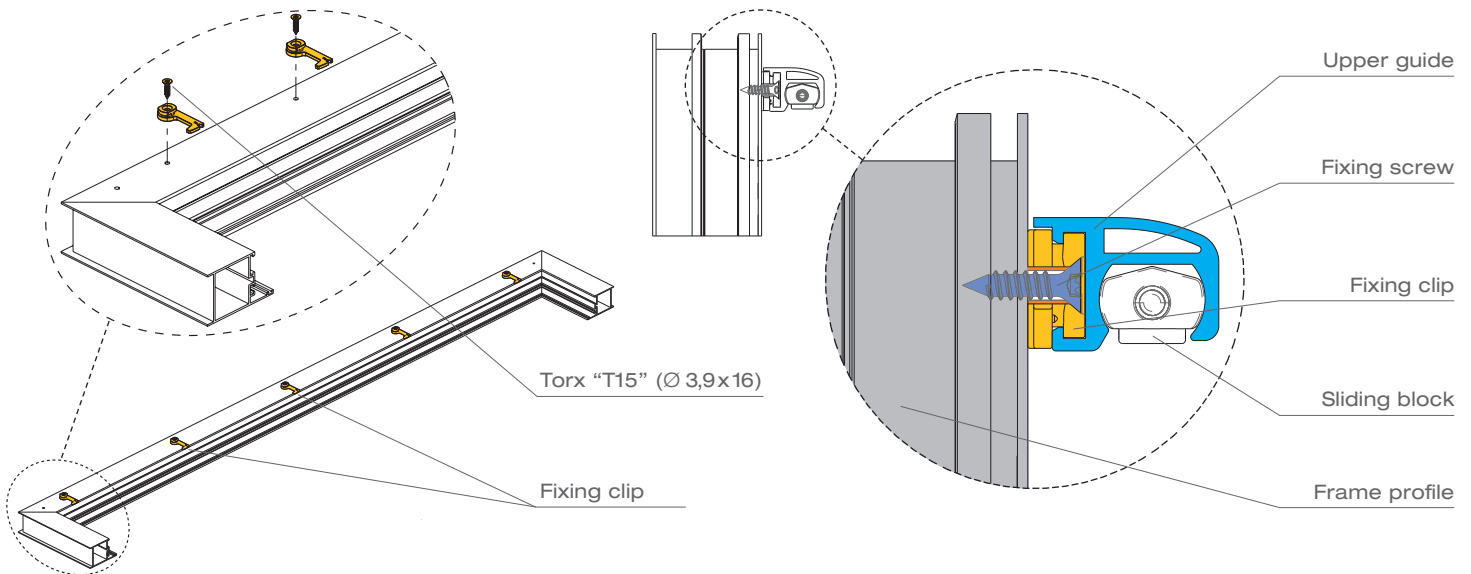
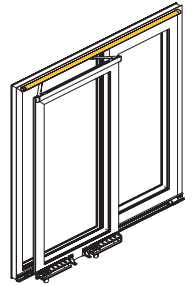

All fixing accessories are hidden from view.

SLIDEART TS

New Tilt and Slide closing mechanism

2401.1
2401.2

2406/1100
2406/1400
2406/1700

BOTTOM FRAME GUIDES

The bottom guide is made of extruded anodized aluminium, and then painted in the selected colour, thus hiding the sliding part. This means in maximum freedom in the finishes while maintaining **optimally smooth sliding**.

In addition, **the fixing process is very quick** thanks to the use of rivets.

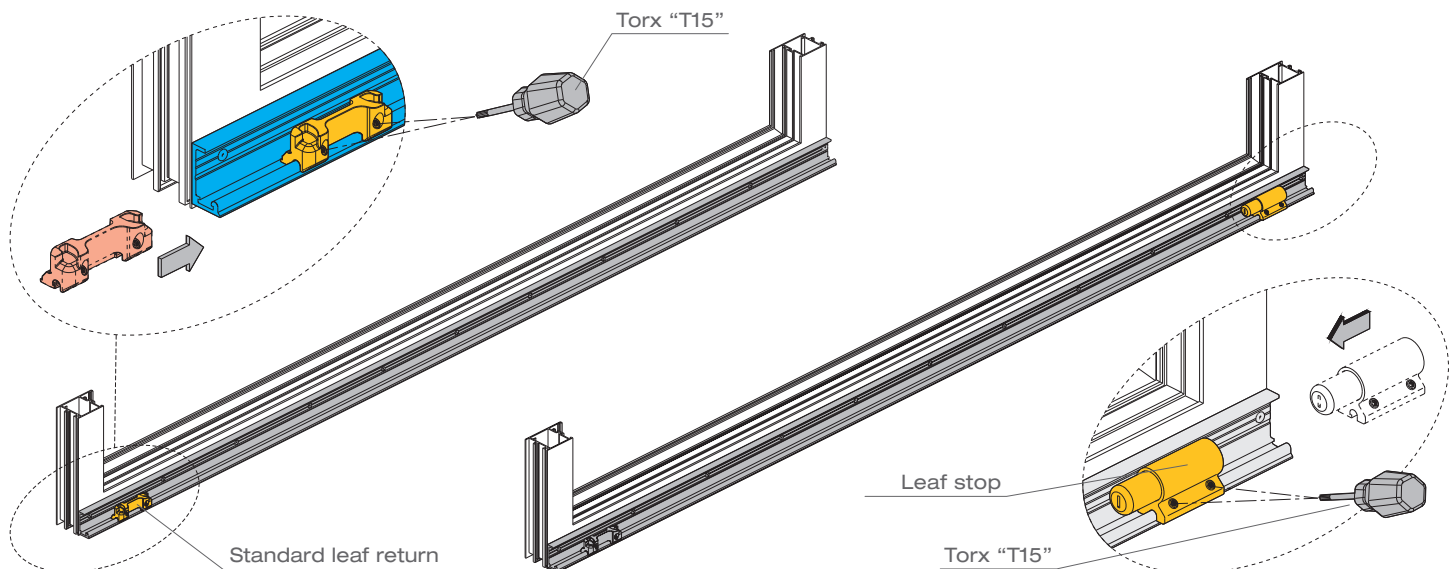
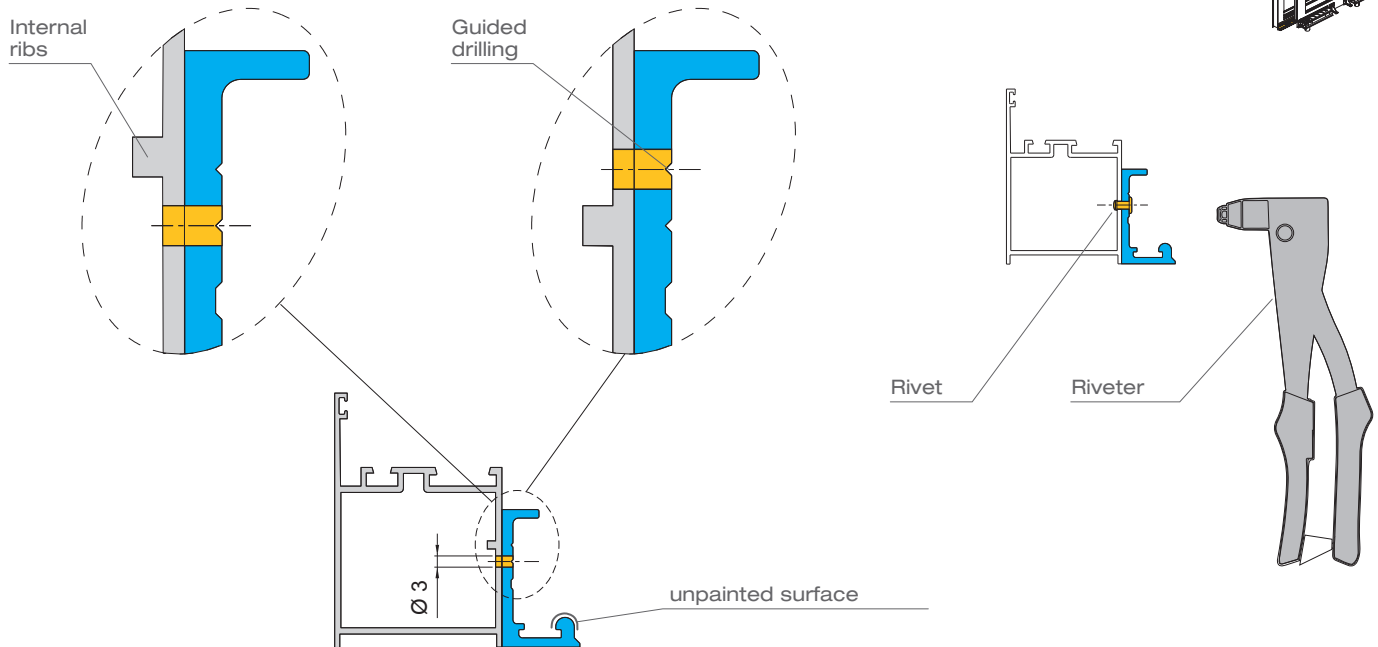
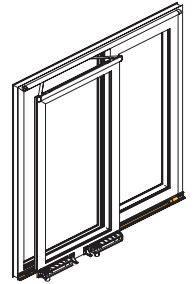

SLIDEART TS

New Tilt and Slide closing mechanism

2401.1
2401.2

2406/1100
2406/1400
2406/1700

TOP LEAF GUIDE

The top guide of the leaf is obtained from extruded aluminium. It is also free of machining for more freedom in terms of the finish. The guide is secured to the leaf profile tab inside a groove, so that the holes can be drilled anywhere.

The spacer arms are then fitted at the two ends and then connected to the sliding blocks. These arms feature significant **technical innovations**:

- since they are independent and opposite each other, they are always positioned at the end of the leaf, thus making it more stable while it is being opened;
- a dual-action spring that facilitates leaf opening during the thrust phase, during the sliding and during the Tilt opening phase.

During the closing phase, the leaf is pushed in order to line up the closing points and facilitate their engagement. The final look is very attractive as all fixing accessories and screws are hidden from view.

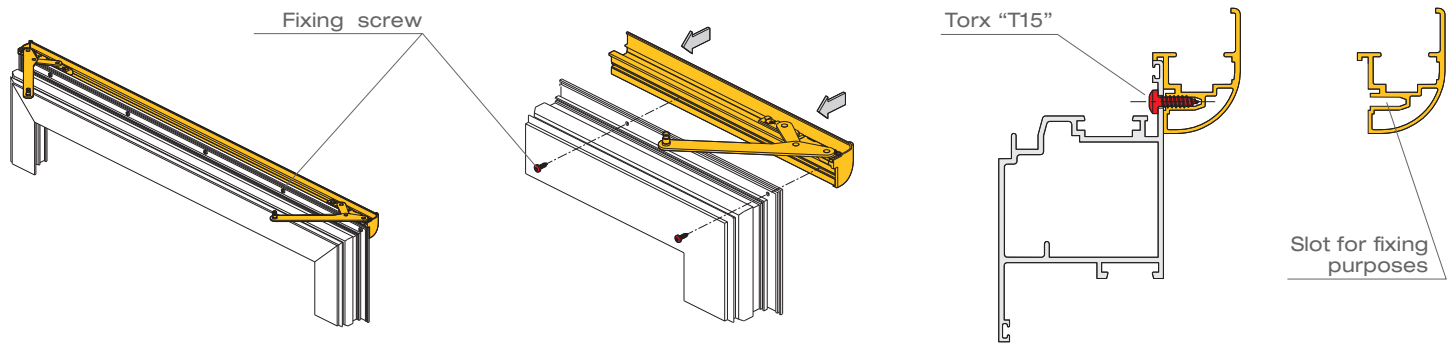
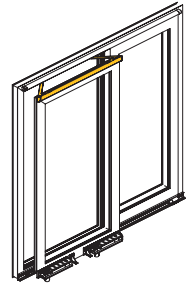

To complete the assembly of the top guides, painted zamak plugs are applied to laterally hide the top mechanism and to stop the arms thanks to an interlock. Plugs are powder-painted, and all fixing accessories and screws are hidden.

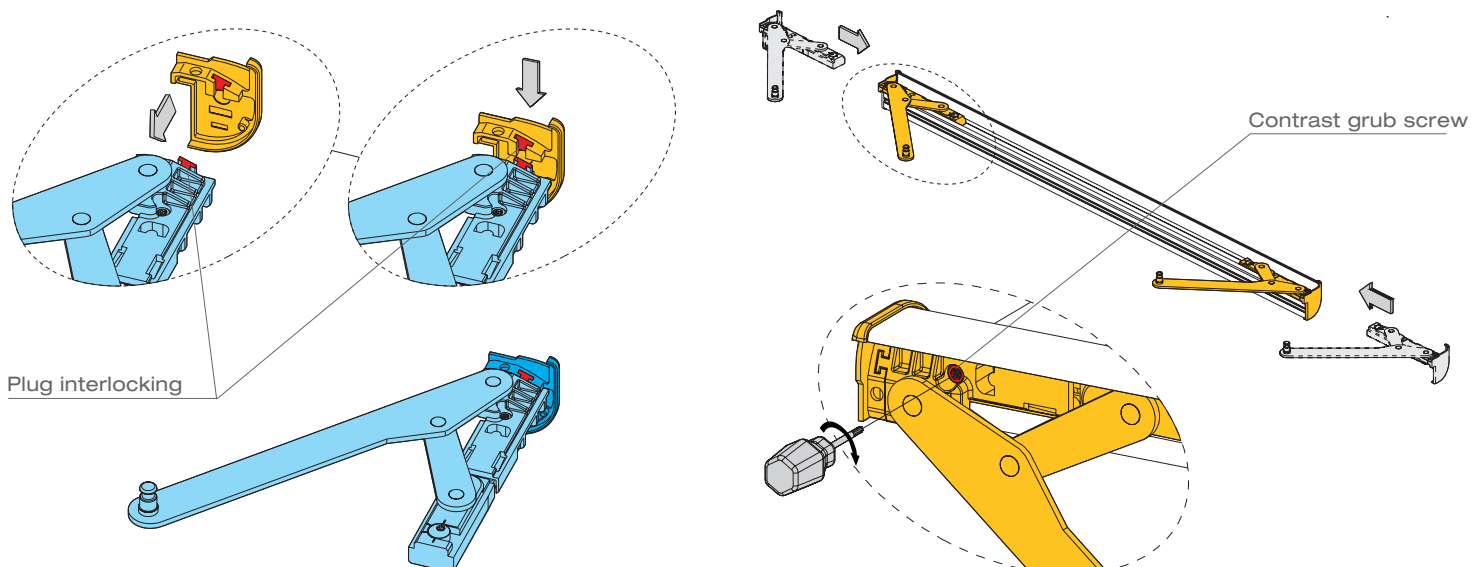

SLIDEART TS

New Tilt and Slide closing mechanism

2401.1
2401.2

2406/1100
2406/1400
2406/1700

BOTTOM ROLLERS

The bottom rollers are assembled on two levers made of extruded aluminium. Each roller fits 2 wheels shaped so as to minimize the sliding friction even in the case of very heavy leaves. The materials used to make the wheels have been designed to last a long time and to keep their shape even after long periods of inactivity. The axes and the wheels are assembled on ball bearings. The standard version (100 kg) includes 2 reinforcements in nylon with 2 screws assembled on the jamb, while there are as many as 8 fixing screws for the aluminium reinforcement (150 kg).

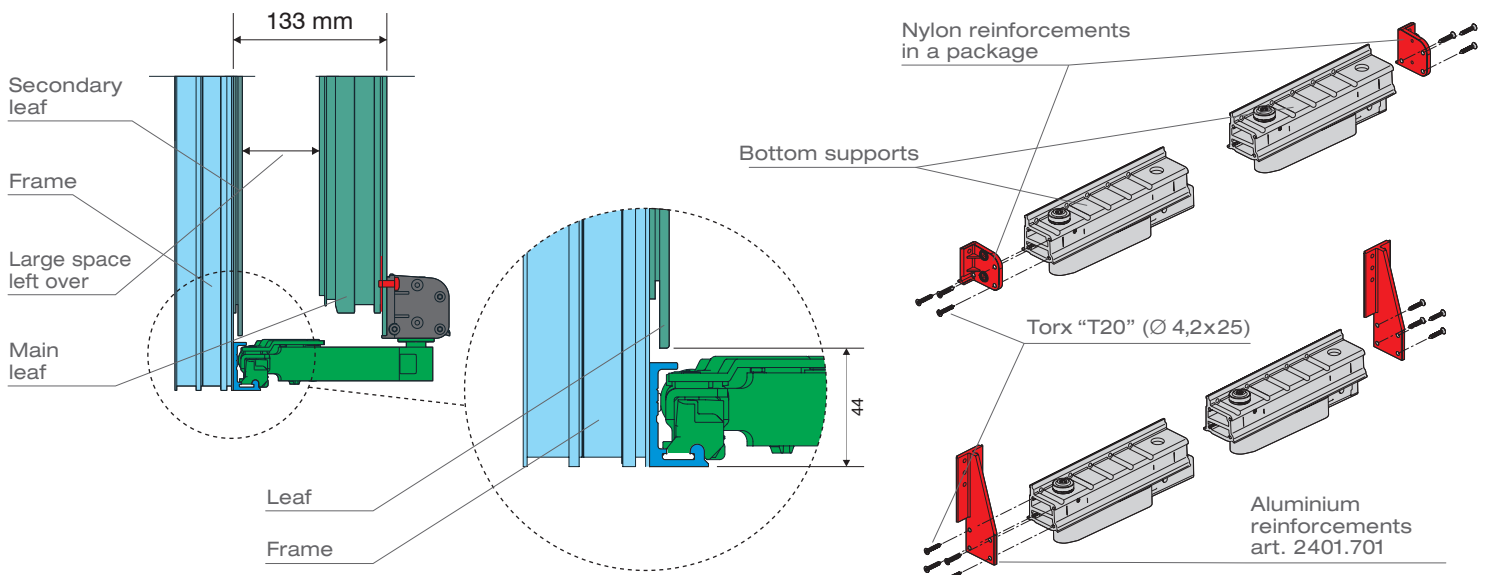
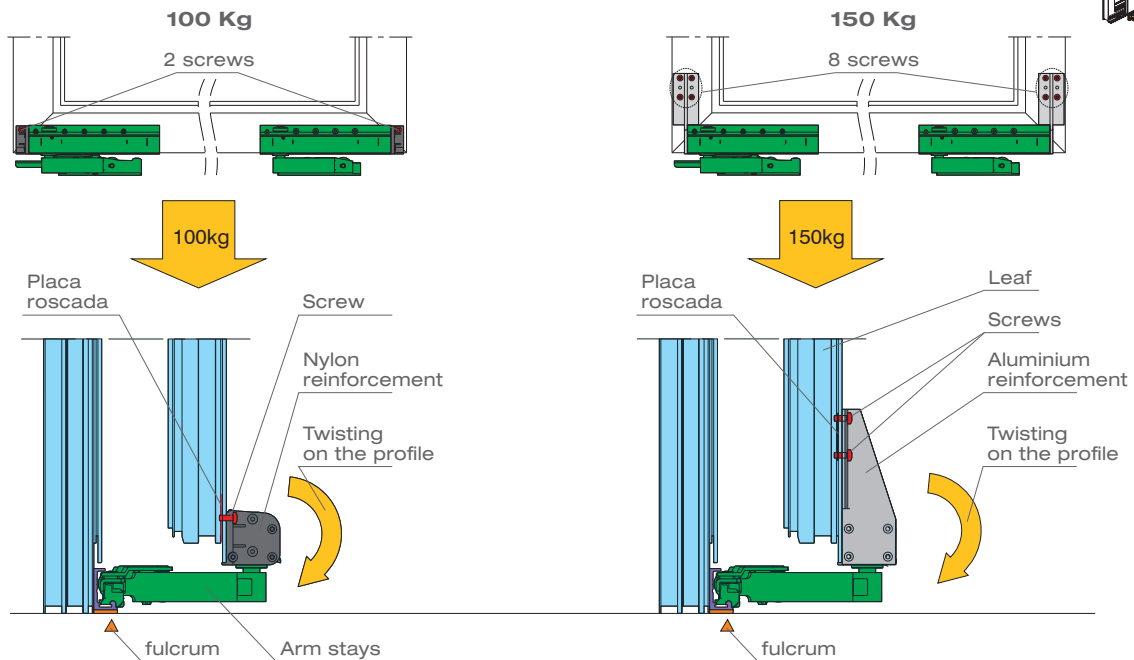
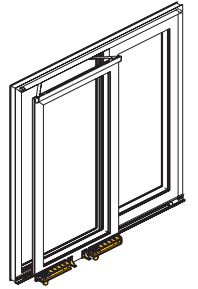

SLIDEART TS

New Tilt and Slide closing mechanism

2401.1
2401.2

2406/1100
2406/1400
2406/1700

BOTTOM ROLLERS

To secure them, it is recommended to use screws with **insulated profiles**.
In case of profiles with no insulation, it is recommended to use threaded inserts.

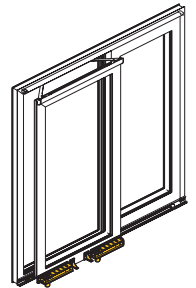

ASSEMBLY USING SELF-THREADING SCREWS

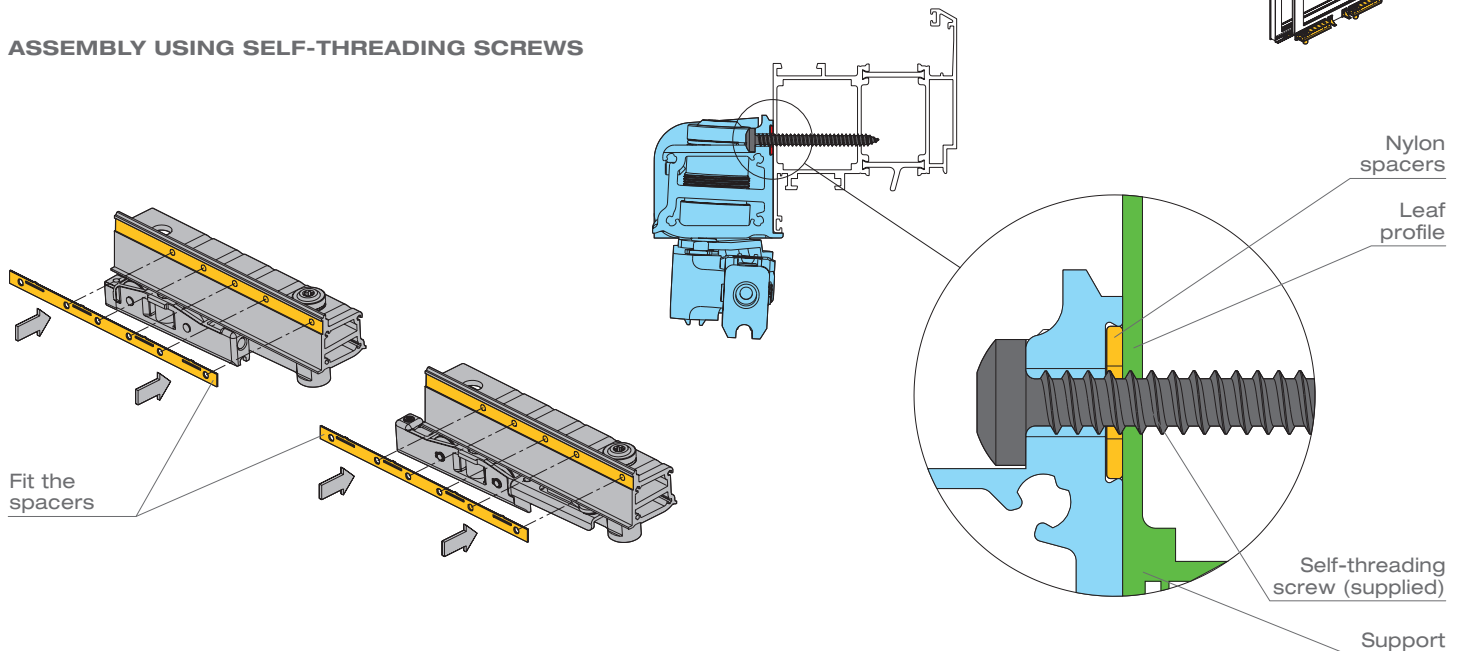

ASSEMBLY USING SELF-THREADING INSERTS

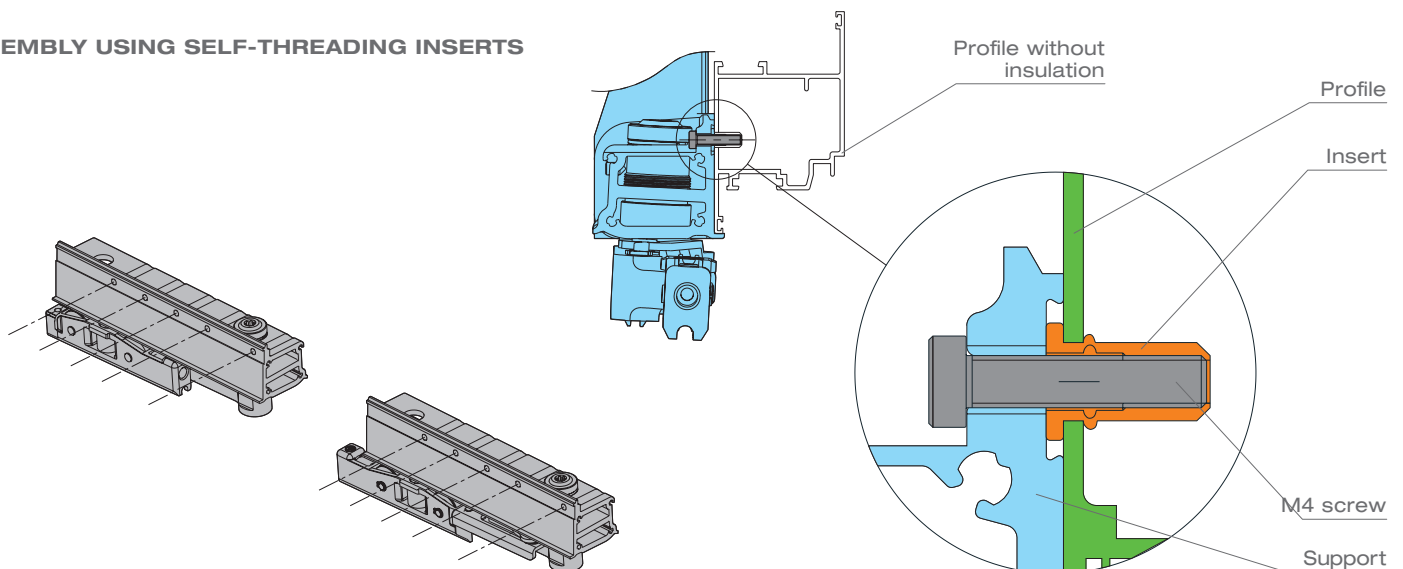

SLIDEART TS

New Tilt and Slide closing mechanism

2401.1
2401.2

2406/1100
2406/1400
2406/1700

LEAF/FRAME ASSEMBLY

Connect the arms

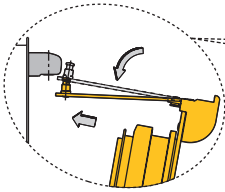

Tilt the leaf

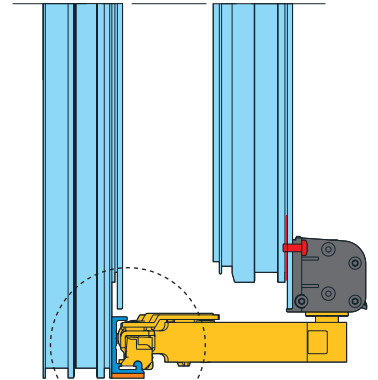
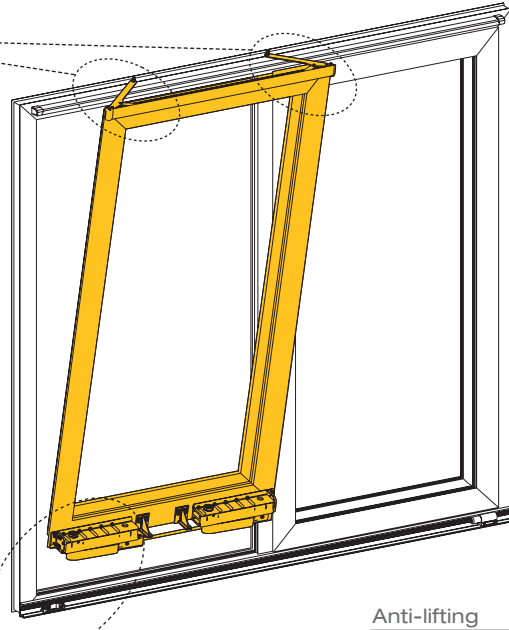
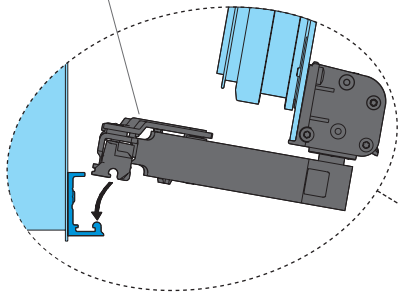

Anti-lifting

Track

Roller

COUPLING TO THE TOP GUIDE

The upper arms are fitted into the sliding blocks of the guide. These sliding blocks are made of white galvanized zamak and nylon, and their special shape contributes to better sliding and added safety.

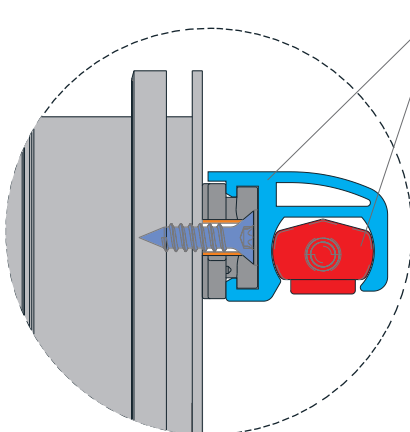
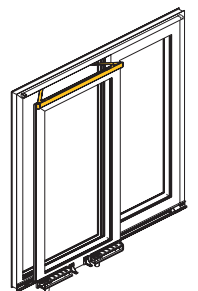

Guide

Sliding block

3 Push the arm

2 Push the spring coupling

1 Move the arm closer

4 Release the spring

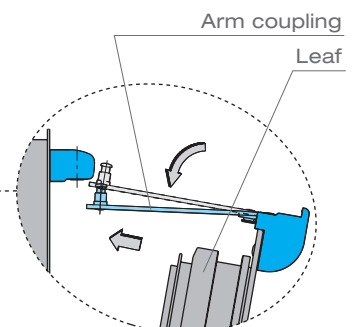
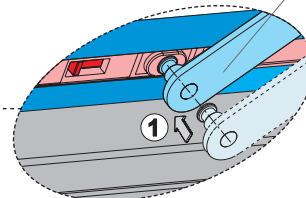
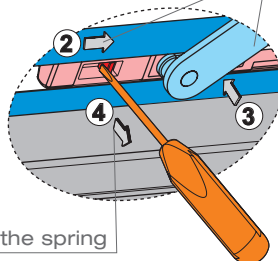

Arm coupling

Leaf

SLIDEART TS

New Tilt and Slide closing mechanism

2401.1
2401.2

2406/1100
2406/1400
2406/1700

PLUGS AND COVERS

The side plugs and the covers are made entirely of metal. They can be powder-painted, thus providing the product with a uniform and very attractive appearance.

UP TO 100 KG

Automatic cover assembly

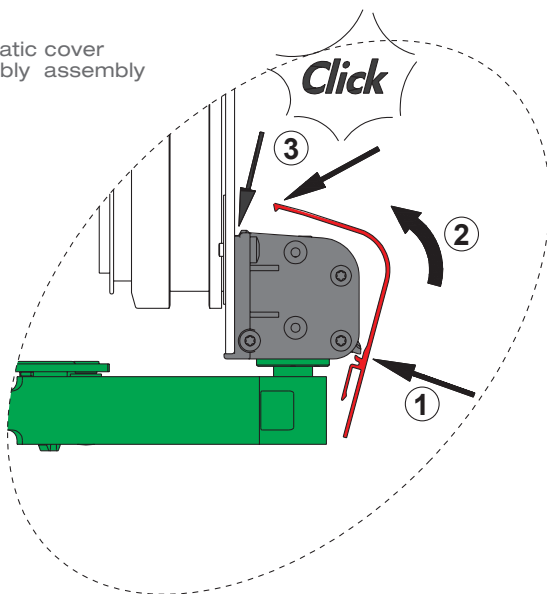

Zamak plug for bottom cover

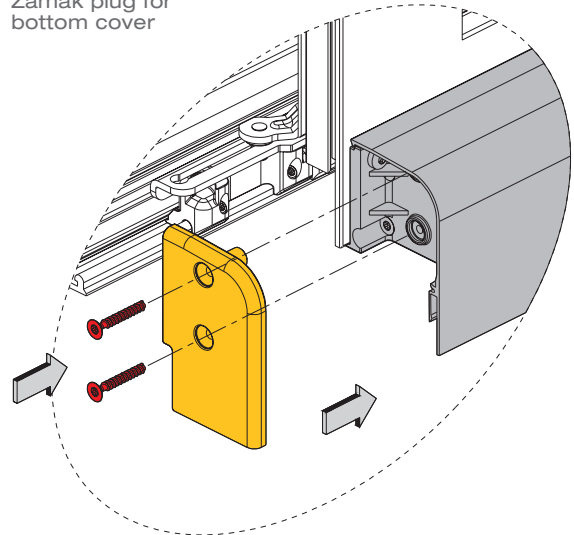

UP TO 150 KG

Automatic cover assembly

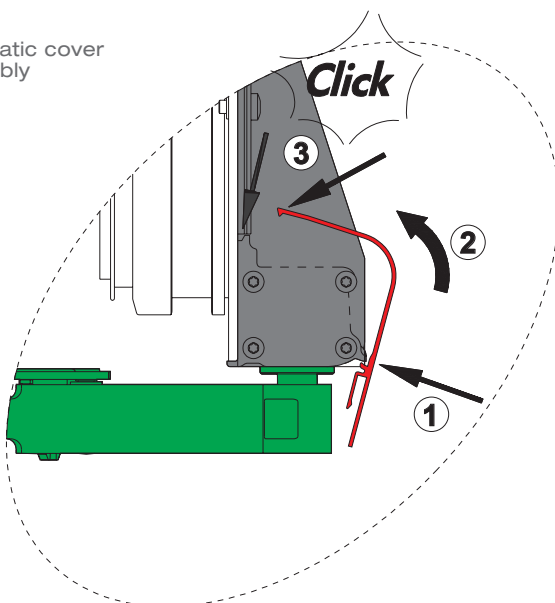

Zamak plug for bottom cover

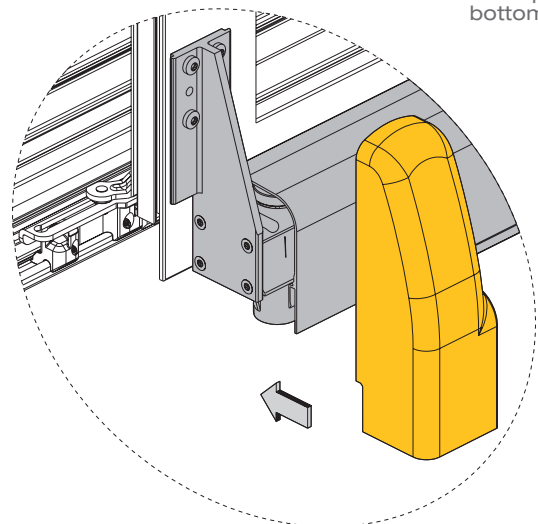

SLIDEART TS

New Tilt and Slide closing mechanism

2401.1
2401.2

2406/1100
2406/1400
2406/1700

ADJUSTMENTS

To ensure continuous contact between the seals and the profile, the leaf and the frame must be perfectly aligned; this means that it is often necessary to make some adjustments after the installation. The vertical adjustment range is -2 mm/+6 mm.

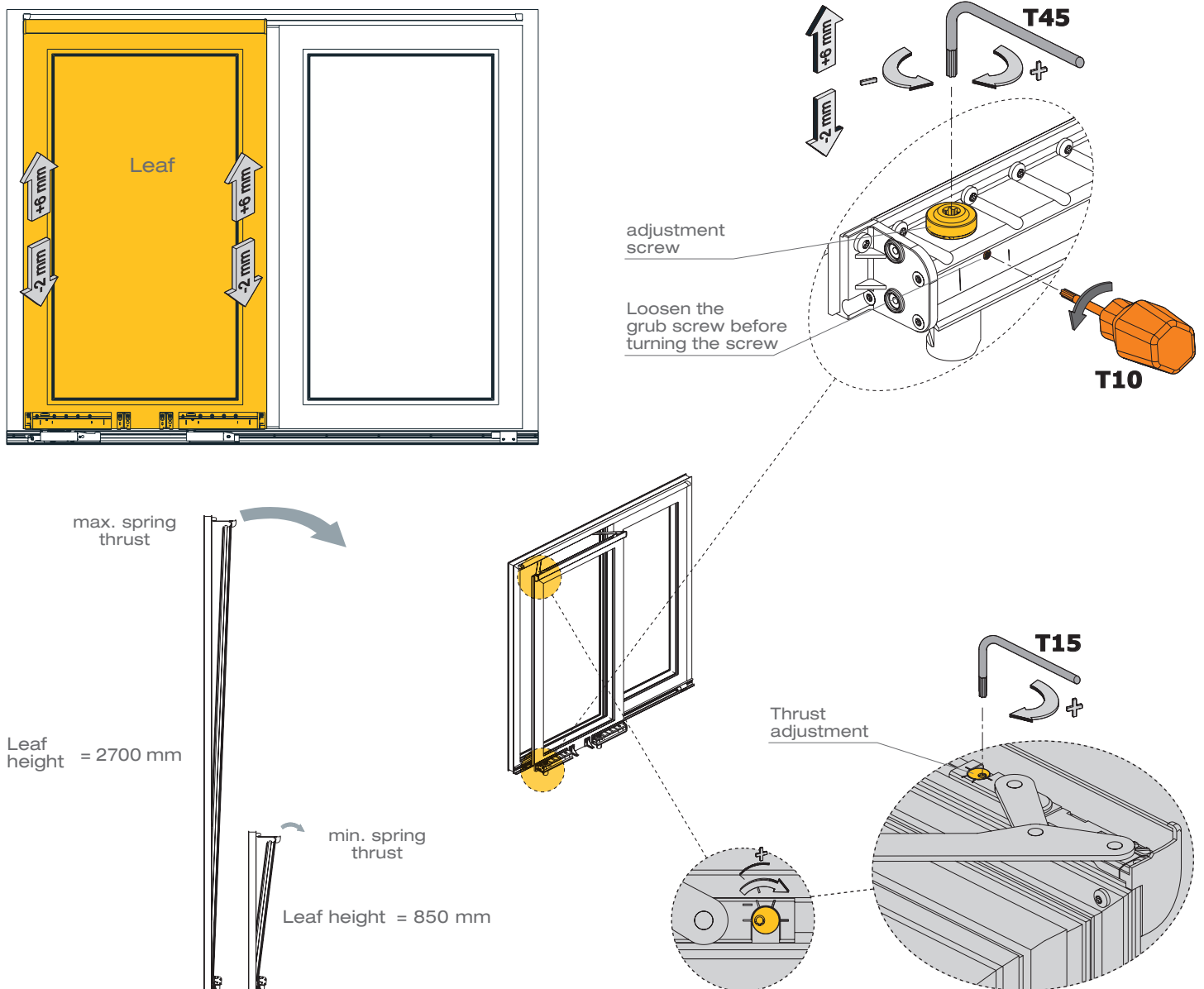

The **SLIDEART TS** kit can be applied to leaves with height ranging from 850 to 2700 mm and with very low weights as well as weights of up to 150 kg. In case of very high and very heavy leaves, the opening angle will be smaller and the leaves will tend to close by themselves, while rather low leaves have a larger opening angle and greater holding strength. So, it is important to adjust the force of the spring (the force must be set at 4 different levels).

SLIDEART TS

New Tilt and Slide closing mechanism

2401.1
2401.2

2406/1100
2406/1400
2406/1700

ADDITIONAL COVER

When installing windows on window sills, part of the rollers will be visible. This is why an additional cover was developed to hide the rollers; this cover must be applied to the lower part of the standard cover.

