

OPEN-OUT

Top-hung

Wsmin. 506.68 - Hsmin. 450

Wsmin. 19.95 - Hsmin. 17.72

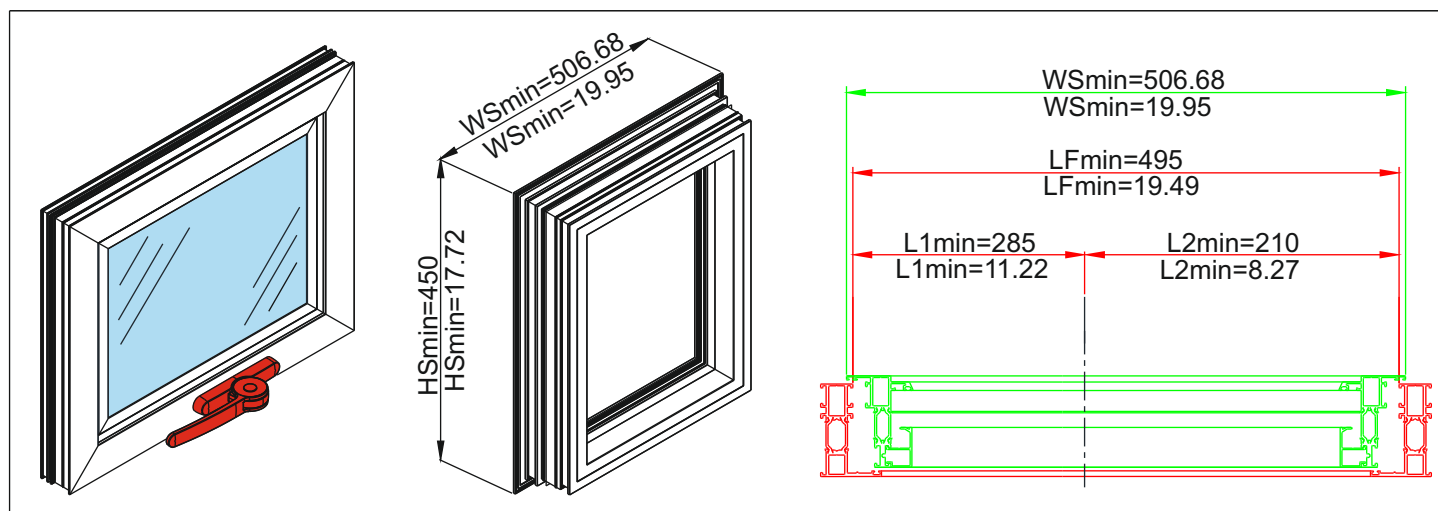
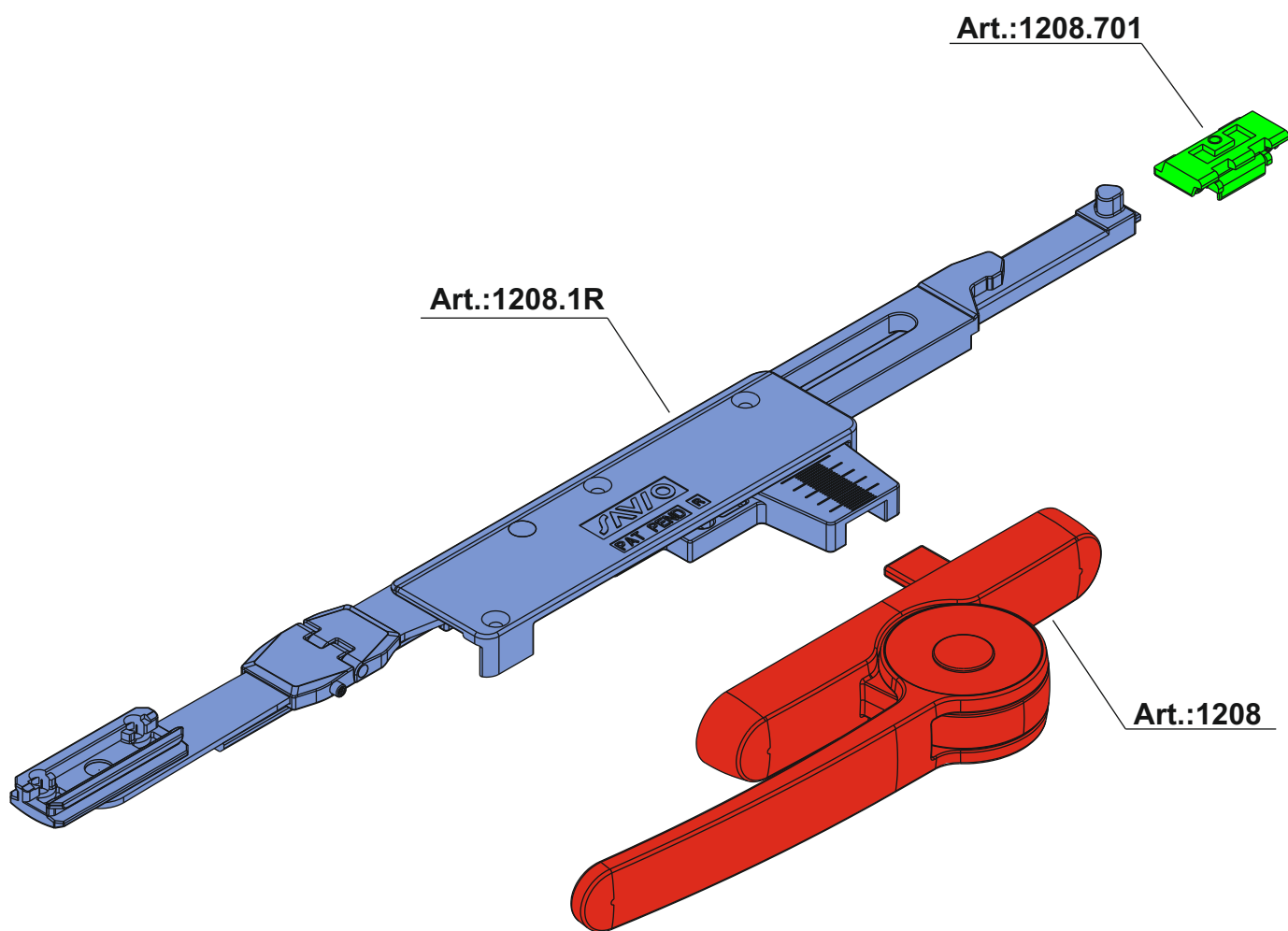

LAVORAZIONE TELAIO - FRAME MACHINING

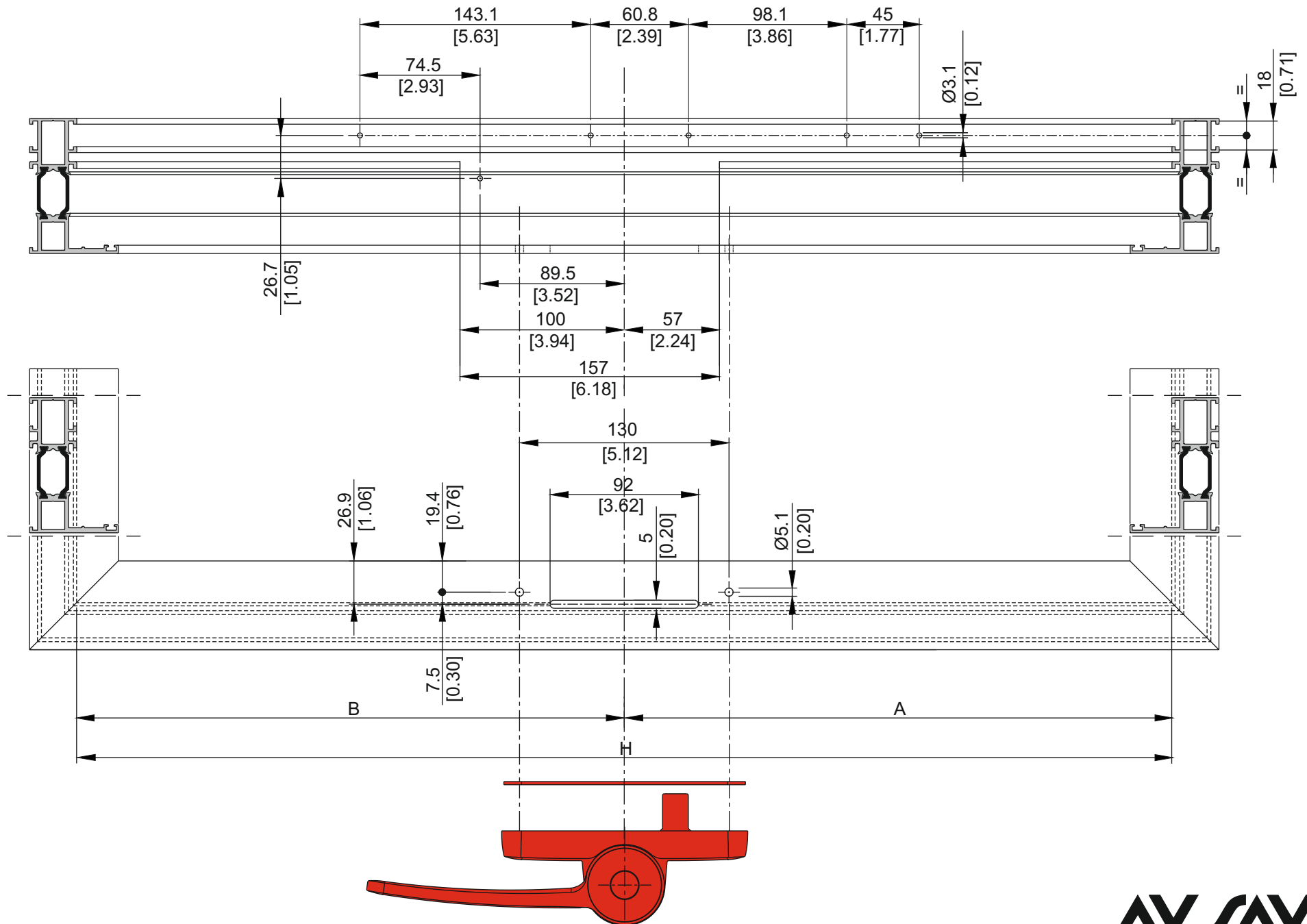

LAVORAZIONE ANTA MOBILE MOVING LEAF MACHINING

- scantonare negli spigoli
- cut the aluminum in the corner

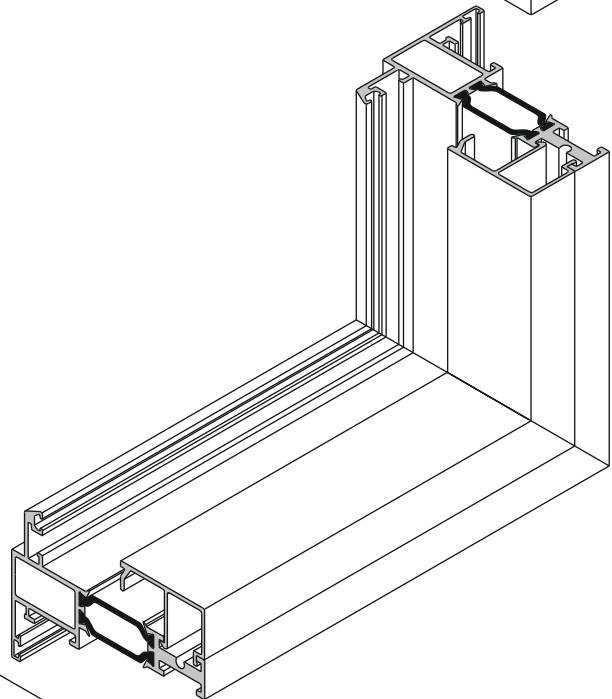
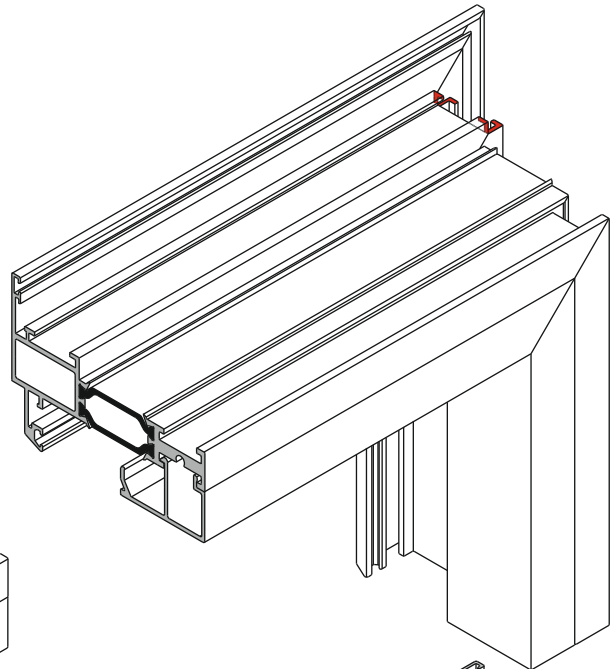
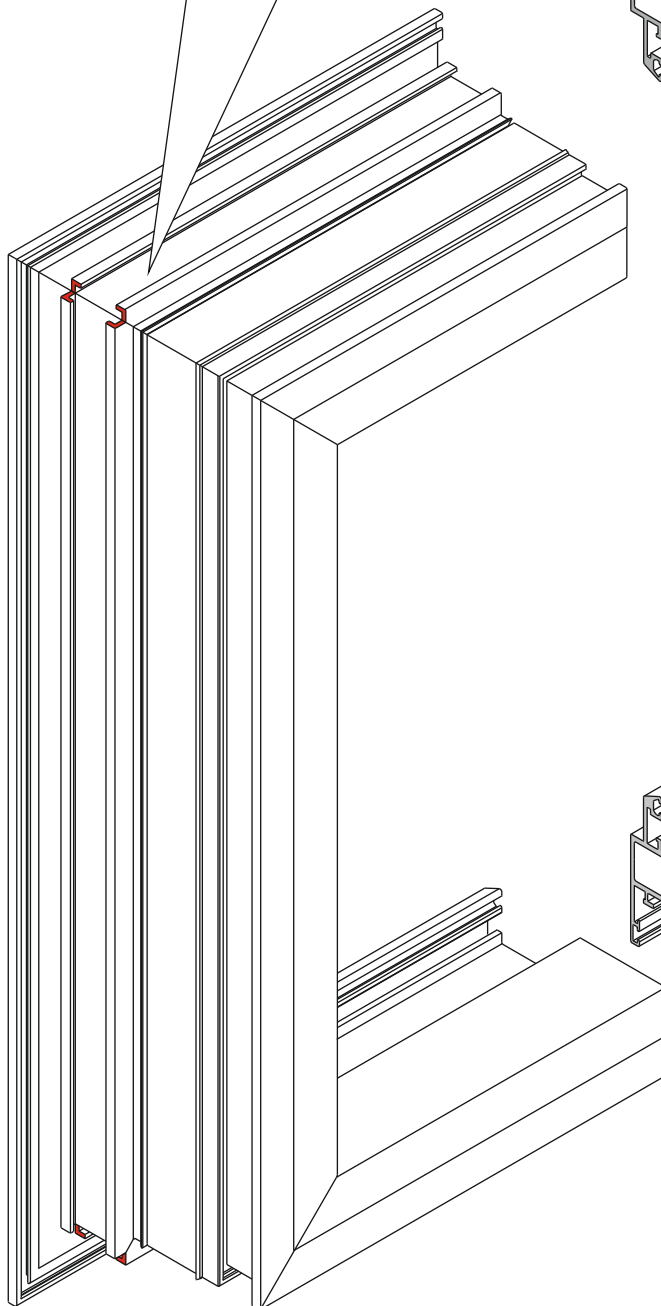
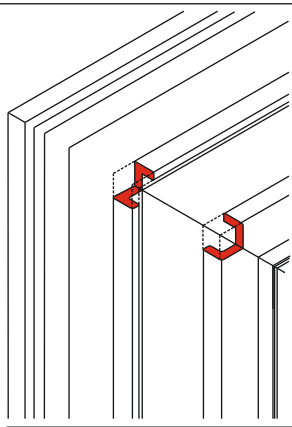

DIMA DI FORATURA PER TELAIO DRILLING JIG FOR FIXED FRAME

I

Art.:1208.950R

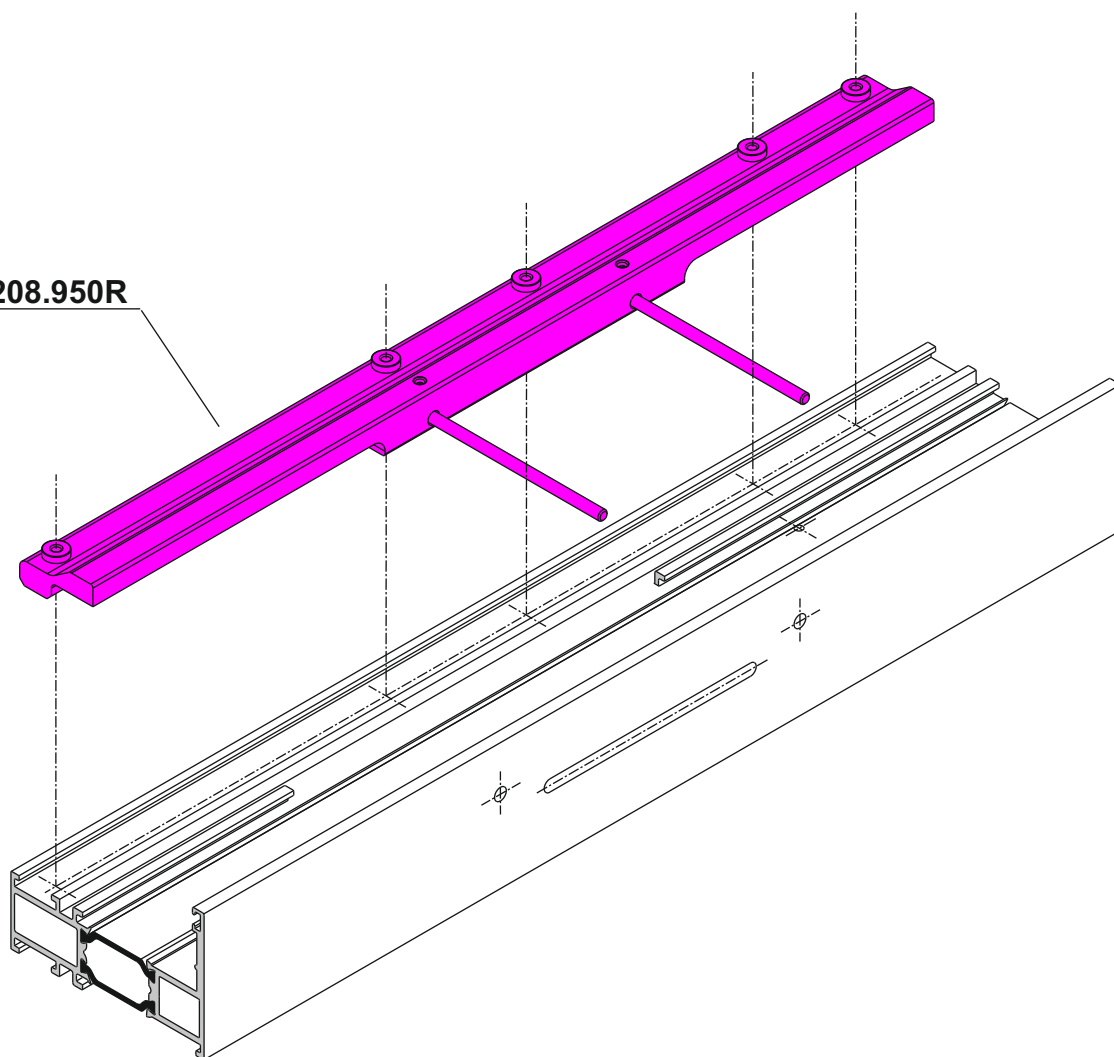

II

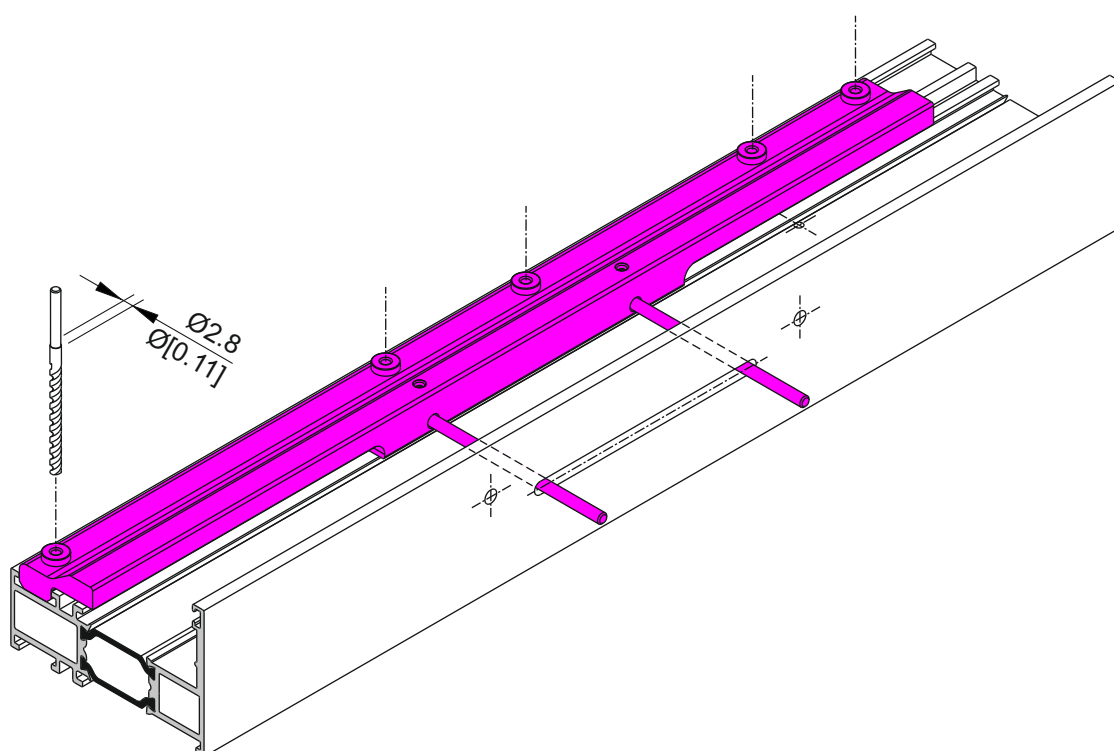

MONTAGGIO CARIGLIONE HANDLE FITTING

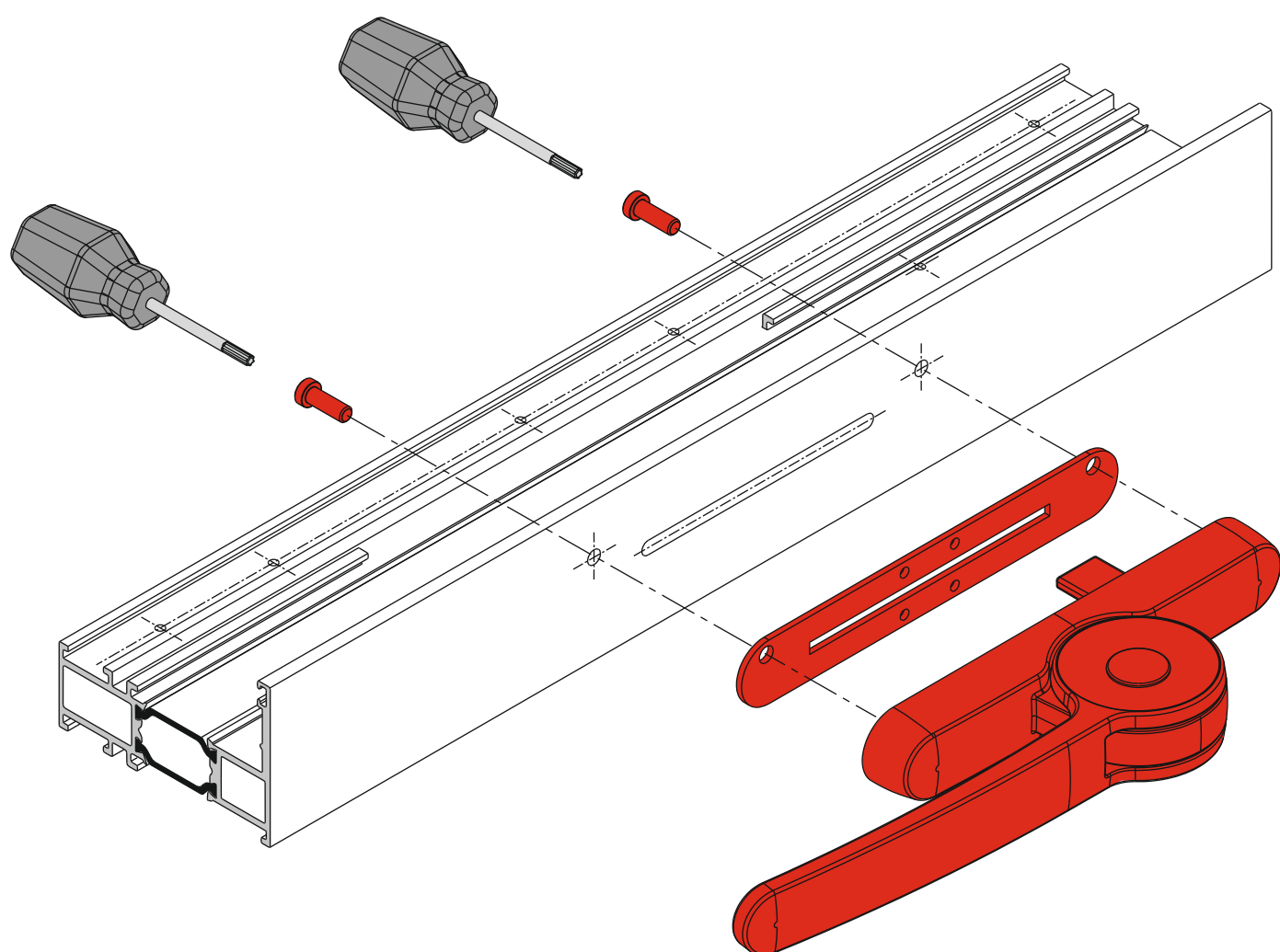

MONTAGGIO MECCANISMO DI MOVIMENTAZIONE FITTING MOVEMENT MECHANISM

I

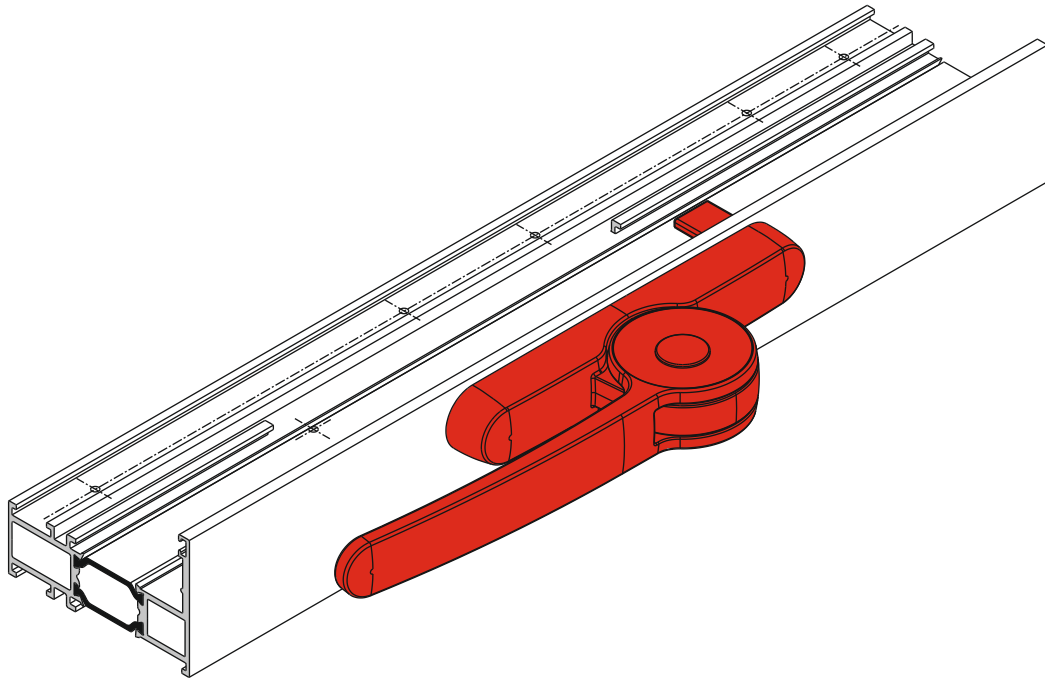

II

Estendere manualmente il braccio del «meccanismo di movimentazione» fino alla sua massima estensione, quindi agganciare il meccanismo «a scatto» sul telaio e fissare il tutto con le 5 viti TORX 3.9x22 in dotazione

Manually extend the arm of the "movement mechanism" up to its maximum extension, and then hook it "click" on the frame and fix it with the 5 Torx screws 3.9x22 supplied

lubrificare
lubricate

lubrificare
lubricate

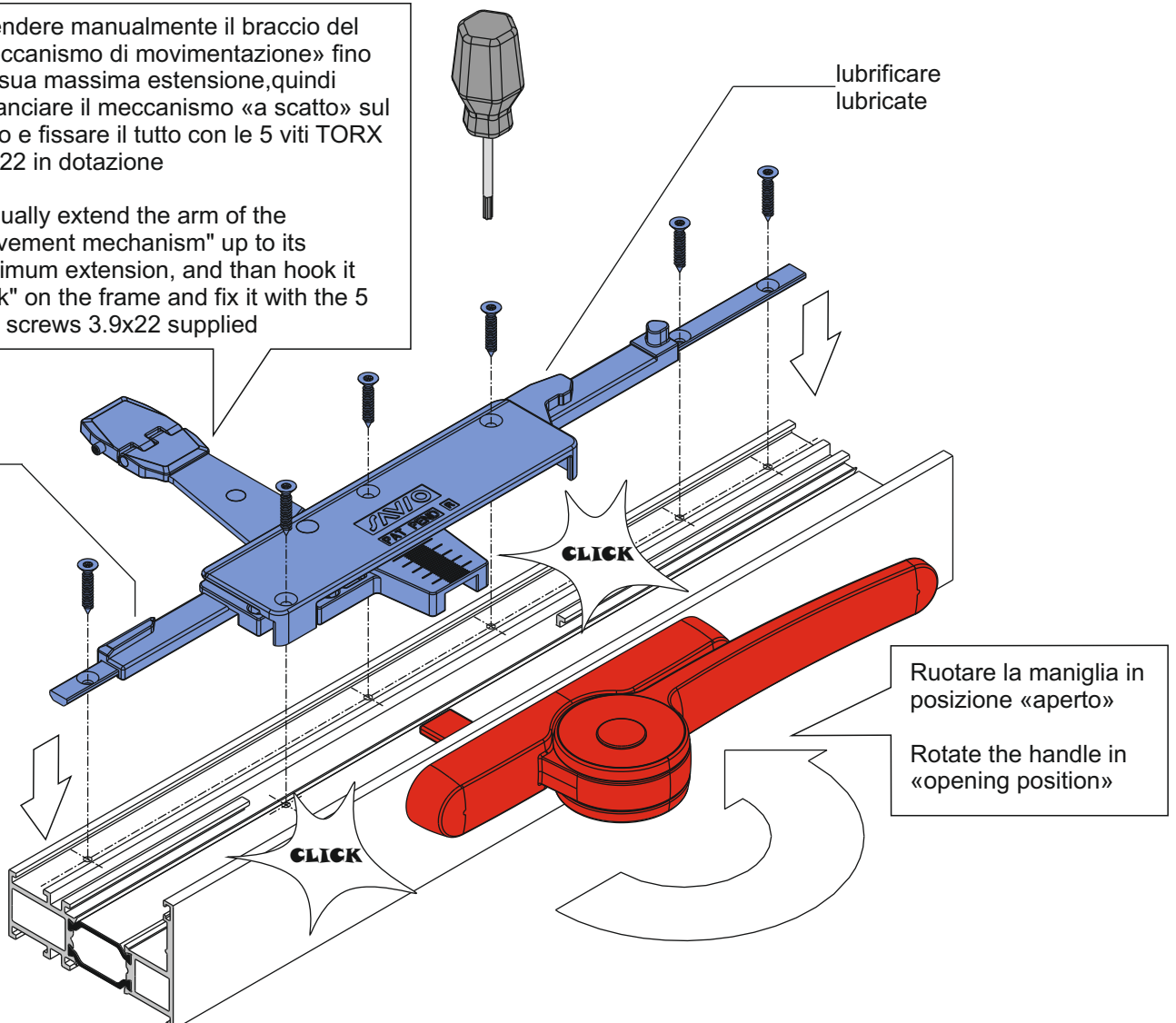

Ruotare la maniglia in
posizione «aperto»

Rotate the handle in
«opening position»

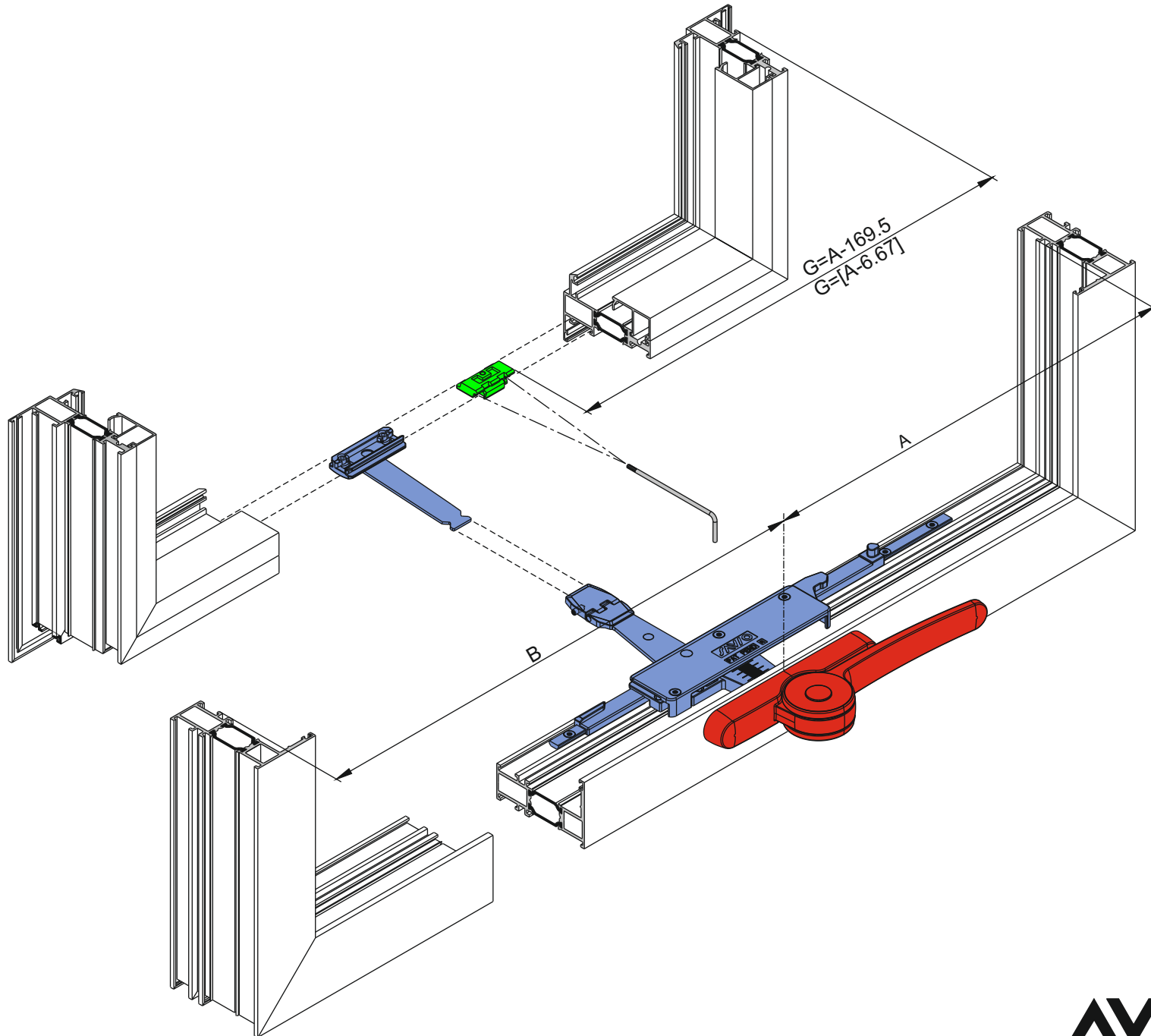

COLLEGAMENTO ANTA-TELAIO FRAME-SASH CONNECTION

I

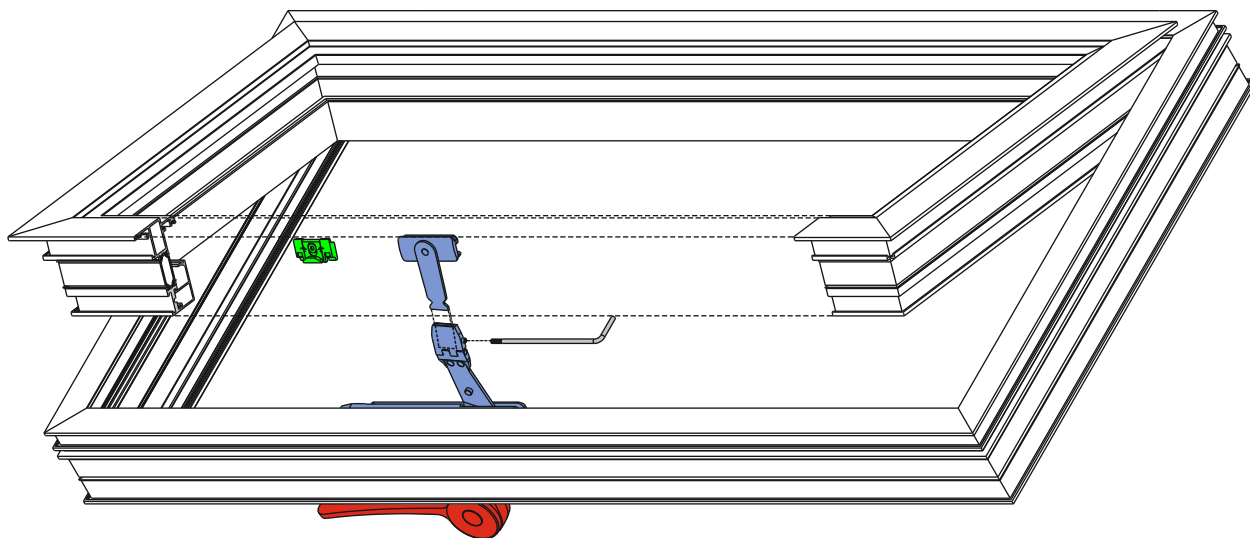

II

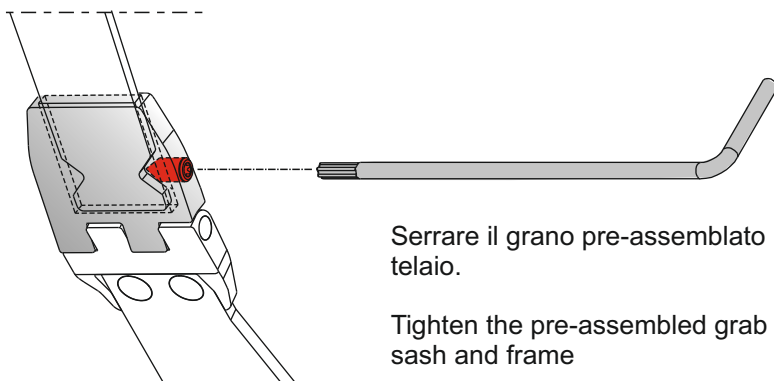
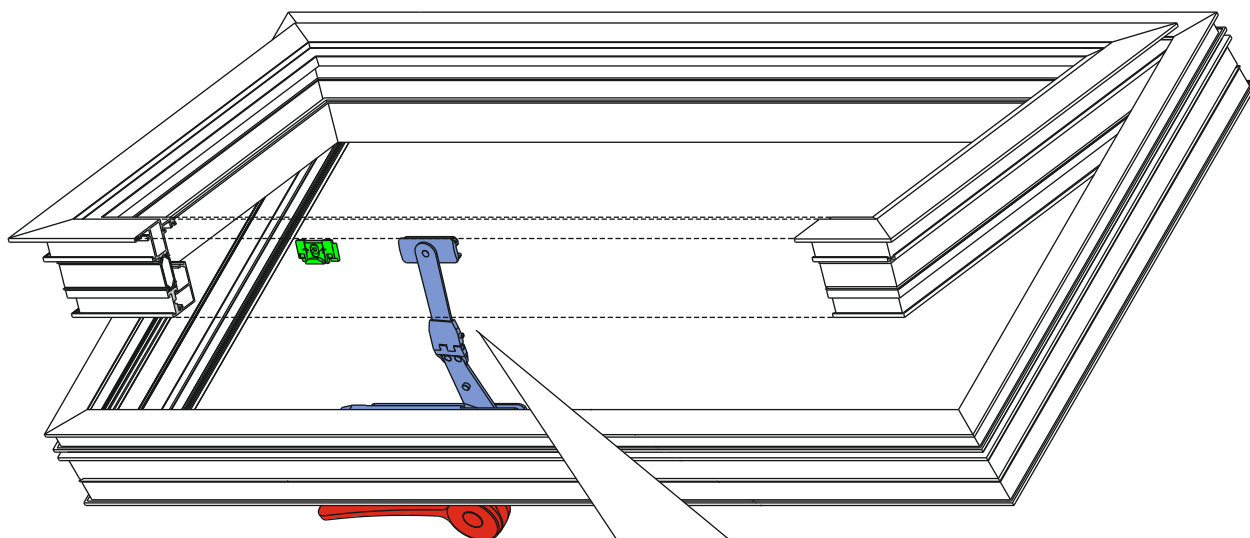

Serrare il grano pre-assemblato per completare il collegamento tra anta e telaio.

Tighten the pre-assembled grab screw to complete the connection between sash and frame